



December 6, 2016

Mr. John Kieling
Hazardous Waste Acting Bureau Chief
New Mexico Environment Department (NMED)
2905 Rodeo Park Drive East, Building 1
Santa Fe, NM 87505-6303

RE: Class 1 Renewal Permit Modification for Part B Permit – NMD002208627:

Dear Mr. Kieling:

Advanced Chemical Treatment, Inc (ACT Treatment) would like to request a Class 1 Permit Modification to the Part B TSDF renewal application located at 6133 Edith Blvd. NE – EPA ID #NMD002208627 to address the following items:

1. Removal of adjacent yard located at 6141 Edith Blvd. to Part B Permit

ACT Transport has moved to their own facility and therefore we are not leasing the yard from Riccobene located at 6141 Edith Blvd. NE, Albuquerque, NM 87107. This property was adjacent to the PART B TSDF and was used for storage of equipment such as trucks, trailers, and roll-off bins. It was at no point used for permanent storage of waste, nor was it ever used for any type of Part B Operations. The permit is now fully fenced and appropriate signage is in place. Please refer to the revised Figure 6 (Facility Layout) of the Permit Renewal Application included with this letter.

2. Update Emergency Coordinator and Alternate List for Contingency Plan in Part B Permit

ACTreatment Emergency Coordinators

Emergency Coordinator	Home Address	Cell #	Work #
James O'Hara	3905 Rancho Vistoso Albuquerque NM 87120	505-350-8760	505-349-5220 x455
Shawn Moudy – 1 st Alternate	4504 Beresford Ln NW Albuquerque, NM 87120	408-470-0195	505-349-5221 x 450
Kris Gwash – 2 nd Alternate	3708 Trinidad St Ne Albuquerque NM 87111	505-379-9582	505-349-5224 x 465

If NMED requires further information or documents to process this request as part of our permit renewal, please contact myself or Krista Harsono at 619-571-5737 or KHarsono@ACTenviro.com and we will respond in a timely manner.

Regards,

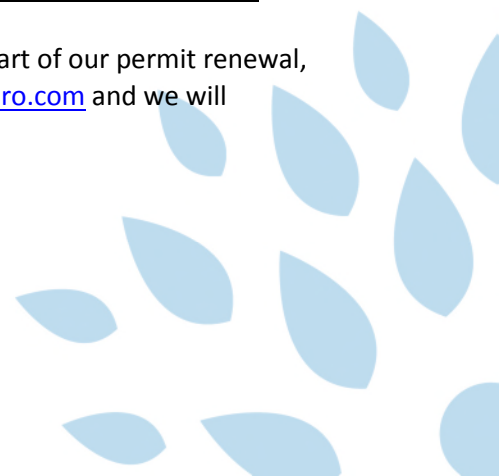



Shawn Moudy
General Manager
Advanced Chemical Treatment

Enclosures

cc: P. Paduano, ACTenviro
K. Harsono, ACTenviro





Revised Figure 1 - ACTreatment Site Layout and Storage Areas



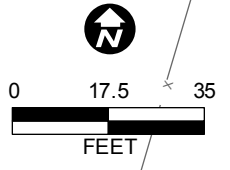

LEGEND	
	PRIMARY EVACUATION ROUTE
	SECONDARY EVACUATION ROUTE
	PROPERTY LINE
ES	EMERGENCY SHOWER
F	FIRE EXTINGUISHER
SP	SPILL KIT
PS	PULL STATION
FA	FIRST AID KIT

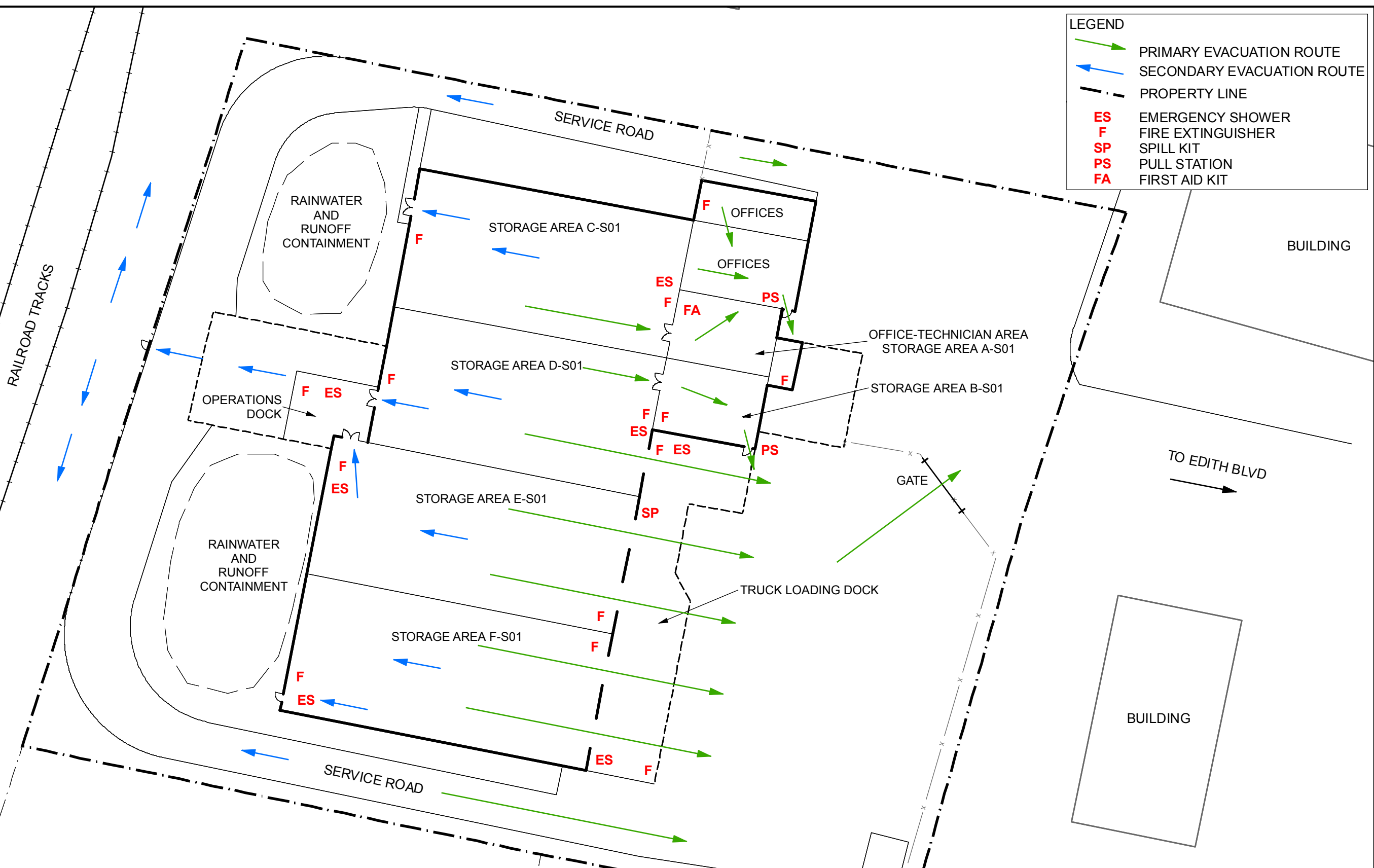

File: SitePlan_V9.mxd JP 10/26/2016

LAST UPDATE: Oct 26, 2016

FACILITY EVACUATION ROUTES		
	ADVANCED CHEMICAL TRANSPORT	FIGURE: 1
	6137 EDITH BLVD. NE ALBUQUERQUE, NM 87107	