

Sandia National Laboratories

Albuquerque, New Mexico 87185

date: December 20, 1991

to: John Andrews, DOE-AL

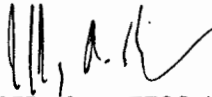

from: Jeff Havlena 7723 (GRAM), Assistant Technical Leader for the Mixed Waste Landfill
ADS 1289

subject: Response to NMED Request for Information on the Mixed Waste Landfill

Per your request of December 18, I have prepared the following responses to the information request by Will Moats:

Item 1 - Comment: Provide detailed site maps showing boundaries, survey control points, topography, road Access, and the locations of all monitor wells, test pits, and soil borings.

Response: Please see the attached. Much of the requested information will be included in the final RFI report which will be produced upon completion of the Phase II RFI.

Item 2 - Comment: Clarify the screen slot size for MWL-BW1, MWL-MW2, and MWL-MW3.

Response: The actual screen slot size for these wells is 0.010". The slot size listed in the Monitor Well Installation report was erroneously given as 0.001".

Item 3 - Comment: Provide azimuth and deviation measurements for MWL-BW1, MWL-MW2, MWL-MW3, if they exist.

Response: MWL-BW1: 1.5° deviation at 239 and 465 ft; 1.25° deviation at 500 ft
MWL-MW2: 2.5° deviation at 495 ft
MWL-MW3: 2.0° deviation at 465 ft.

No azimuth measurements available.

received by Mike deMord
date 12-23-91
Per Will Moats request:

Item 4 - Comment: Provide the following information for MW1:

<u>Requested Information</u>	<u>Response</u>
A) Geologic and Geophysical Logs	see attached
B) Well recovery test data	unknown
C) Development Records	see attached
D) Drilling contractor	Water Development Corp.
E) Drilling Equipment	unknown
F) Hydrogeologist/Company	Ed Mignardot, John Montgomery, R.F. Weston, Corp.
G) Ground elevation	5379.54 FMSL(estimated from stickup)
H) TOC elevation	5381.54 FMSL
I) Total depth (well/pilot)	478.0 ft bgl/ >480.5 ft bgl
J) Depth of first water	457 ft bgl
K) Static water level	457.82 ft bgl
L) Estimated yield	0.42 liters/min
M) Pumps	Bennett Stainless Piston Sampling Pump
N) Borehole deviation surveys	unknown
O) Sterilization procedures	unknown
P) Screen slot size	unknown
Type of couplings	unknown
bottom cap	unknown
Q) Depth interval of annular sealant/backfill	unknown
R) Risers	unknown
Type of couplings	unknown
Centralizers	unknown
S) Protective casing	unknown
Materials	Steel
Diameter	14 inch
Length	unknown
Annular seal casing to riser	unknown
Annular seal casing to borehole	unknown
T) Well protection	

Type cover	hinged steel
Well cap	locking
Cement pad	yes
Protective posts	yes
Signs	yes, on casing

Note: This well was installed by Roy F. Weston Corp in 1988 as an additional well during the drilling and well installation program at the Chemical Waste Landfill. The records and information needed to satisfy the above unknown items are presumed to be available in field report that is presently unavailable to the MWL technical lead. The report is rumored to be in the possession of the ER-TSO in Los Alamo, since that office was in charge of the drilling program at the time. We will attempt to obtain a copy of the report from the ER-TSO.

Item 5 - Provide for MWL-MW3: Development records, recovery test data, has the well been properly developed at this time, estimated yield.

Response: For development records and recovery test data, see attached. Every attempt has been made to properly develop the well. The estimated yield is 12 ml/minute.

Item 6 - Provide the following for MWL-BW1, MWL-MW2, MWL-MW3:

<u>Requested information</u>	<u>Response</u>
A) Drilling equipment	Failing CF2500
B) Ground elevation	BW1: 5382.51 (est.) MW2: 5375.26 (est.) MW3: 5379.32 (est.)
Note: All ground elevations estimated from assumed stickup	
C) TOC elevation	BW1: 5384.51 MW2: 5377.26 MW3: 5381.32
D) Depth to first water	BW1: 452 ft bgl (est.) MW2: 452 ft bgl (est.) MW3: 448 (est.)
E) Static water level (November 27, 1989)	BW1: 4923.57 FMSL MW2: 4923.85 FMSL

F) Pumps

MW3: 4920.69 FMSL
Bennett Stainless Piston
Sampling Pumps

G) Sterilization procedures

unknown

H) Wellhead protection

Well cap

hinged steel

Cement pad

yes

Protective posts

yes

Signs

yes, on casing

Item 7 - Comment: Annular seal between casing and borehole for MWL-BW1

Response: Neat cement

Item 8 - Comment: Visual or geotechnical soil classification tests used; was any geotechnical testing done?

Response: visual, no geotechnical testing known to have been done.

Item 9 - Comment: List all soil borings and test pits at the MWL

Response: see attached.

JAH:7723:jah

Copies to:

7723 Day File

7723 R.G. Knowlton

7723 Records Center - MWL Correspondence

DRAWN BY: PMR
 CHECKED BY: JML
 APPROVED BY: MGS
 DATE: 7/20/90
 DRAWING NUMBER: 301181.25.01.B1

LEGEND

- MONITOR WELL LOCATIONS
- ▣ INSTALLED IN 1988
- ▣ INSTALLED IN 1989



0 50 100 FEET

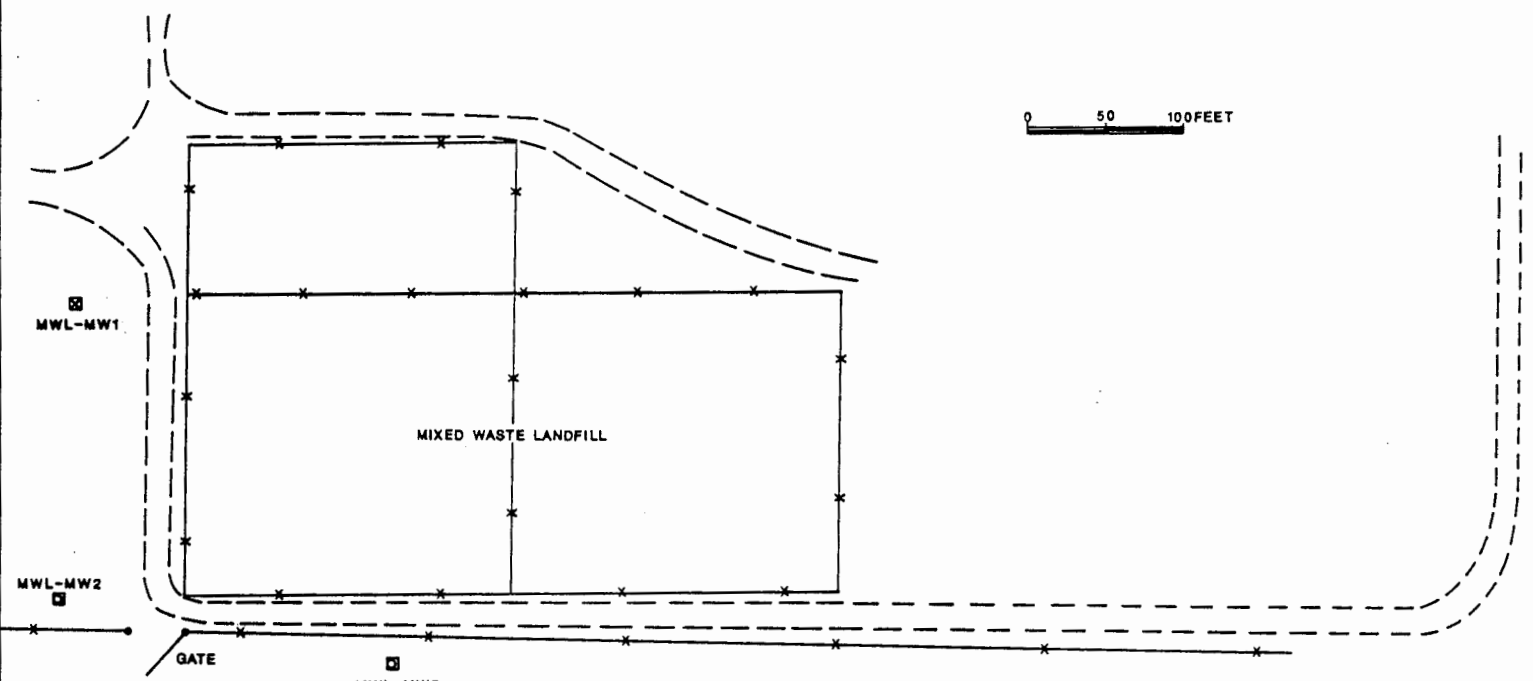

▣ MWL-BW1

FIGURE 1

**MIXED WASTE LANDFILL
MONITOR WELL LOCATIONS**

PREPARED FOR
SANDIA NATIONAL LABORATORIES



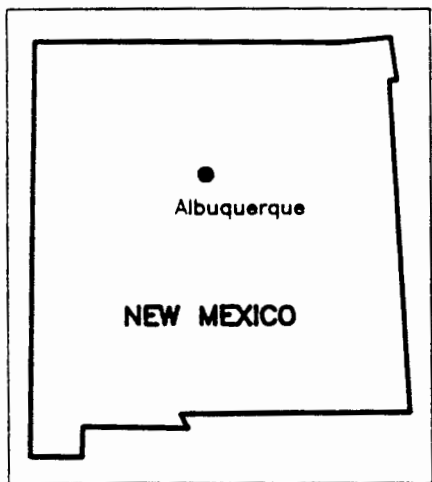
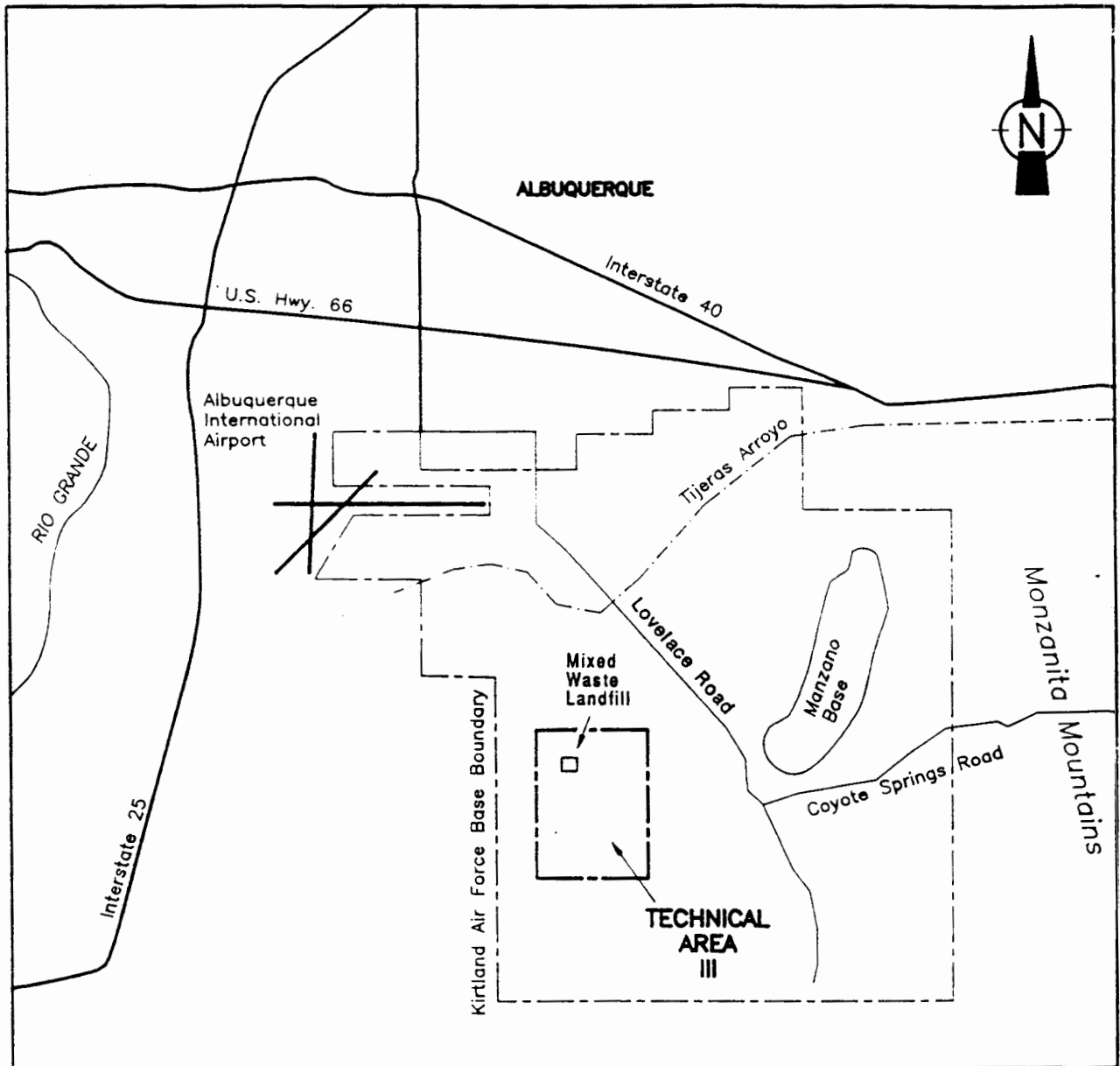

SANDIA NATIONAL LABORATORIES
 ENVIRONMENTAL RESTORATION PROGRAM
 TASK AL-SA-RC-2

Date: 10/89

Drawn by: DAP

1" = 1.9 miles

Figure 1-1
SITE LOCATION MAP

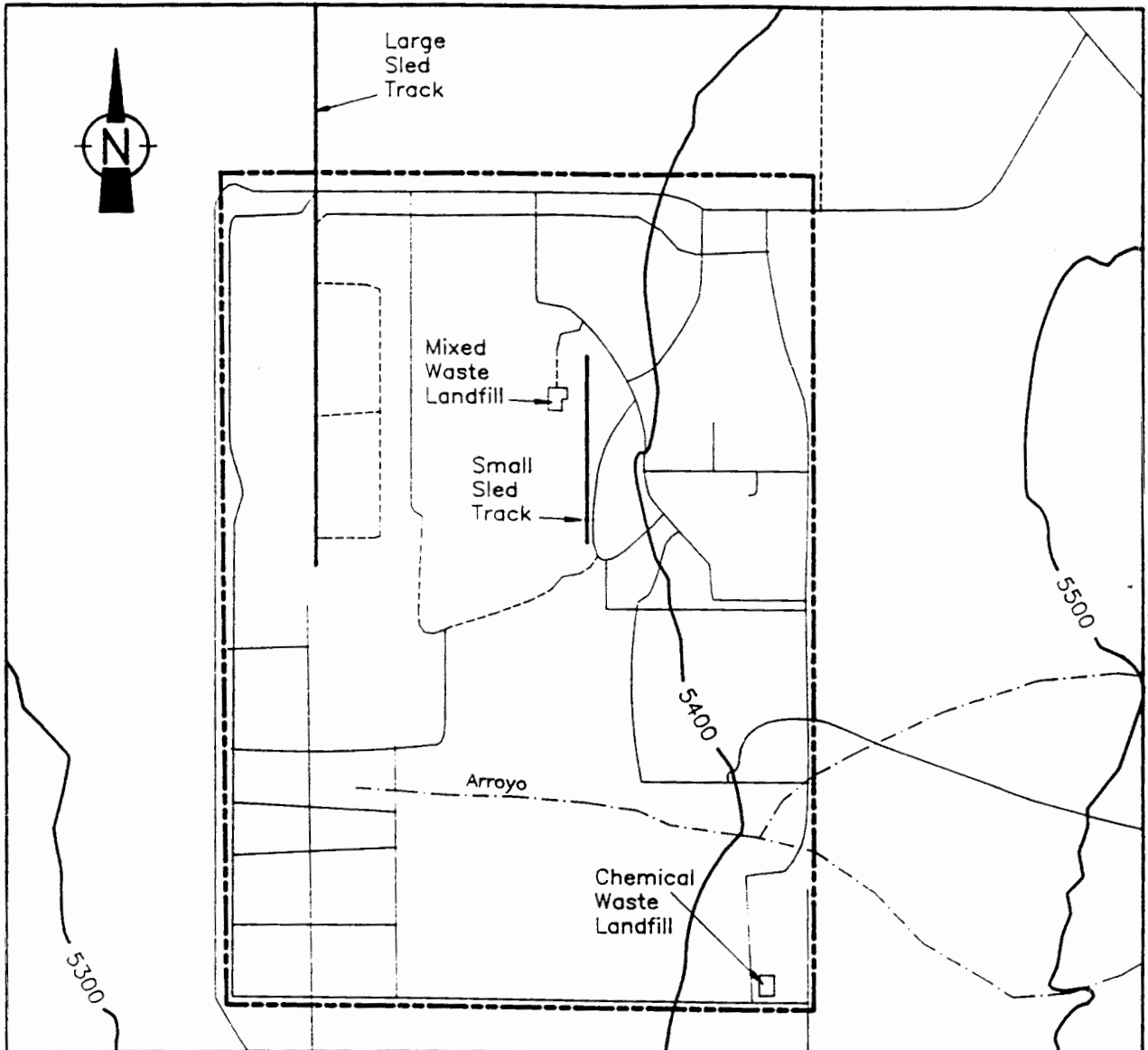

LEGEND

- Improved road
- Unimproved road
- Technical area III
- 5400— Surface contour in feet (MSL)
- ⊕ Monitoring well
- Background soil boring

SANDIA NATIONAL LABORATORIES
 ENVIRONMENTAL RESTORATION PROGRAM
 TASK AL-SA-RC-2

Date: 10/89

Drawn by: DAP

scale: 2" = 1 mile

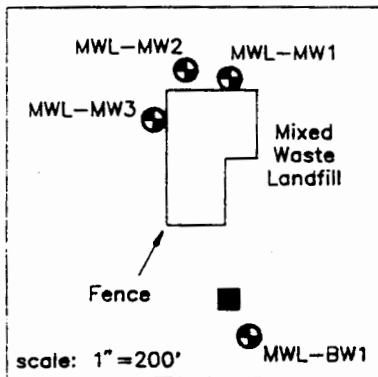

ENLARGED AREA OF MIXED WASTE LANDFILL

**Figure 1-2
 SITE MAP**

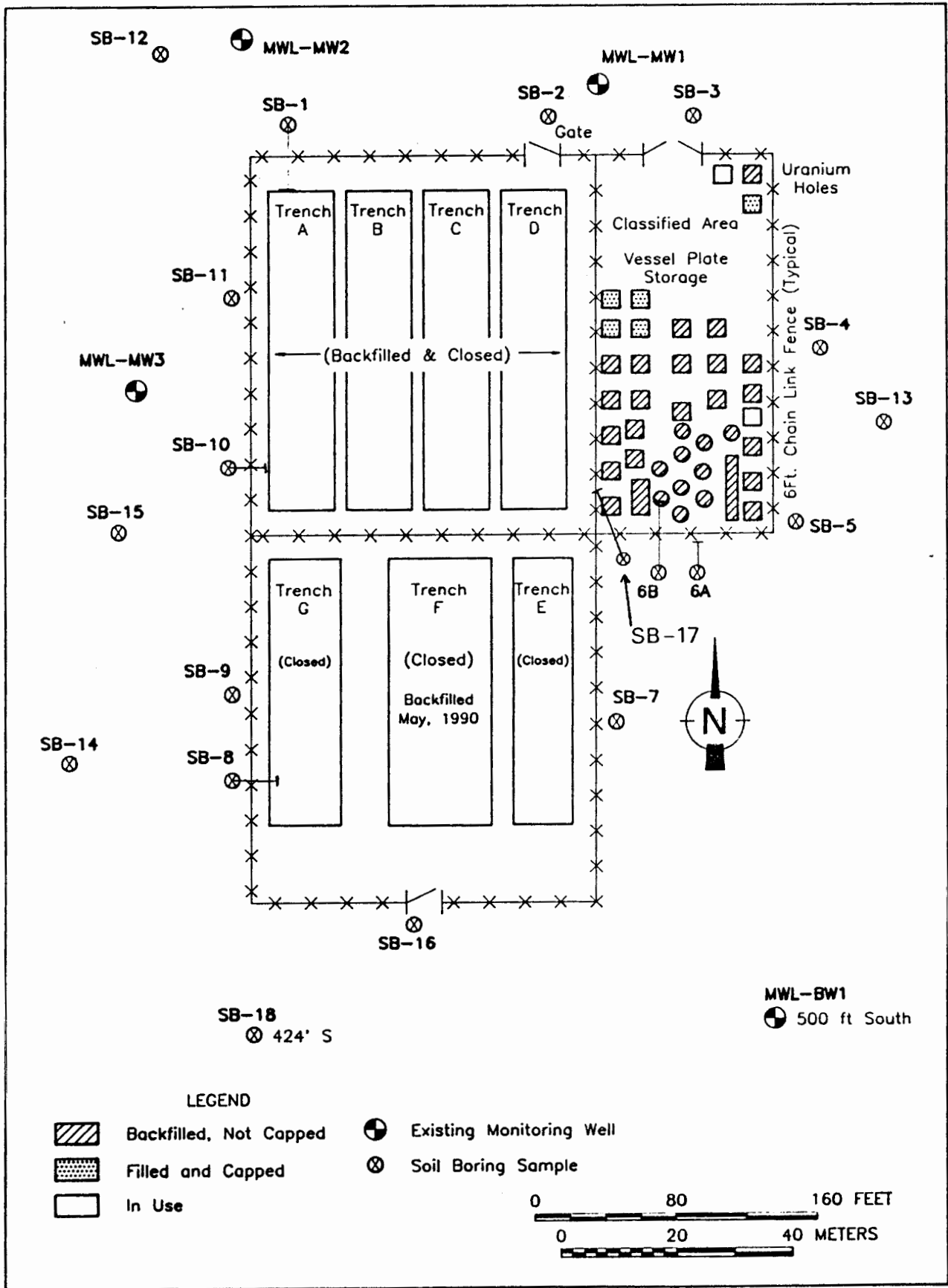

Figure 3-4: SOIL BORING LOCATIONS AT MWL