

SPARTON

SPARTON TECHNOLOGY

RECEIVED
NOV 15 1988
HAZARDOUS WASTE SECTION

November 14, 1988

Mr. Guy Tidmore
U.S. EPA Region VI
1445 Ross Avenue, Suite 1200
Dallas, TX 75202

RE: Monthly Report
Sparton Technology, Inc.

Dear Mr. Tidmore:

This is the monthly progress report for Sparton Technology, Inc.'s Coors Road Facility located in Albuquerque, New Mexico, as required in Section IV.C of the Consent Order. This report summarizes activities during the month of October 1988.

1. In accordance with Section IV.K of the Consent Order, Sparton provided notice of the Final Order to its officers, agents, servants, employees, and other persons in active concert or participation with them.
2. In accordance with Section IV.A.5 of the Consent Order, Sparton designated a Project Coordinator to oversee the implementation of the Final Order. Notice of this designation was provided to EPA in a letter dated October 6, 1988.
3. In accordance with Section IV.A.1 of the Consent Order, Sparton submitted and Interim Measures (IM) Work Plan to EPA on October 27, 1988.
4. In accordance with Section IV.A.2 of the Consent Order, Sparton has begun work on the Corrective Action Plan. Sparton's consultant, Harding Lawson Associates (HLA), is currently compiling a description of the current situation (Task I).
5. In accordance with Section IV.A.1 of the Consent Order, Sparton has completed pumping tests at each recovery well to determine aquifer characteristics and to estimate the volumes of groundwater to be treated and reused in the facility. A report describing the methodology and results of this testing is being prepared.

OGC-003025

November 14, 1988
Mr. Guy Tidmore
U.S. EPA Region VI
Page 2

6. In accordance with Section IV.L of the Consent Order, Sparton has entered into agreements with its agents, consultants, and contractors to maintain and preserve during the pendency of this Final Order and for five years after its termination, all records and documents within their respective possession which relate in any way to the Order or to hazardous waste disposal at the facility. Written confirmation of these agreements was provided to EPA in a letter dated November 3, 1988.
7. We have received verbal permission from the City of Albuquerque to install monitor wells in the right-of-way along Irving Boulevard. The formal permit agreement has been executed by Sparton, is currently being processed by the city, and we anticipate receipt of the signed permit by mid-November. The status of this access was reported to EPA in a letter dated November 3, 1988.
8. Sparton has completed the installation of all recovery and monitor wells required by the Consent Order. Boring Logs and well completion diagrams for each of these wells were in the IM Work Plan.
9. Sparton has contracted with Lobo Construction, Inc. of Albuquerque to install the groundwater collection and treatment system. This work is currently in progress.
10. The two underground tanks associated with the groundwater collection and treatment system have been registered with the New Mexico EID. A copy of the registration is included in Attachment 1.
11. HLA has compiled a summary of historical groundwater monitoring data for the Coors Road facility. A copy of this summary is included in Attachment 2.

This concludes our progress report for the month of October 1988. If you have any questions, please contact the undersigned.

Sincerely,

SPARTON TECHNOLOGY, INC.



Richard D. Mico
Vice President and General Manager

cc: Hazardous Waste Bureau
NM EID, Santa Fe, NM

B. Thompson
J. DeWitt
J. Mabrey
G. Richardson
V. Samala

SPARTON TECHNOLOGY, INC.

subsidiary of **SPARTON CORPORATION**

ATTACHMENT 1

Notification for Underground Storage Tanks

FORM APPROVED
OMB NO. 2500-0047
APPROVAL EXPIRES 6-30-88

GW/HW Bureau UST Section
P.O. Box 968; 2nd Floor S-2060
Santa Fe, NM 87501

ID Number
STATE USE ONLY
Date Received

GENERAL INFORMATION

Notification is required by Federal law for all underground tanks that have been used to store regulated substances since January 1, 1974, that are in the ground as of May 8, 1986, or that are brought into use after May 8, 1986. The information requested is required by Section 9002 of the Resource Conservation and Recovery Act (RCRA), as amended.

The primary purpose of this notification program is to locate and evaluate underground tanks that store or have stored petroleum or hazardous substances. It is expected that the information you provide will be based on reasonably available records, or, in the absence of such records, your knowledge, belief, or recollection.

Who Must Notify? Section 9002 of RCRA, as amended, requires that, unless exempted, owners of underground tanks that store regulated substances must notify designated State or local agencies of the existence of their tanks. Owner means—

(a) in the case of an underground storage tank in use on November 8, 1984, or brought into use after that date, any person who owns an underground storage tank used for the storage, use, or dispensing of regulated substances; and

(b) in the case of any underground storage tank in use before November 8, 1984, but no longer in use on that date, any person who owned such tank immediately before the discontinuation of its use.

What Tanks Are Included? Underground storage tank is defined as any one or combination of tanks that (1) is used to contain an accumulation of "regulated substances," and (2) whose volume (including connected underground piping) is 10% or more beneath the ground. Some examples are underground tanks storing: 1. gasoline, used oil, or diesel fuel; and 2. industrial solvents, pesticides, herbicides, or fumigants.

What Tanks Are Excluded? Tanks removed from the ground are not subject to notification. Other tanks excluded from notification are:

1. farm or residential tanks of 1,100 gallons or less capacity used for storing motor fuel for noncommercial purposes;
2. tanks used for storing heating oil for consumptive use on the premises where stored;
3. septic tanks;

4. pipeline facilities (including gathering lines) regulated under the Natural Gas Pipeline Safety Act of 1968, or the Hazardous Liquid Pipeline Safety Act of 1979 or which is an intrastate pipeline facility regulated under State laws;
5. surface impoundments, pits, ponds, or lagoons;
6. storm water or waste water collection systems;
7. flow-through process tanks;
8. liquid traps or associated gathering lines directly related to oil or gas production and gathering operations;
9. storage tanks situated in an underground area (such as a basement, cellar, mineworking, drift, shaft, or tunnel) if the storage tank is situated upon or above the surface of the floor.

What Substances Are Covered? The notification requirements apply to underground storage tanks that contain regulated substances. This includes any substance defined as hazardous in section 101 (14) of the Comprehensive Environmental Response, Compensation and Liability Act of 1980 (CERCLA), with the exception of those substances regulated as hazardous waste under Subtitle C of RCRA. It also includes petroleum, e.g., crude oil or any fraction thereof which is liquid at standard conditions of temperature and pressure (60 degrees Fahrenheit and 14.7 pounds per square inch absolute).

Where To Notify? Completed notification forms should be sent to the address given at the top of this page.

When To Notify? 1. Owners of underground storage tanks in use or that have been taken out of operation after January 1, 1974, but still in the ground, must notify by May 8, 1986. 2. Owners who bring underground storage tanks into use after May 8, 1986, must notify within 30 days of bringing the tanks into use.

Penalties: Any owner who knowingly fails to notify or submits false information shall be subject to a civil penalty not to exceed \$10,000 for each tank for which notification is not given or for which false information is submitted.

INSTRUCTIONS

Please type or print in ink all items except "signature" in Section V. This form must be completed for each location containing underground storage tanks. If more than 5 tanks are owned at this location, photocopy the reverse side, and staple continuation sheets to this form.

Indicate number of continuation sheets attached

0

I. OWNERSHIP OF TANK(S)

Owner Name (Corporation, Individual, Public Agency, or Other Entity)

Sparton Technology, Inc.

Street Address

4901 Rockaway Blvd., SE

County

Bernalillo

City

Rio Rancho

State

NM

ZIP Code

87124

Area Code

Phone Number

(505) 892-5300

Type of Owner (Mark all that apply ☒)

☒ Current

☐ State or Local Gov't

☒ Private or Corporate

☐ Former

☐ Federal Gov't (GSA facility I.D. no.)

☐ Ownership uncertain

II. LOCATION OF TANK(S)

(If same as Section I, mark box here ☐)

Facility Name or Company Site Identifier, as applicable

Coors Road Facility

Street Address or State Road, as applicable

9621 Coors Road, NW

County

Bernalillo

City (nearest)

Albuquerque

State

NM

ZIP Code

87114

Indicate number of tanks at this location

2

Mark box here if tank(s) are located on land within an Indian reservation or on other Indian trust lands ☐

III. CONTACT PERSON AT TANK LOCATION

Name (If same as Section I, mark box here ☐)

Richard D. Mico

Job Title

Vice President/General Manager

Area Code

(505) 892-5300

Phone Number

IV. TYPE OF NOTIFICATION

☐ Mark box here only if this is an amended or subsequent notification for this location.

V. CERTIFICATION (Read and sign after completing Section VI.)

I certify under penalty of law that I have personally examined and am familiar with the information submitted in this and all attached documents, and that based on my inquiry of those individuals immediately responsible for obtaining the information, I believe that the submitted information is true, accurate, and complete.

Name and official title of owner or owner's authorized representative

R.D. Mico - Vice President/Gen. Manager

Signature

Richard D. Mico

Date Signed

10/17/88

CONTINUE ON REVERSE SIDE

VI. DESCRIPTION OF UNDERGROUND STORAGE TANKS (Complete for each tank at this location.)

Tank Identification No. (e.g., ABC-123), or Arbitrarily Assigned Sequential Number (e.g., 1,2,3...)	Tank No. 1	Tank No. 2	Tank No.	Tank No.	Tank No.
1. Status of Tank (Mark all that apply <input checked="" type="checkbox"/>) Currently in Use Temporarily Out of Use Permanently Out of Use Brought into Use after 5/8/86	<input checked="" type="checkbox"/> <input type="checkbox"/> <input type="checkbox"/> <input checked="" type="checkbox"/>	<input checked="" type="checkbox"/> <input type="checkbox"/> <input type="checkbox"/> <input checked="" type="checkbox"/>	<input type="checkbox"/> <input type="checkbox"/> <input type="checkbox"/> <input type="checkbox"/>	<input type="checkbox"/> <input type="checkbox"/> <input type="checkbox"/> <input type="checkbox"/>	<input type="checkbox"/> <input type="checkbox"/> <input type="checkbox"/> <input type="checkbox"/>
2. Estimated Age (Years)	0	0			
3. Estimated Total Capacity (Gallons)	550	15,000			
4. Material of Construction (Mark one <input checked="" type="checkbox"/>) Steel Concrete Fiberglass Reinforced Plastic Unknown Other, Please Specify	<input checked="" type="checkbox"/> <input type="checkbox"/> <input type="checkbox"/> <input type="checkbox"/> Double Wall	<input checked="" type="checkbox"/> <input type="checkbox"/> <input type="checkbox"/> <input type="checkbox"/> Double Wall	<input type="checkbox"/> <input type="checkbox"/> <input type="checkbox"/> <input type="checkbox"/> 	<input type="checkbox"/> <input type="checkbox"/> <input type="checkbox"/> <input type="checkbox"/> 	<input type="checkbox"/> <input type="checkbox"/> <input type="checkbox"/> <input type="checkbox"/>
5. Internal Protection (Mark all that apply <input checked="" type="checkbox"/>) Cathodic Protection Interior Lining (e.g., epoxy resins) None Unknown Other, Please Specify	<input type="checkbox"/> <input type="checkbox"/> <input checked="" type="checkbox"/> <input type="checkbox"/> 	<input type="checkbox"/> <input type="checkbox"/> <input checked="" type="checkbox"/> <input type="checkbox"/> 	<input type="checkbox"/> <input type="checkbox"/> <input type="checkbox"/> <input type="checkbox"/> 	<input type="checkbox"/> <input type="checkbox"/> <input type="checkbox"/> <input type="checkbox"/> 	<input type="checkbox"/> <input type="checkbox"/> <input type="checkbox"/> <input type="checkbox"/>
6. External Protection (Mark all that apply <input checked="" type="checkbox"/>) Cathodic Protection Painted (e.g., asphaltic) Fiberglass Reinforced Plastic Coated None Unknown Other, Please Specify	<input type="checkbox"/> <input type="checkbox"/> <input checked="" type="checkbox"/> <input type="checkbox"/> <input type="checkbox"/> 	<input type="checkbox"/> <input type="checkbox"/> <input checked="" type="checkbox"/> <input type="checkbox"/> <input type="checkbox"/> 	<input type="checkbox"/> <input type="checkbox"/> <input type="checkbox"/> <input type="checkbox"/> <input type="checkbox"/> 	<input type="checkbox"/> <input type="checkbox"/> <input type="checkbox"/> <input type="checkbox"/> <input type="checkbox"/> 	<input type="checkbox"/> <input type="checkbox"/> <input type="checkbox"/> <input type="checkbox"/> <input type="checkbox"/>
7. Piping (Mark all that apply <input checked="" type="checkbox"/>) Bare Steel Galvanized Steel Fiberglass Reinforced Plastic Cathodically Protected Unknown Other, Please Specify	<input type="checkbox"/> <input type="checkbox"/> <input type="checkbox"/> <input type="checkbox"/> <input type="checkbox"/> HDPE	<input type="checkbox"/> <input type="checkbox"/> <input type="checkbox"/> <input type="checkbox"/> <input type="checkbox"/> PVC	<input type="checkbox"/> <input type="checkbox"/> <input type="checkbox"/> <input type="checkbox"/> <input type="checkbox"/> 	<input type="checkbox"/> <input type="checkbox"/> <input type="checkbox"/> <input type="checkbox"/> <input type="checkbox"/> 	<input type="checkbox"/> <input type="checkbox"/> <input type="checkbox"/> <input type="checkbox"/> <input type="checkbox"/>
8. Substance Currently or Last Stored in Greatest Quantity by Volume (Mark all that apply <input checked="" type="checkbox"/>) a. Empty b. Petroleum Diesel Kerosene Gasoline (including alcohol blends) Used Oil Other, Please Specify c. Hazardous Substance Please Indicate Name of Principal CERCLA Substance OR Chemical Abstract Service (CAS) No. Mark box <input checked="" type="checkbox"/> if tank stores a mixture of substances d. Unknown	<input type="checkbox"/> <input type="checkbox"/> <input type="checkbox"/> <input type="checkbox"/> <input type="checkbox"/> <input type="checkbox"/> <input checked="" type="checkbox"/> TCE <input type="checkbox"/> <input checked="" type="checkbox"/> <input type="checkbox"/>	<input type="checkbox"/> <input type="checkbox"/> <input type="checkbox"/> <input type="checkbox"/> <input type="checkbox"/> <input type="checkbox"/> <input checked="" type="checkbox"/> TCE <input type="checkbox"/> <input checked="" type="checkbox"/> <input type="checkbox"/>	<input type="checkbox"/> <input type="checkbox"/> <input type="checkbox"/> <input type="checkbox"/> <input type="checkbox"/> <input type="checkbox"/> <input type="checkbox"/> <input type="checkbox"/> <input type="checkbox"/>	<input type="checkbox"/> <input type="checkbox"/> <input type="checkbox"/> <input type="checkbox"/> <input type="checkbox"/> <input type="checkbox"/> <input type="checkbox"/> <input type="checkbox"/> <input type="checkbox"/>	<input type="checkbox"/> <input type="checkbox"/> <input type="checkbox"/> <input type="checkbox"/> <input type="checkbox"/> <input type="checkbox"/> <input type="checkbox"/> <input type="checkbox"/> <input type="checkbox"/>
9. Additional Information (for tanks permanently taken out of service) a. Estimated date last used (mo/yr) b. Estimated quantity of substance remaining (gal.) c. Mark box <input checked="" type="checkbox"/> if tank was filled with inert material (e.g., sand, concrete)	 <input checked="" type="checkbox"/>	 <input checked="" type="checkbox"/>	 <input type="checkbox"/>	 <input type="checkbox"/>	 <input type="checkbox"/>

ATTACHMENT 2

SPARTON TECHNOLOGY, INC.

COORS ROAD FACILITY

GROUNDWATER MONITORING SUMMARY

OCTOBER 1988

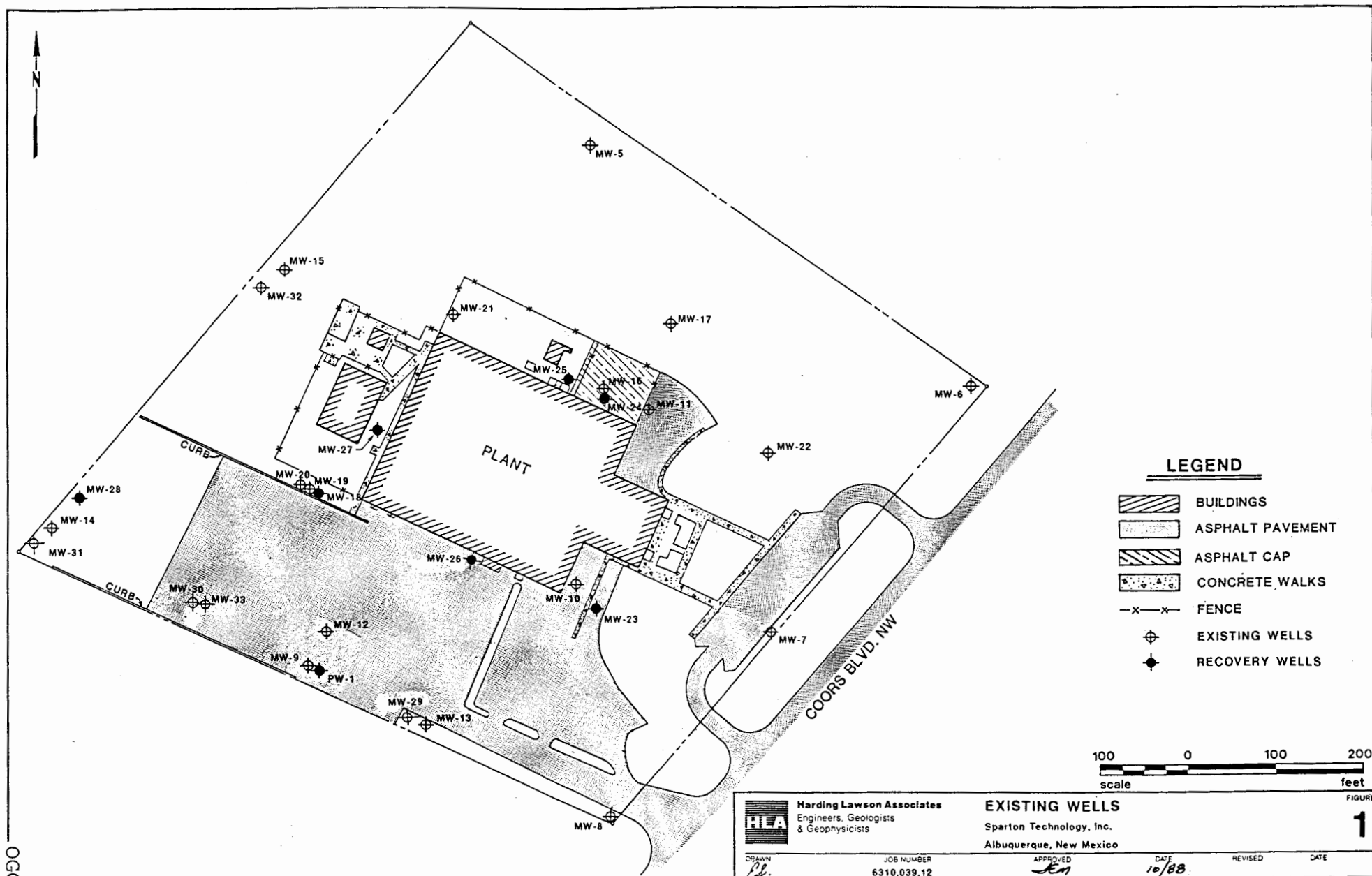

OGC-003032

SPARTON

SPARTON TECHNOLOGY

RECEIVED
DEC 22 1988
HAZARDOUS WASTE SECTION

December 19, 1988

State of New Mexico
Environmental Improvement Division
Harold Runnels Bldg.
1190 St. Francis Drive
Santa Fe, NM 87503

Attention: Ms. V. Suzanne Moore-Mayne
Water Resource Specialist II

RE: NMD083212332

Dear Ms. Moore-Mayne:

As requested in your letter of November 21, 1988, attached is the available historical water level data.

If you have any questions of a technical nature, please call Mr. Gary Richardson, Metric Corporation at 828-2801.

Sincerely,

SPARTON TECHNOLOGY, INC.

Re D Mico

Richard D. Mico
Vice President and General Manager

cc: Mr. Blair Thompson
Mr. Jon DeWitt
Mr. Jay Mabrey
Mr. Gary Richardson
Mr. Ven Samala

Attach.

OGC-003034

GRANITE TECHNOLOGY, INC.
COORS ROAD FACILITY
ALBUQUERQUE, NEW MEXICO
HISTORICAL GEOMORPHIC MONITORING ELEVATIONS SUMMARY

		PLOT ABOVE ROAD SEA LEVEL																						
YEAR	QUARTER	M05	M06	M07	M08	M09	M010	M011	M012	M013	M014	M015	M016	M017	M018	M019	M020	M021	M022	M023				
1985	1	4980.57	---	---	4978.14	4976.52	4983.40	4975.66	---	---	---	---	---	---	---	---	---	---	---	---				
1985	2	---	4980.54	---	4979.13	4977.22	4976.90	4976.20	---	---	---	---	---	---	---	---	---	---	---	---				
1985	3	---	---	---	---	---	---	---	---	---	---	---	---	---	---	---	---	---	---	---				
1985	4	---	---	---	---	---	---	---	---	---	---	---	---	---	---	---	---	---	---	---				
1986	1	---	4980.54	---	4978.66	4976.95	4976.71	4975.99	---	---	---	---	---	---	---	---	---	---	---	---				
1986	2	---	---	---	---	---	---	---	---	---	---	---	---	---	---	---	---	---	---	---				
1986	3	---	---	---	---	---	---	---	---	---	---	---	---	---	---	---	---	---	---	---				
1986	4	---	4981.65	---	4979.39	4977.00	---	4976.58	---	---	4976.23	4976.40	4981.23	---	4977.96	4976.01	4976.51	4980.75	4980.84	4979.97				
1987	1	---	4980.52	---	4977.00	4976.76	---	4975.64	---	---	4975.27	4975.58	4980.73	---	4977.33	4975.84	4975.54	4980.49	4980.10	4978.79				
1987	2	---	4980.04	---	4976.67	4976.27	---	4975.27	---	---	4974.94	4975.38	4980.32	---	4976.53	4975.47	4975.21	4980.11	4979.62	4978.34				
1987	3	4991.05	4980.92	4980.50	4979.71	4977.56	4977.03	4976.22	4976.92	4978.21	4975.74	4975.98	4980.79	4980.96	4977.47	4976.47	4976.13	4980.53	4980.73	4979.82				
1987	4	---	4981.07	---	4978.00	4977.40	---	4976.09	---	---	4975.72	4975.84	4980.93	---	4977.67	4976.32	4976.04	4980.83	4980.66	4979.75				
1988	1	---	4980.19	---	4976.67	4975.73	---	4974.91	---	---	4974.63	4976.87	4979.43	---	4976.41	4975.17	4974.88	4979.96	4979.50	4978.05				
1988	2	---	4980.09	---	4976.30	4976.11	---	4975.85	---	---	4973.34	4976.40	4979.43	---	4976.13	4975.26	4975.08	4979.74	4979.56	4978.29				
1988	3	---	4980.48	---	4972.74	4976.30	---	4975.35	---	---	4974.39	4976.05	4978.46	---	4976.58	4975.60	4975.32	4980.16	4976.28	4978.83				

SPARTON TECHNOLOGY, INC.
COORS ROAD FACILITY
GROUNDWATER WELL SUMMARY

WELL NO.		DATE * INSTALLED (mo/yr)	DIAMETER (inches)	DEPTH (feet)	SCREENED INTERVAL(S) (feet)	ZONE SCREENED (upper; lower; or both)	ZONE MONITORED (upper or lower)	COMMENTS
PW-1	*	09/84	10	145	60-70/80-138	BOTH	UPPER	CASING PLUGGED FROM BOTTOM UP THRU AQUITARD
01	-	05/83	2	90	70-90	BOTH	---	WELL PLUGGED AND ABANDONED
02	-	05/83	2	90	70-90	BOTH	---	WELL PLUGGED AND ABANDONED
03	-	05/83	2	85	65-85	BOTH	---	WELL PLUGGED AND ABANDONED
04	-	05/83	2	90	70-90	BOTH	---	WELL PLUGGED AND ABANDONED
05	#	11/83	2	83	68-78	UPPER	UPPER	---
06	#	11/83	2	71.5	61.5-66.5	UPPER	UPPER	---
07	-	11/83	2	73.5	63.5-68.5	UPPER	UPPER	---
08	#	11/83	2	68	58-63	UPPER	UPPER	---
09	-	11/83	2	72.5	62.5-67.5	UPPER	UPPER	---
10	#	11/83	2	145	135-140	LOWER	LOWER	---
11	#	11/83	2	144	134-139	LOWER	LOWER	---
12	-	08/84	4	140	64-133	BOTH	UPPER	CASING PLUGGED FROM BOTTOM UP THRU AQUITARD
13	+	08/84	2	140	60-139.5	BOTH	UPPER	CASING PLUGGED FROM BOTTOM UP THRU AQUITARD
14	+	08/84	2	130	61-127	BOTH	UPPER	CASING PLUGGED FROM BOTTOM UP THRU AQUITARD
15	+	08/84	2	140	60-124.5	BOTH	UPPER	CASING PLUGGED FROM BOTTOM UP THRU AQUITARD
16	-	08/84	2	73	68-73	UPPER	UPPER	---
17	-	08/84	2	72	67-72	UPPER	UPPER	---
18	*	05/86	4	81	68-78	UPPER	UPPER	---
19	-	09/86	4	110	97-107	LOWER	LOWER	---
20	-	09/86	4	138	125-138	LOWER	LOWER	---
21	-	08/86	2	69.5	64.5-69.5	UPPER	UPPER	---
22	-	08/86	2	78	72-77	UPPER	UPPER	---
23	*	08/86	2	78	72-77	UPPER	UPPER	---
24	*	12/86	2	75	68.4-73.4	UPPER	UPPER	---
25	*	12/86	2	75	67.7-72.7	UPPER	UPPER	---
26	*	05/88	2	78.5	73-78	UPPER	UPPER	---
27	*	05/88	2	72	67-72	UPPER	UPPER	---
28	*	05/88	2	70	65-70	UPPER	UPPER	---
29	+	06/88	4	115.5	103-113	LOWER	LOWER	---
30	+	06/88	4	109.5	97-107	LOWER	LOWER	---
31	+	06/88	4	109	96-106	LOWER	LOWER	---
32	+	06/88	4	120	108-118	LOWER	LOWER	---
33	+	10/88	2	73	63-73	UPPER	UPPER	---

* = GROUNDWATER RECOVERY WELL
+ = CONSENT ORDER MONITOR WELL
= SCHEDULED TO BE PLUGGED AND ABANDONED

SPARTON TECHNOLOGY, INC.
COORS ROAD FACILITY
GROUNDWATER MONITORING RESULTS
PART 1 of 3

[----- mg/l -----]																
YEAR	QUARTER NO.	pH units (6-9)	SPECIFIC CONDUCTANCE umhos/cm	CHLORIDE (250)	NITRATE + NITRITE AS N (10.0)	SULFATE (600)	TOTAL ORGANIC CARBON	TOTAL ORGANIC HALOGEN as Cl	TOTAL KJELDAHL NITROGEN as N	HEXA-VALENT CHROMIUM	TRI-VALENT CHROMIUM	AMMONIA NITROGEN as N	BORON	TOTAL CHROMIUM (0.05)	MANGANESE (0.2)	NICKEL
***** WELL NO. 05 (UPPER FLOW ZONE) *****																
1983	4	8.00	688	22	0.9	81	21	---	---	---	---	ND	---	---	0.37	---
1984	4	7.64	721	---	1.8	112	3.8	0.22	0.6	ND	ND	---	0.12	ND	0.68	ND
1985	1	8.09	711	---	---	---	0.9	0.21	---	---	---	---	---	---	---	---
1985	2	---	---	---	---	---	---	---	---	---	---	---	---	---	---	---
1985	3	---	---	---	---	---	---	---	---	---	---	---	---	---	---	---
1985	4	---	---	---	---	---	---	---	---	---	---	---	---	---	---	---
1986	1	---	---	---	---	---	---	---	---	---	---	---	---	---	---	---
1986	2	---	---	---	---	---	---	---	---	---	---	---	---	---	---	---
1986	3	---	---	---	---	---	---	---	---	---	---	---	---	---	---	---
1986	4	---	---	---	---	---	---	---	---	---	---	---	---	---	---	---
1987	1	---	---	---	---	---	---	---	---	---	---	---	---	---	---	---
1987	2	---	---	---	---	---	---	---	---	---	---	---	---	---	---	---
1987	3	8.07	640	27	0.8	91	2	0.04	0.5	ND	0.01	0.2	0.14	0.01	0.34	ND
1987	4	---	---	---	---	---	---	---	---	---	---	---	---	---	---	---
1988	1	---	---	---	---	---	---	---	---	---	---	---	---	---	---	---
1988	2	---	---	---	---	---	---	---	---	---	---	---	---	---	---	---
1988	3	---	---	---	---	---	---	---	---	---	---	---	---	---	---	---

NOTES : WHERE STATE STANDARDS EXIST, THEY ARE SHOWN IN PARENTHESES IMMEDIATELY BELOW THE CHEMICAL NAME.
ND = NOT DETECTED ; EDL = BELOW DETECTION LIMITS ; --- = NOT TESTED.

SPARTON TECHNOLOGY, INC.
COORS ROAD FACILITY
GROUNDWATER MONITORING RESULTS
PART 1 of 3

[----- mg/l -----]															
QUARTER		pH	SPECIFIC		NITRATE +		TOTAL	TOTAL							
YEAR	NO.	units	CONDUCTANCE	CHLORIDE	NITRITE AS N	SULFATE	ORGANIC	ORGANIC	KJELDAHL	HEXA-VALENT	TRI-VALENT	AMMONIA		TOTAL	MANGANESE
		(6-9)	umhos/cm	(250)	(10.0)	(600)	CARBON	HALOGEN as Cl	NITROGEN as N	CHROMIUM	CHROMIUM	as N	BORON	CHROMIUM (0.05)	(0.2)
----	---	----	-----	-----	-----	-----	-----	-----	-----	-----	-----	-----	-----	-----	-----
***** WELL NO. 06 (UPPER FLOW ZONE) *****															
1983	4	7.97	821	38	10	95	7.8	---	---	---	---	ND	---	---	0.032
1984	4	7.50	866	---	16	120	6.1	0.45	0.1	ND	ND	---	0.25	ND	0.34
1985	1	---	---	---	---	---	---	---	---	---	---	---	---	---	---
1985	2	7.89	871	---	---	---	1.7	0.31	---	---	---	---	---	---	---
1985	3	7.46	833	38	15	140	1.4	0.4	ND	ND	ND	---	0.33	ND	0.23
1985	4	---	---	---	---	---	---	---	---	---	---	---	---	---	---
1986	1	7.43	810	---	---	---	12	0.32	---	---	---	---	---	---	---
1986	2	7.34	821	---	---	---	1.9	1.4	---	---	---	---	---	---	---
1986	3	7.77	831	---	---	---	6.3	0.59	---	---	---	---	---	---	---
1986	4	7.72	846	28	14	142	4.4	0.421	ND	ND	ND	---	0.3	ND	---
1987	1	8.03	886	---	---	---	3.7	0.26	---	---	---	---	---	---	---
1987	2	7.61	879	---	---	---	1.2	0.18	---	---	---	---	---	---	---
1987	3	7.61	784	27	14	12	3.3	0.35	ND	ND	ND	0.2	0.34	ND	0.066
1987	4	7.55	832	---	---	---	0.4	0.3	---	---	---	---	---	---	---
1988	1	7.62	885	---	---	---	1.1	0.19	---	---	---	---	---	---	---
1988	2	7.61	880	---	---	---	1.5	0.15	---	---	---	---	---	---	---
1988	3	7.60	812	23	20	118	2.3	0.120	ND	0.01	ND	ND	0.31	ND	0.042

NOTES : WHERE STATE STANDARDS EXIST, THEY ARE SHOWN IN PARENTHESES IMMEDIATELY BELOW THE CHEMICAL NAME.

ND = NOT DETECTED ; BDL = BELOW DETECTION LIMITS ; --- = NOT TESTED.

SPARTON TECHNOLOGY, INC.
COORS ROAD FACILITY
GROUNDWATER MONITORING RESULTS
PART 1 of 3

[----- mg/l -----]															
QUARTER	pH	SPECIFIC		NITRATE +		TOTAL	TOTAL	TOTAL	HEXA-	TRI-	AMMONIA		TOTAL	MANGANESE	
YEAR	NO.	units	CONDUC-	CHLORIDE	AS N	SULFATE	ORGANIC	ORGANIC	VALENT	VALENT	NITROGEN		CHROMIUM	(0.2)	NICKEL
----	---	(6-9)	TANCE	(250)	(10.0)	(600)	CARBON	HALOGEN	CHROMIUM	CHROMIUM	as N	BORON	(0.05)		-----
----	---	----	umhos/cm	----	----	----	----	as Cl	as N	----	----	----	----	----	----
***** WELL NO. 07 (UPPER FLOW ZONE) *****															
1983	4	7.94	507	116	0.4	39	80	---	---	---	ND	---	---	0.089	---
1984	4	7.43	692	---	3.3	85	3.6	0.85	0.2	0.02	ND	0.11	0.021	0.03	ND
1985	1	---	---	---	---	---	---	---	---	---	---	---	---	---	---
1985	2	---	---	---	---	---	---	---	---	---	---	---	---	---	---
1985	3	---	---	---	---	---	---	---	---	---	---	---	---	---	---
1985	4	---	---	---	---	---	---	---	---	---	---	---	---	---	---
1986	1	---	---	---	---	---	---	---	---	---	---	---	---	---	---
1986	2	---	---	---	---	---	---	---	---	---	---	---	---	---	---
1986	3	---	---	---	---	---	---	---	---	---	---	---	---	---	---
1986	4	---	---	---	---	---	---	---	---	---	---	---	---	---	---
1987	1	---	---	---	---	---	---	---	---	---	---	---	---	---	---
1987	2	---	---	---	---	---	---	---	---	---	---	---	---	---	---
1987	3	8.12	693	23	3	103	0.6	0.21	ND	ND	ND	0.18	ND	0.032	ND
1987	4	---	---	---	---	---	---	---	---	---	---	---	---	---	---
1988	1	---	---	---	---	---	---	---	---	---	---	---	---	---	---
1988	2	---	---	---	---	---	---	---	---	---	---	---	---	---	---
1988	3	---	---	---	---	---	---	---	---	---	---	---	---	---	---

NOTES : WHERE STATE STANDARDS EXIST, THEY ARE SHOWN IN PARENTHESES IMMEDIATELY BELOW THE CHEMICAL NAME.

ND = NOT DETECTED ; BDL = BELOW DETECTION LIMITS ; --- = NOT TESTED.

SPARTON TECHNOLOGY, INC.
COORS ROAD FACILITY
GROUNDWATER MONITORING RESULTS
PART 1 of 3

[----- mg/l -----]																
YEAR	QUARTER NO.	pH units (6-9)	SPECIFIC CONDUCTANCE umhos/cm	CHLORIDE (250)	NITRATE + NITRITE AS N (10.0)	SULFATE (600)	TOTAL ORGANIC CARBON	TOTAL ORGANIC HALOGEN as Cl	TOTAL KJELDAHL NITROGEN as N	HEXA-VALENT CHROMIUM	TRI-VALENT CHROMIUM	AMMONIA NITROGEN as N	BORON	TOTAL CHROMIUM (0.05)	MANGANESE (0.2)	NICKEL
***** WELL NO. 08 (UPPER FLOW ZONE) *****																
1983	4	8.05	579	18	1.7	65	15	---	---	---	---	ND	---	---	0.098	---
1984	4	7.50	763	---	7.4	80	5.5	0.18	0.4	ND	ND	---	0.37	ND	ND	ND
1985	1	7.96	735	---	---	---	2.1	0.088	---	---	---	---	---	---	---	---
1985	2	7.78	741	---	---	---	1.3	0.15	---	---	---	---	---	---	---	---
1985	3	7.42	715	33	5.5	69	1.8	0.38	ND	ND	ND	---	0.31	ND	ND	ND
1985	4	---	---	---	---	---	---	---	---	---	---	---	---	---	---	---
1986	1	7.40	708	---	---	---	16	0.098	---	---	---	---	---	---	---	---
1986	2	7.27	764	---	---	---	2	0.18	---	---	---	---	---	---	---	---
1986	3	7.68	754	---	---	---	14	0.37	---	---	---	---	---	---	---	---
1986	4	7.48	784	37	2.1	74	1.3	0.233	ND	ND	ND	---	0.52	ND	---	ND
1987	1	8.22	754	---	---	---	2	0.069	---	---	---	---	---	---	---	---
1987	2	7.78	772	---	---	---	3.3	0.054	---	---	---	---	---	---	---	---
1987	3	7.61	705	37	3	53	3.2	0.15	0.2	ND	ND	0.1	0.38	ND	0.22	ND
1987	4	7.59	703	---	---	---	3	0.07	---	---	---	---	---	---	---	---
1988	1	7.82	782	---	---	---	3.7	0.042	---	---	---	---	---	---	---	---
1988	2	7.56	799	---	---	---	1.5	0.052	---	---	---	---	---	---	---	---
1988	3	7.60	737	23	1.7	71-	2.5	0.070	0.1	ND	0.01	ND	0.57	0.01	0.18	ND

NOTES : WHERE STATE STANDARDS EXIST, THEY ARE SHOWN IN PARENTHESES IMMEDIATELY BELOW THE CHEMICAL NAME.

ND = NOT DETECTED ; BDL = BELOW DETECTION LIMITS ; --- = NOT TESTED.

OGC-003040

SPARTON TECHNOLOGY, INC.
COORS ROAD FACILITY
GROUNDWATER MONITORING RESULTS
PART 1 of 3

[----- mg/l -----]																
YEAR	QUARTER NO.	pH units (6-9)	SPECIFIC CONDUCTANCE umhos/cm	CHLORIDE (250)	NITRATE + NITRITE AS N (10.0)	SULFATE (600)	TOTAL ORGANIC CARBON	TOTAL ORGANIC HALOGEN as Cl	TOTAL KJELDAHL NITROGEN as N	HEXA-VALENT CHROMIUM	TRI-VALENT CHROMIUM	AMMONIA NITROGEN as N	BORON	TOTAL CHROMIUM (0.05)	MANGANESE (0.2)	NICKEL
***** WELL NO. 09 (UPPER FLOW ZONE) *****																
1983	4	7.36	2320	400	ND	340	29	---	---	---	---	ND	---	---	3.4	---
1984	4	6.70	2350	---	ND	372	14	21	1.7	ND	ND	---	13	ND	1.9	0.19
1985	1	7.00	2040	---	---	---	6.1	15	---	---	---	---	---	---	---	---
1985	2	7.31	1770	---	---	---	7.2	9.1	---	---	---	---	---	---	---	---
1985	3	6.92	1590	210	ND	300	4.6	6.9	0.9	ND	ND	---	7.9	ND	1.1	0.11
1985	4	---	---	---	---	---	---	---	---	---	---	---	---	---	---	---
1986	1	6.96	1340	---	---	---	20	6.7	---	---	---	---	---	---	---	---
1986	2	7.02	1380	---	---	---	3	5	---	---	---	---	---	---	---	---
1986	3	7.46	1480	---	---	---	3.1	6.3	---	---	---	---	---	---	---	---
1986	4	7.71	1470	138	ND	226	1.4	5.08	5.1	ND	ND	---	5.5	ND	---	0.081
1987	1	8.03	1440	---	---	---	3	3.2	---	---	---	---	---	---	---	---
1987	2	7.66	1370	---	---	---	2.1	4.0	---	---	---	---	---	---	---	---
1987	3	7.87	1300	116	ND	203	2	4.4	2.6	ND	ND	2.2	4	ND	0.24	0.06
1987	4	7.39	1220	---	---	---	2.8	2.6	---	---	---	---	---	---	---	---
1988	1	8.29	1210	---	---	---	1.7	2.5	---	---	---	---	---	---	---	---
1988	2	7.26	1130	---	---	---	2.7	3.6	---	---	---	---	---	---	---	---
1988	3	7.30	1040	66	ND	182	3.8	2.870	1.7	ND	0.01	1.1	3.5	0.01	1.3	ND

NOTES : WHERE STATE STANDARDS EXIST, THEY ARE SHOWN IN PARENTHESES IMMEDIATELY BELOW THE CHEMICAL NAME.
ND = NOT DETECTED ; BDL = BELOW DETECTION LIMITS ; --- = NOT TESTED.

OGC-003041

SPARTON TECHNOLOGY, INC.
COORS ROAD FACILITY
GROUNDWATER MONITORING RESULTS
PART 1 of 3

[----- mg/l -----]															
QUARTER	pH	SPECIFIC		NITRATE +		TOTAL	TOTAL	TOTAL	HEXA-	TRI-	AMMONIA		TOTAL	MANGANESE	
YEAR	NO.	units	CONDUCTANCE	CHLORIDE	AS N	SULFATE	ORGANIC	ORGANIC	VALENT	VALENT	NITROGEN	BORON	CHROMIUM	(0.2)	NICKEL
		(6-9)	umhos/cm	(250)	(10.0)	(600)	CARBON	as Cl	as N	CHROMIUM	CHROMIUM	as N		(0.05)	
***** WELL NO. 10 (LOWER FLOW ZONE) *****															
1983	4	8.03	694	26	0.1	95	7.6	---	---	---	---	0.1	---	---	0.75
1984	4	7.74	702	---	0.2	119	3	0.04	0.4	ND	ND	---	ND	0.01	0.93
1985	1	7.73	689	---	---	---	1.7	0.013	---	---	---	---	---	---	---
1985	2	7.94	702	---	---	---	1.6	0.013	---	---	---	---	---	---	---
1985	3	7.39	694	28	ND	125	9	0.05	ND	ND	ND	---	0.15	ND	1
1985	4	---	---	---	---	---	---	---	---	---	---	---	---	---	---
1986	1	7.49	678	---	---	---	8.8	0.076	---	---	---	---	---	---	---
1986	2	7.30	673	---	---	---	10	0.14	---	---	---	---	---	---	---
1986	3	7.86	681	---	---	---	2.1	0.13	---	---	---	---	---	---	---
1986	4	---	---	---	---	---	---	---	---	---	---	---	---	---	---
1987	1	---	---	---	---	---	---	---	---	---	---	---	---	---	---
1987	2	---	---	---	---	---	---	---	---	---	---	---	---	---	---
1987	3	7.71	679	44	ND	102	4.7	1.8	0.1	ND	ND	0.1	0.5	ND	1.2
1987	4	---	---	---	---	---	---	---	---	---	---	---	---	---	---
1988	1	---	---	---	---	---	---	---	---	---	---	---	---	---	---
1988	2	---	---	---	---	---	---	---	---	---	---	---	---	---	---
1988	3	---	---	---	---	---	---	---	---	---	---	---	---	---	---

NOTES : WHERE STATE STANDARDS EXIST, THEY ARE SHOWN IN PARENTHESES IMMEDIATELY BELOW THE CHEMICAL NAME.
ND = NOT DETECTED ; BDL = BELOW DETECTION LIMITS ; --- = NOT TESTED.

SPARTON TECHNOLOGY, INC.
COORS ROAD FACILITY
GROUNDWATER MONITORING RESULTS
PART 1 of 3

[-----] mg/l -----]																
QUARTER YEAR NO.		PH units (6-9)	SPECIFIC CONDUCT- TANCE umhos/cm	CHLORIDE (250)	NITRATE + NITRITE AS N (10.0)	SULFATE (600)	TOTAL ORGANIC CARBON	TOTAL ORGANIC HALOGEN as Cl	TOTAL KJELDAHL NITROGEN as N	HEXA- VALENT CHROMIUM	TRI- VALENT CHROMIUM	AMMONIA NITROGEN as N	BORON	TOTAL CHROMIUM (0.05)	MANGANESE (0.2)	NICKEL
***** WELL NO. 11 (LOWER FLOW ZONE) *****																
1983	4	7.89	741	30	ND	97	18	---	---	---	---	ND	---	---	0.76	---
1984	4	7.76	699	---	0.5	118	2.2	0.006	0.6	ND	ND	---	ND	0.01	0.78	0.006
1985	1	8.01	733	---	---	---	1.7	0.032	---	---	---	---	---	---	---	---
1985	2	7.95	752	---	---	---	1.7	0.01	---	---	---	---	---	---	---	---
1985	3	7.57	697	29	ND	130	1.7	0.01	ND	ND	ND	---	0.12	ND	0.98	ND
1985	4	---	---	---	---	---	---	---	---	---	---	---	---	---	---	---
1986	1	7.53	717	---	---	---	4.2	0.014	---	---	---	---	---	---	---	---
1986	2	7.38	679	---	---	---	11	0.19	---	---	---	---	---	---	---	---
1986	3	7.87	683	---	---	---	2.4	0.058	---	---	---	---	---	---	---	---
1986	4	7.76	696	28	ND	110	1.3	0.0096	ND	ND	ND	---	0.1	ND	---	ND
1987	1	8.18	692	---	---	---	8.5	0.011	---	---	---	---	---	---	---	---
1987	2	7.69	660	---	---	---	1.7	ND	---	---	---	---	---	---	---	---
1987	3	7.65	639	22	ND	77	3.2	0.038	0.3	ND	ND	0.1	0.14	ND	0.98	ND
1987	4	7.55	832	---	---	---	0.4	0.3	---	---	---	---	---	---	---	---
1988	1	7.84	666	---	---	---	1.1	0.012	---	---	---	---	---	---	---	---
1988	2	7.69	611	---	---	---	1.9	0.021	---	---	---	---	---	---	---	---
1988	3	7.60	560	18	ND	85	2.0	0.010	0.4	ND	ND	ND	0.12	ND	0.75	ND

NOTES : WHERE STATE STANDARDS EXIST, THEY ARE SHOWN IN PARENTHESES IMMEDIATELY BELOW THE CHEMICAL NAME.
ND = NOT DETECTED ; BDL = BELOW DETECTION LIMITS ; --- = NOT TESTED.

SPARTON TECHNOLOGY, INC.
COORS ROAD FACILITY
GROUNDWATER MONITORING RESULTS
PART 1 of 3

[----- mg/l -----]

YEAR	QUARTER NO.	pH units (6-9)	SPECIFIC CONDUCTANCE umhos/cm	CHLORIDE (250)	NITRATE + NITRITE AS N (10.0)	SULFATE (600)	TOTAL ORGANIC CARBON	TOTAL ORGANIC HALOGEN as Cl	TOTAL KJELDAHL NITROGEN as N	HEXA-VALENT CHROMIUM	TRI-VALENT CHROMIUM	AMMONIA NITROGEN as N	BORON	TOTAL CHROMIUM (0.05)	MANGANESE (0.2)	NICKEL
-----	-----	-----	-----	-----	-----	-----	-----	-----	-----	-----	-----	-----	-----	-----	-----	-----
***** WELL NO. 12 (UPPER FLOW ZONE) *****																
1983	4	---	---	---	---	---	---	---	---	---	---	---	---	---	---	---
1984	3	7.65	769	23	1.32	136	1.7	0.074	---	ND	ND	ND	0.12	ND	0.98	ND
1985	1	---	---	---	---	---	---	---	---	---	---	---	---	---	---	---
1985	2	---	---	---	---	---	---	---	---	---	---	---	---	---	---	---
1985	3	---	---	---	---	---	---	---	---	---	---	---	---	---	---	---
1985	4	---	---	---	---	---	---	---	---	---	---	---	---	---	---	---
1986	1	---	---	---	---	---	---	---	---	---	---	---	---	---	---	---
1986	2	---	---	---	---	---	---	---	---	---	---	---	---	---	---	---
1986	3	---	---	---	---	---	---	---	---	---	---	---	---	---	---	---
1986	4	---	---	---	---	---	---	---	---	---	---	---	---	---	---	---
1987	1	---	---	---	---	---	---	---	---	---	---	---	---	---	---	---
1987	2	---	---	---	---	---	---	---	---	---	---	---	---	---	---	---
1987	3	7.91	1050	139	1.7	195	6.3	3.6	0.5	ND	ND	0.4	2.7	ND	0.82	ND
1987	4	---	---	---	---	---	---	---	---	---	---	---	---	---	---	---
1988	1	---	---	---	---	---	---	---	---	---	---	---	---	---	---	---
1988	2	---	---	---	---	---	---	---	---	---	---	---	---	---	---	---
1988	3	---	---	---	---	---	---	---	---	---	---	---	---	---	---	---

NOTES : WHERE STATE STANDARDS EXIST, THEY ARE SHOWN IN PARENTHESES IMMEDIATELY BELOW THE CHEMICAL NAME.

ND = NOT DETECTED ; BDL = BELOW DETECTION LIMITS ; --- = NOT TESTED.

SPARTON TECHNOLOGY, INC.
COORS ROAD FACILITY
GROUNDWATER MONITORING RESULTS
PART 1 of 3

[----- mg/l -----]																
YEAR	QUARTER NO.	pH units (6-9)	SPECIFIC CONDUCTANCE umhos/cm	CHLORIDE (250)	NITRATE + NITRITE AS N (10.0)	SULFATE (600)	TOTAL ORGANIC CARBON	TOTAL ORGANIC HALOGEN as Cl	TOTAL KJELDAHL NITROGEN as N	HEXA- VALENT CHROMIUM	TRI- VALENT CHROMIUM	AMMONIA NITROGEN as N	BORON	TOTAL CHROMIUM (0.05)	MANGANESE (0.2)	NICKEL
***** WELL NO. 13 (UPPER FLOW ZONE) *****																
1983	4	---	---	---	---	---	---	---	---	---	---	---	---	---	---	---
1984	4	7.43	1090	---	0.6	148	5.2	3.6	3.1	ND	---	---	2.6	---	2	0.04
1985	1	---	---	---	---	---	---	---	---	---	---	---	---	---	---	---
1985	2	---	---	---	---	---	---	---	---	---	---	---	---	---	---	---
1985	3	---	---	---	---	---	---	---	---	---	---	---	---	---	---	---
1985	4	---	---	---	---	---	---	---	---	---	---	---	---	---	---	---
1986	1	---	---	---	---	---	---	---	---	---	---	---	---	---	---	---
1986	2	---	---	---	---	---	---	---	---	---	---	---	---	---	---	---
1986	3	---	---	---	---	---	---	---	---	---	---	---	---	---	---	---
1986	4	---	---	---	---	---	---	---	---	---	---	---	---	---	---	---
1987	1	---	---	---	---	---	---	---	---	---	---	---	---	---	---	---
1987	2	---	---	---	---	---	---	---	---	---	---	---	---	---	---	---
1987	3	7.73	955	35	4.1	128	3.7	0.79	ND	ND	ND	ND	0.8	ND	0.37	ND
1987	4	---	---	---	---	---	---	---	---	---	---	---	---	---	---	---
1988	1	---	---	---	---	---	---	---	---	---	---	---	---	---	---	---
1988	2	---	---	---	---	---	---	---	---	---	---	---	---	---	---	---
1988	3	---	---	---	---	---	---	---	---	---	---	---	---	---	---	---

NOTES : WHERE STATE STANDARDS EXIST, THEY ARE SHOWN IN PARENTHESES IMMEDIATELY BELOW THE CHEMICAL NAME.

ND = NOT DETECTED ; EDL = BELOW DETECTION LIMITS ; --- = NOT TESTED.

SPARTON TECHNOLOGY, INC.
COORS ROAD FACILITY
GROUNDWATER MONITORING RESULTS
PART 1 of 3

[----- mg/l -----]

YEAR	QUARTER NO.	pH units (6-9)	SPECIFIC CONDUCTANCE umhos/cm	CHLORIDE (250)	NITRATE + NITRITE AS N (10.0)	SULFATE (600)	TOTAL ORGANIC CARBON	TOTAL ORGANIC HALOGEN as Cl	TOTAL KJELDAHL NITROGEN as N	HEXA- VALENT CHROMIUM	TRI- VALENT CHROMIUM	AMMONIA NITROGEN as N	BORON	TOTAL CHROMIUM (0.05)	MANGANESE (0.2)	NICKEL
-----	-----	-----	-----	-----	-----	-----	-----	-----	-----	-----	-----	-----	-----	-----	-----	-----
***** WELL NO. 14 (UPPER FLOW ZONE) *****																
1983	4	---	---	---	---	---	---	---	---	---	---	---	---	---	---	---
1984	4	7.61	1290	---	1	192	5.9	3.7	1	0.6	---	---	2	---	0.76	0.04
1985	1	---	---	---	---	---	---	---	---	---	---	---	---	---	---	---
1985	2	---	---	---	---	---	---	---	---	---	---	---	---	---	---	---
1985	3	---	---	---	---	---	---	---	---	---	---	---	---	---	---	---
1985	4	---	---	---	---	---	---	---	---	---	---	---	---	---	---	---
1986	1	---	---	---	---	---	---	---	---	---	---	---	---	---	---	---
1986	2	---	---	---	---	---	---	---	---	---	---	---	---	---	---	---
1986	3	---	---	---	---	---	---	---	---	---	---	---	---	---	---	---
1986	4	7.76	1200	34	3.1	175	3.8	2.3	ND	1.1	ND	---	1.8	1.1	---	0.03
1987	1	7.89	1190	---	---	---	2.6	3.5	---	---	---	---	---	---	---	---
1987	2	7.43	995	---	---	---	1.7	0.53	---	---	---	---	---	---	---	---
1987	3	7.58	877	64	2.7	132	2.7	1	0.1	0.41	0.54	ND	0.82	0.95	0.017	ND
1987	4	7.52	991	---	---	---	0.8	1.7	---	---	---	---	---	---	---	---
1988	1	12.17	5000	---	---	---	3.1	2.6	---	---	---	---	---	---	---	---
1988	2	7.40	3030	---	---	---	3.2	3.8	---	---	---	---	---	---	---	---
1988	3	11.9	3410	97	10	66	3.5	3.500	ND	0.70	ND	ND	0.30	0.55	0.014	ND

NOTES : WHERE STATE STANDARDS EXIST, THEY ARE SHOWN IN PARENTHESES IMMEDIATELY BELOW THE CHEMICAL NAME.
ND = NOT DETECTED ; BDL = BELOW DETECTION LIMITS ; --- = NOT TESTED.

OGC-003046

SPARTON TECHNOLOGY, INC.
COORS ROAD FACILITY
GROUNDWATER MONITORING RESULTS
PART 1 of 3

46

[----- mg/l -----]																
QUARTER YEAR	NO.	pH units (6-9)	SPECIFIC CONDUCTANCE umhos/cm	CHLORIDE (250)	NITRATE + NITRITE AS N (10.0)	SULFATE (600)	TOTAL ORGANIC CARBON	TOTAL ORGANIC HALOGEN as Cl	TOTAL KJELDAHL NITROGEN as N	HEXA- VALENT CHROMIUM	TRI- VALENT CHROMIUM	AMMONIA NITROGEN as N	BORON	TOTAL CHROMIUM (0.05)	MANGANESE (0.2)	NICKEL
***** WELL NO. 15 (UPPER FLOW ZONE) *****																
1983	4	---	---	---	---	---	---	---	---	---	---	---	---	---	---	---
1984	4	7.68	885	---	4.4	146	2.7	1.1	0.5	ND	---	---	0.16	---	0.06	ND
1985	1	---	---	---	---	---	---	---	---	---	---	---	---	---	---	---
1985	2	---	---	---	---	---	---	---	---	---	---	---	---	---	---	---
1985	3	---	---	---	---	---	---	---	---	---	---	---	---	---	---	---
1985	4	---	---	---	---	---	---	---	---	---	---	---	---	---	---	---
1986	1	---	---	---	---	---	---	---	---	---	---	---	---	---	---	---
1986	2	---	---	---	---	---	---	---	---	---	---	---	---	---	---	---
1986	3	---	---	---	---	---	---	---	---	---	---	---	---	---	---	---
1986	4	7.99	853	53	5.6	126	1.3	1.1	ND	ND	ND	---	0.13	ND	---	ND
1987	1	8.32	801	---	---	---	1.3	0.42	---	---	---	---	---	---	---	---
1987	2	7.60	764	---	---	---	1.1	0.43	---	---	---	---	---	---	---	---
1987	3	8.01	812	41	4.7	135	2.4	0.49	ND	ND	ND	ND	0.14	ND	ND	ND
1987	4	7.65	790	---	---	---	0.9	0.45	---	---	---	---	---	---	---	---
1988	1	8.20	819	---	---	---	1.1	0.29	---	---	---	---	---	---	---	---
1988	2	7.78	871	---	---	---	2.7	0.28	---	---	---	---	---	---	---	---
1988	3	7.70	827	63	6.2	122	2.5	0.290	ND	ND	ND	ND	0.12	ND	0.034	ND

NOTES : WHERE STATE STANDARDS EXIST, THEY ARE SHOWN IN PARENTHESES IMMEDIATELY BELOW THE CHEMICAL NAME.
ND = NOT DETECTED ; BDL = BELOW DETECTION LIMITS ; --- = NOT TESTED.

SPARTON TECHNOLOGY, INC.
COORS ROAD FACILITY
GROUNDWATER MONITORING RESULTS
PART 1 of 3

[----- mg/l -----]													
QUARTER YEAR NO.	PH units (6-9)	SPECIFIC CONDUCT- TANCE umhos/cm	CHLORIDE (250)	NITRATE + NITRITE AS N (10.0)	TOTAL ORGANIC HALOGEN as Cl	TOTAL KJELDAHL NITROGEN as N	HEXA- VALENT CHROMIUM	TRI- VALENT CHROMIUM	AMMONIA NITROGEN as N	BORON	TOTAL CHROMIUM (0.05)	MANGANESE (0.2)	NICKEL
***** WELL NO. 16 (UPPER FLOW ZONE) *****													
1983 4	---	---	---	---	---	---	---	---	---	---	---	---	---
1984 4	7.17	5300	---	ND	15	310	ND	---	---	14	---	17	0.4
1985 1	---	---	---	---	---	---	---	---	---	---	---	---	---
1985 2	---	---	---	---	---	---	---	---	---	---	---	---	---
1985 3	---	---	---	---	---	---	---	---	---	---	---	---	---
1985 4	---	---	---	---	---	---	---	---	---	---	---	---	---
1986 1	---	---	---	---	---	---	---	---	---	---	---	---	---
1986 2	---	---	---	---	---	---	---	---	---	---	---	---	---
1986 3	7.30	2930	---	---	23.3	---	---	---	---	---	---	---	---
1986 4	7.02	4920	364	1.4	29.3	390	ND	ND	---	18	0.017	---	0.35
1987 1	7.61	4530	---	---	31	---	---	---	---	---	---	---	---
1987 2	7.15	4040	---	---	14	---	---	---	---	---	---	---	---
1987 3	7.24	3330	231	3.5	14	250	ND	ND	230	12	ND	4.1	0.25
1987 4	7.27	3700	---	---	17	25	---	---	---	---	---	---	---
1988 1	7.52	3800	---	---	10	15	---	---	---	---	---	---	---
1988 2	7.70	611	---	---	13	27	---	---	---	---	---	---	---
1988 3	7.30	2510	239	6.6	192	29.000	ND	0.04	90	9.1	0.04	1.6	0.23

NOTES : WHERE STATE STANDARDS EXIST, THEY ARE SHOWN IN PARENTHESES IMMEDIATELY BELOW THE CHEMICAL NAME.
ND = NOT DETECTED ; EDL = BELOW DETECTION LIMITS ; --- = NOT TESTED.

SPARTON TECHNOLOGY, INC.
COORS ROAD FACILITY
GROUNDWATER MONITORING RESULTS
PART 1 of 3

[----- mg/l -----]																
QUARTER YEAR	NO.	pH units (6-9)	SPECIFIC CONDUCT- TANCE umhos/cm	CHLORIDE (250)	NITRATE + NITRITE AS N (10.0)	SULFATE (600)	TOTAL ORGANIC CARBON	TOTAL ORGANIC HALOGEN as Cl	TOTAL KJELDAHL NITROGEN as N	HEXA- VALENT CHROMIUM	TRI- VALENT CHROMIUM	AMMONIA NITROGEN as N	BORON	TOTAL CHROMIUM (0.05)	MANGANESE (0.2)	NICKEL
***** WELL NO. 17 (UPPER FLOW ZONE) *****																
1983	4	---	---	---	---	---	---	---	---	---	---	---	---	---	---	---
1984	4	7.90	695	---	ND	98	5.1	3.1	1.5	ND	---	---	0.19	---	4.1	0.11
1985	1	---	---	---	---	---	---	---	---	---	---	---	---	---	---	---
1985	2	---	---	---	---	---	---	---	---	---	---	---	---	---	---	---
1985	3	---	---	---	---	---	---	---	---	---	---	---	---	---	---	---
1985	4	---	---	---	---	---	---	---	---	---	---	---	---	---	---	---
1986	1	---	---	---	---	---	---	---	---	---	---	---	---	---	---	---
1986	2	---	---	---	---	---	---	---	---	---	---	---	---	---	---	---
1986	3	---	---	---	---	---	---	---	---	---	---	---	---	---	---	---
1986	4	---	---	---	---	---	---	---	---	---	---	---	---	---	---	---
1987	1	---	---	---	---	---	---	---	---	---	---	---	---	---	---	---
1987	2	---	---	---	---	---	---	---	---	---	---	---	---	---	---	---
1987	3	7.37	743	32	2.7	116	4.7	2.9	0.8	ND	0.32	0.2	0.12	0.32	2.8	0.13
1987	4	---	---	---	---	---	---	---	---	---	---	---	---	---	---	---
1988	1	---	---	---	---	---	---	---	---	---	---	---	---	---	---	---
1988	2	---	---	---	---	---	---	---	---	---	---	---	---	---	---	---
1988	3	---	---	---	---	---	---	---	---	---	---	---	---	---	---	---

NOTES : WHERE STATE STANDARDS EXIST, THEY ARE SHOWN IN PARENTHESES IMMEDIATELY BELOW THE CHEMICAL NAME.

ND = NOT DETECTED ; BDL = BELOW DETECTION LIMITS ; --- = NOT TESTED.

OGC-003049

SPARTON TECHNOLOGY, INC.
COORS ROAD FACILITY
GROUNDWATER MONITORING RESULTS
PART 1 of 3

49

[----- mg/l -----]																
YEAR	QUARTER NO.	pH units (6-9)	SPECIFIC CONDUCT- TANCE umhos/cm	CHLORIDE (250)	NITRATE + NITRITE AS N (10.0)	SULFATE (600)	TOTAL ORGANIC CARBON	TOTAL ORGANIC HALOGEN as Cl	TOTAL KJELDAHL NITROGEN as N	HEXA- VALENT CHROMIUM	TRI- VALENT CHROMIUM	AMMONIA NITROGEN as N	BORON	TOTAL CHROMIUM (0.05)	MANGANESE (0.2)	NICKEL
***** WELL NO. 18 (UPPER FLOW ZONE) *****																
1983	4	---	---	---	---	---	---	---	---	---	---	---	---	---	---	---
1984	4	---	---	---	---	---	---	---	---	---	---	---	---	---	---	---
1985	1	---	---	---	---	---	---	---	---	---	---	---	---	---	---	---
1985	2	---	---	---	---	---	---	---	---	---	---	---	---	---	---	---
1985	3	---	---	---	---	---	---	---	---	---	---	---	---	---	---	---
1985	4	---	---	---	---	---	---	---	---	---	---	---	---	---	---	---
1986	1	---	---	---	---	---	---	---	---	---	---	---	---	---	---	---
1986	2	---	---	---	---	---	---	---	---	---	---	---	---	---	---	---
1986	3	7.54	760	---	---	---	6.2	4.9	---	---	---	---	---	---	---	---
1986	4	7.25	782	31	2.7	129	0.5	6.02	ND	ND	ND	---	0.13	ND	---	ND
1987	1	8.24	793	---	---	---	2.4	4.4	---	---	---	---	---	---	---	---
1987	2	7.36	798	---	---	---	1.1	1.8	---	---	---	---	---	---	---	---
1987	3	7.37	797	33	2.6	108	50	1.9	0.4	ND	0.01	ND	0.15	ND	ND	ND
1987	4	7.50	740	---	---	---	2.1	3.2	---	---	---	---	---	---	---	---
1988	1	7.55	739	---	---	---	0.8	2.4	---	---	---	---	---	---	---	---
1988	2	12.03	7440	---	---	---	2.7	3.6	---	---	---	---	---	---	---	---
1988	3	7.50	774	31	3.1	122	3.4	3.78	ND	ND	ND	ND	0.12	ND	0.009	ND

NOTES : WHERE STATE STANDARDS EXIST, THEY ARE SHOWN IN PARENTHESES IMMEDIATELY BELOW THE CHEMICAL NAME.
ND = NOT DETECTED ; BDL = BELOW DETECTION LIMITS ; --- = NOT TESTED.

SPARTON TECHNOLOGY, INC.
COORS ROAD FACILITY
GROUNDWATER MONITORING RESULTS
PART 1 of 3

[----- mg/l -----]															
QUARTER		pH	SPECIFIC		NITRATE +		TOTAL	TOTAL							
YEAR	NO.	units	CONDUCTANCE	CHLORIDE	NITRITE AS N	SULFATE	ORGANIC CARBON	ORGANIC HALOGEN	KJELDAHL NITROGEN	HEXA-VALENT CHROMIUM	TRI-VALENT CHROMIUM	AMMONIA NITROGEN	BORON	TOTAL CHROMIUM	MANGANESE
		(6-9)	umhos/cm	(250)	(10.0)	(600)		as Cl	as N			as N		(0.05)	(0.2)
															NICKEL
***** WELL NO. 19 (LOWER FLOW ZONE) *****															
1983	4	---	---	---	---	---	---	---	---	---	---	---	---	---	---
1984	4	---	---	---	---	---	---	---	---	---	---	---	---	---	---
1985	1	---	---	---	---	---	---	---	---	---	---	---	---	---	---
1985	2	---	---	---	---	---	---	---	---	---	---	---	---	---	---
1985	3	---	---	---	---	---	---	---	---	---	---	---	---	---	---
1985	4	---	---	---	---	---	---	---	---	---	---	---	---	---	---
1986	1	---	---	---	---	---	---	---	---	---	---	---	---	---	---
1986	2	---	---	---	---	---	---	---	---	---	---	---	---	---	---
1986	3	---	---	---	---	---	---	---	---	---	---	---	---	---	---
1986	4	7.20	934	58	2.2	145	1.1	3.4	ND	ND	0.043	---	0.3	0.043	0.01
1987	1	8.18	915	---	---	---	1.7	2.6	---	---	---	---	---	---	---
1987	2	7.40	884	---	---	---	1.2	1.1	---	---	---	---	---	---	---
1987	3	7.45	842	54	0.9	110	1.9	2.7	0.2	0.02	0.01	ND	0.33	0.03	0.11
1987	4	7.48	870	---	---	---	2	2.7	---	---	---	---	---	---	---
1988	1	7.56	946	---	---	---	1	1.6	---	---	---	---	---	---	---
1988	2	7.71	902	---	---	---	1.7	2.7	---	---	---	---	---	---	---
1988	3	7.50	869	65	1.1	131	3.4	3.830	0.4	0.02	ND	ND	0.33	0.02	0.11
															ND

NOTES : WHERE STATE STANDARDS EXIST, THEY ARE SHOWN IN PARENTHESES IMMEDIATELY BELOW THE CHEMICAL NAME.

ND = NOT DETECTED ; BDL = BELOW DETECTION LIMITS ; --- = NOT TESTED.

OGC-003051

SPARTON TECHNOLOGY, INC.
COORS ROAD FACILITY
GROUNDWATER MONITORING RESULTS
PART 1 of 3

[----- mg/l -----]																
QUARTER	pH	SPECIFIC	NITRATE +			TOTAL	TOTAL			AMMONIA		TOTAL				
YEAR	NO.	units	CONDUCTANCE	CHLORIDE	NITRITE	SULFATE	ORGANIC	ORGANIC	KJELDAHL	HEXA-VALENT	TRI-VALENT	CHROMIUM	CHROMIUM	MANGANESE	NICKEL	
		(6-9)	umhos/cm	(250)	AS N (10.0)	(600)	CARBON	as Cl	as N	CHROMIUM	CHROMIUM	as N	BORON	(0.05)	(0.2)	
***** WELL NO. 20 (LOWER FLOW ZONE) *****																
1983	4	---	---	---	---	---	---	---	---	---	---	---	---	---	---	---
1984	4	---	---	---	---	---	---	---	---	---	---	---	---	---	---	---
1985	1	---	---	---	---	---	---	---	---	---	---	---	---	---	---	---
1985	2	---	---	---	---	---	---	---	---	---	---	---	---	---	---	---
1985	3	---	---	---	---	---	---	---	---	---	---	---	---	---	---	---
1985	4	---	---	---	---	---	---	---	---	---	---	---	---	---	---	---
1986	1	---	---	---	---	---	---	---	---	---	---	---	---	---	---	---
1986	2	---	---	---	---	---	---	---	---	---	---	---	---	---	---	---
1986	3	---	---	---	---	---	---	---	---	---	---	---	---	---	---	---
1986	4	7.48	804	30	0.3	144	1.3	0.19	ND	ND	ND	---	0.15	ND	---	ND
1987	1	8.33	789	---	---	---	2.7	0.02	---	---	---	---	---	---	---	---
1987	2	7.63	770	---	---	---	1.5	0.43	---	---	---	---	---	---	---	---
1987	3	7.76	687	27	0.5	11	1.8	0.04	0.1	ND	ND	ND	0.16	ND	0.35	ND
1987	4	7.74	720	---	---	---	1.9	ND	---	---	---	---	---	---	---	---
1988	1	7.77	784	---	---	---	1.1	0.02	---	---	---	---	---	---	---	---
1988	2	7.76	753	---	---	---	1.5	0.023	---	---	---	---	---	---	---	---
1988	3	7.70	704	24	0.4	116	2.6	0.026	ND	ND	ND	ND	0.13	ND	0.31	ND

NOTES : WHERE STATE STANDARDS EXIST, THEY ARE SHOWN IN PARENTHESES IMMEDIATELY BELOW THE CHEMICAL NAME.
ND = NOT DETECTED ; EDL = BELOW DETECTION LIMITS ; --- = NOT TESTED.

OGC-003052

SPARTON TECHNOLOGY, INC.
COORS ROAD FACILITY
GROUNDWATER MONITORING RESULTS
PART 1 of 3

02

[----- mg/l -----]																
QUARTER		pH	SPECIFIC	NITRATE +			TOTAL	TOTAL	TOTAL	HEXA-	TRI-	AMMONIA	TOTAL			
YEAR	NO.	units	CONDUCTANCE	CHLORIDE	NITRITE	SULFATE	ORGANIC	ORGANIC	KJELDAHL	VALENT	VALENT	NITROGEN	BORON	CHROMIUM	MANGANESE	
		(6-9)	umhos/cm	(250)	AS N	(600)	CARBON	as Cl	as N	CHROMIUM	CHROMIUM	as N		(0.05)	(0.2)	
					(10.0)										NICKEL	
***** WELL NO. 21 (UPPER FLOW ZONE) *****																
1983	4	---	---	---	---	---	---	---	---	---	---	---	---	---	---	
1984	4	---	---	---	---	---	---	---	---	---	---	---	---	---	---	
1985	1	---	---	---	---	---	---	---	---	---	---	---	---	---	---	
1985	2	---	---	---	---	---	---	---	---	---	---	---	---	---	---	
1985	3	---	---	---	---	---	---	---	---	---	---	---	---	---	---	
1985	4	---	---	---	---	---	---	---	---	---	---	---	---	---	---	
1986	1	---	---	---	---	---	---	---	---	---	---	---	---	---	---	
1986	2	---	---	---	---	---	---	---	---	---	---	---	---	---	---	
1986	3	---	---	---	---	---	---	---	---	---	---	---	---	---	---	
1986	4	7.26	796	30	2.2	141	1	3.5	ND	ND	ND	---	0.12	0.006	---	ND
1987	1	8.05	753	---	---	---	1.1	1.8	---	---	---	---	---	---	---	---
1987	2	7.56	744	---	---	---	0.9	1.4	---	---	---	---	---	---	---	---
1987	3	7.80	746	19	2.8	106	3.2	1.9	ND	ND	ND	0.1	0.14	ND	0.15	ND
1987	4	7.61	753	---	---	---	0.2	1.9	---	---	---	---	---	---	---	---
1988	1	7.67	729	---	---	---	0.9	1.4	---	---	---	---	---	---	---	---
1988	2	7.65	749	---	---	---	0.7	1.3	---	---	---	---	---	---	---	---
1988	3	7.60	666	22	2.6	110	2.1	0.910	ND	ND	ND	ND	0.12	ND	0.14	ND

NOTES : WHERE STATE STANDARDS EXIST, THEY ARE SHOWN IN PARENTHESES IMMEDIATELY BELOW THE CHEMICAL NAME.

ND = NOT DETECTED ; EDL = BELOW DETECTION LIMITS ; --- = NOT TESTED.

SPARTON TECHNOLOGY, INC.
COORS ROAD FACILITY
GROUNDWATER MONITORING RESULTS
PART 1 of 3

[----- mg/l -----]

YEAR	QUARTER NO.	pH units (6-9)	SPECIFIC CONDUCTANCE umhos/cm	CHLORIDE (250)	NITRATE + NITRITE AS N (10.0)	SULFATE (600)	TOTAL ORGANIC CARBON	TOTAL ORGANIC HALOGEN as Cl	TOTAL KJELDAHL NITROGEN as N	HEXA- VALENT CHROMIUM	TRI- VALENT CHROMIUM	AMMONIA NITROGEN as N	BORON	TOTAL CHROMIUM (0.05)	MANGANESE (0.2)	NICKEL
1983	4	---	---	---	---	---	---	---	---	---	---	---	---	---	---	---
1984	4	---	---	---	---	---	---	---	---	---	---	---	---	---	---	---
1985	1	---	---	---	---	---	---	---	---	---	---	---	---	---	---	---
1985	2	---	---	---	---	---	---	---	---	---	---	---	---	---	---	---
1985	3	---	---	---	---	---	---	---	---	---	---	---	---	---	---	---
1985	4	---	---	---	---	---	---	---	---	---	---	---	---	---	---	---
1986	1	---	---	---	---	---	---	---	---	---	---	---	---	---	---	---
1986	2	---	---	---	---	---	---	---	---	---	---	---	---	---	---	---
1986	3	---	---	---	---	---	---	---	---	---	---	---	---	---	---	---
1986	4	7.79	741	30	2.1	114	1.6	0.773	0.1	ND	ND	---	0.17	ND	---	0.01
1987	1	8.26	743	---	---	---	2.6	0.68	---	---	---	---	---	---	---	---
1987	2	7.71	736	---	---	---	1	0.44	---	---	---	---	---	---	---	---
1987	3	7.69	678	31	2.4	89	3	0.22	0.2	ND	ND	ND	0.16	ND	0.2	ND
1987	4	7.75	718	---	---	---	1.2	0.37	---	---	---	---	---	---	---	---
1988	1	7.83	783	---	---	---	0.9	0.43	---	---	---	---	---	---	---	---
1988	2	7.65	750	---	---	---	1.3	0.36	---	---	---	---	---	---	---	---
1988	3	7.70	702	30	2.9	96	1.7	0.310	0.3	ND	0.04	ND	0.33	0.04	1.9	0.08

NOTES : WHERE STATE STANDARDS EXIST, THEY ARE SHOWN IN PARENTHESES IMMEDIATELY BELOW THE CHEMICAL NAME.

ND = NOT DETECTED ; BDL = BELOW DETECTION LIMITS ; --- = NOT TESTED.

OGC-003054

SPARTON TECHNOLOGY, INC.
COORS ROAD FACILITY
GROUNDWATER MONITORING RESULTS
PART 1 of 3

[----- mg/l -----]															
QUARTER		pH	SPECIFIC	NITRATE +		TOTAL	TOTAL	TOTAL	HEXA-	TRI-	AMMONIA		TOTAL	MANGANESE	
YEAR	NO.	units	CONDUCTANCE	CHLORIDE	NITRITE	SULFATE	ORGANIC	ORGANIC	VALENT	VALENT	NITROGEN		CHROMIUM	(0.2)	NICKEL
		(6-9)	umhos/cm	(250)	(10.0)	(600)	CARBON	as Cl	as N	CHROMIUM	CHROMIUM	as N	BORON	(0.05)	
***** WELL NO. 23 (UPPER FLOW ZONE) *****															
1983	4	---	---	---	---	---	---	---	---	---	---	---	---	---	---
1984	4	---	---	---	---	---	---	---	---	---	---	---	---	---	---
1985	1	---	---	---	---	---	---	---	---	---	---	---	---	---	---
1985	2	---	---	---	---	---	---	---	---	---	---	---	---	---	---
1985	3	---	---	---	---	---	---	---	---	---	---	---	---	---	---
1985	4	---	---	---	---	---	---	---	---	---	---	---	---	---	---
1986	1	---	---	---	---	---	---	---	---	---	---	---	---	---	---
1986	2	---	---	---	---	---	---	---	---	---	---	---	---	---	---
1986	3	---	---	---	---	---	---	---	---	---	---	---	---	---	---
1986	4	6.96	1030	56	2.8	132	1.3	9.3	0.2	0.07	ND	---	0.65	0.072	0.03
1987	1	7.92	994	---	---	---	11	3.6	---	---	---	---	---	---	---
1987	2	7.45	860	---	---	---	1	4.2	---	---	---	---	---	---	---
1987	3	7.53	792	40	2.8	98	2.1	0.74	0.4	ND	ND	0.2	0.58	0.02	0.015
1987	4	7.42	1440	---	---	---	4.9	12	---	---	---	---	---	---	---
1988	1	7.39	1480	---	---	---	2	9.8	---	---	---	---	---	---	---
1988	2	7.37	1220	---	---	---	2.7	4.03	---	---	---	---	---	---	---
1988	3	7.60	1080	110	2.6	115	6.7	8.420	0.5	0.06	0.55	ND	1.5	0.61	0.097

NOTES : WHERE STATE STANDARDS EXIST, THEY ARE SHOWN IN PARENTHESES IMMEDIATELY BELOW THE CHEMICAL NAME.
ND = NOT DETECTED ; BDL = BELOW DETECTION LIMITS ; --- = NOT TESTED.

SPARTON TECHNOLOGY, INC.
COORS ROAD FACILITY
GROUNDWATER MONITORING RESULTS
PART 2 of 3

[----- mg/l -----]																			
QUARTER		Acrolein	Acrylo-		Bis-		Carbon		Chloro-		2-Chloro-		Dichloro-	Di-	1,1-Di-	1,2-Di-	1,1-Di-	1,2-Di-	1,3-Di-
YEAR	NO.	nitrile	nitrile	Benzene	(chloro- methyl) ether	Bromo- form	tetra- chloride (0.01)	Chloro- benzene	dibromo methane	chloro- ethane	ethyl- vinyl- ether	Chloro- form (0.1)	bromo- methane	chloro- difluoro- methane	chloro- ethane (0.025)	chloro- ethane (0.01)	chloro- ethylene (0.005)	chloro propane	chloro- propylene
***** WELL NO. 05 (UPPER FLOW ZONE) *****																			
1983	4	ND	ND	ND	ND	ND	ND	ND	ND	ND	ND	ND	ND	ND	0.007	ND	0.018	ND	ND
1984	4	ND	ND	ND	ND	ND	ND	ND	ND	ND	ND	ND	ND	ND	ND	ND	0.007	ND	ND
1985	1	---	---	---	---	---	---	---	---	---	---	---	---	---	---	---	---	---	---
1985	2	---	---	---	---	---	---	---	---	---	---	---	---	---	---	---	---	---	---
1985	3	---	---	---	---	---	---	---	---	---	---	---	---	---	---	---	---	---	---
1985	4	---	---	---	---	---	---	---	---	---	---	---	---	---	---	---	---	---	---
1986	1	---	---	---	---	---	---	---	---	---	---	---	---	---	---	---	---	---	---
1986	2	---	---	---	---	---	---	---	---	---	---	---	---	---	---	---	---	---	---
1986	3	---	---	---	---	---	---	---	---	---	---	---	---	---	---	---	---	---	---
1986	4	---	---	---	---	---	---	---	---	---	---	---	---	---	---	---	---	---	---
1987	1	---	---	---	---	---	---	---	---	---	---	---	---	---	---	---	---	---	---
1987	2	---	---	---	---	---	---	---	---	---	---	---	---	---	---	---	---	---	---
1987	3	---	---	ND	---	ND	ND	ND	ND	ND	ND	ND	ND	---	ND	ND	ND	ND	ND
1987	4	---	---	---	---	---	---	---	---	---	---	---	---	---	---	---	---	---	---
1988	1	---	---	---	---	---	---	---	---	---	---	---	---	---	---	---	---	---	---
1988	2	---	---	---	---	---	---	---	---	---	---	---	---	---	---	---	---	---	---
1988	3	---	---	---	---	---	---	---	---	---	---	---	---	---	---	---	---	---	---

NOTES : WHERE STATE STANDARDS EXIST, THEY ARE SHOWN IN PARENTHESES IMMEDIATELY BELOW THE CHEMICAL NAME.
ND = NOT DETECTED ; BDL = BELOW DETECTION LIMITS ; --- = NOT TESTED.

SPARTON TECHNOLOGY, INC.
COORS ROAD FACILITY
GROUNDWATER MONITORING RESULTS
PART 2 of 3

mg/l

QUARTER	Acrolein	Acrylo-	Bis-	Carbon	Chloro-	Chloro-	2-Chloro-	Chloro-	Dichloro-	Di-	1,1-Di-	1,2-Di-	1,1-Di-	1,2-Di-	1,3-Di-
YEAR	NO.	nitrile	(chloro-	tetra-	bromo-	benzene	ethyl-	form	bromo-	chloro-	chloro-	chloro-	chloro-	chloro-	chloro-
			methyl)	chloride	form		vinyl-	(0.1)	methane	methane	(0.025)	(0.01)	ethylene	propane	propylene
			ether	(0.01)			ether						(0.005)		
***** WELL NO. 06 (UPPER FLOW ZONE) *****															
1983	4	ND	ND	ND	ND	ND	ND	ND	ND	ND	ND	ND	ND	ND	ND
1984	4	ND	ND	ND	ND	ND	ND	ND	ND	ND	ND	ND	0.028	ND	ND
1985	1	---	---	---	---	---	---	---	---	---	---	---	---	---	---
1985	2	---	---	---	---	---	---	---	---	---	---	---	---	---	---
1985	3	BDL	BDL	BDL	BDL	BDL	BDL	BDL	BDL	BDL	BDL	BDL	0.027	BDL	BDL
1985	4	---	---	---	---	---	---	---	---	---	---	---	---	---	---
1986	1	---	---	---	---	---	---	---	---	---	---	---	0.035	---	---
1986	2	---	---	---	---	---	---	---	---	---	---	---	0.014	---	---
1986	3	---	---	---	---	---	---	---	---	---	---	---	0.046	---	---
1986	4	BDL	BDL	BDL	---	BDL	BDL	BDL	BDL	BDL	BDL	---	0.033	BDL	BDL
1987	1	---	---	---	---	---	---	---	---	---	---	---	0.027	---	---
1987	2	---	---	---	---	---	---	---	---	---	---	---	0.028	---	---
1987	3	---	---	ND	---	ND	ND	ND	ND	ND	ND	---	0.04	ND	ND
1987	4	---	---	---	---	---	---	---	---	---	---	---	0.04	---	---
1988	1	---	---	---	---	---	---	---	---	---	---	---	0.021	---	---
1988	2	---	---	---	---	---	---	---	---	---	---	---	0.011	---	---
1988	3	---	---	ND	---	ND	ND	ND	ND	ND	ND	---	0.0079	ND	ND

NOTES : WHERE STATE STANDARDS EXIST, THEY ARE SHOWN IN PARENTHESES IMMEDIATELY BELOW THE CHEMICAL NAME.

ND = NOT DETECTED ; BDL = BELOW DETECTION LIMITS ; --- = NOT TESTED.

SPARTON TECHNOLOGY, INC.
COORS ROAD FACILITY
GROUNDWATER MONITORING RESULTS
PART 2 of 3

7

QUARTER		Acrolein	Acrylo- nitrile	Benzene	Bis- (chloro- methyl) ether	Bromo- form	Carbon tetra- chloride (0.01)	Chloro- benzene	Chloro- dibromo methane	Chloro- ethane	2-Chloro- ethyl- vinyl- ether	Chloro- form (0.1)	Dichloro- bromo- methane	Di- chloro- difluoro- methane	1,1-Di- chloro- ethane (0.025)	1,2-Di- chloro- ethane (0.01)	1,1-Di- chloro- ethylene (0.005)	1,2-Di- chloro propane	1,3-Di- chloro- propylene
YEAR	NO.	-----	-----	-----	-----	-----	-----	-----	-----	-----	-----	-----	-----	-----	-----	-----	-----	-----	-----
***** WELL NO. 07 (UPPER FLOW ZONE) *****																			
1983	4	ND	ND	ND	ND	ND	ND	ND	ND	ND	ND	ND	ND	ND	ND	ND	0.017	ND	ND
1984	4	ND	ND	ND	ND	ND	ND	ND	ND	ND	ND	ND	ND	ND	ND	ND	0.11	ND	ND
1985	1	---	---	---	---	---	---	---	---	---	---	---	---	---	---	---	---	---	---
1985	2	---	---	---	---	---	---	---	---	---	---	---	---	---	---	---	---	---	---
1985	3	---	---	---	---	---	---	---	---	---	---	---	---	---	---	---	---	---	---
1985	4	---	---	---	---	---	---	---	---	---	---	---	---	---	---	---	---	---	---
1986	1	---	---	---	---	---	---	---	---	---	---	---	---	---	---	---	---	---	---
1986	2	---	---	---	---	---	---	---	---	---	---	---	---	---	---	---	---	---	---
1986	3	---	---	---	---	---	---	---	---	---	---	---	---	---	---	---	---	---	---
1986	4	---	---	---	---	---	---	---	---	---	---	---	---	---	---	---	---	---	---
1987	1	---	---	---	---	---	---	---	---	---	---	---	---	---	---	---	---	---	---
1987	2	---	---	---	---	---	---	---	---	---	---	---	---	---	---	---	---	---	---
1987	3	---	---	ND	---	ND	ND	ND	ND	ND	ND	ND	ND	---	ND	ND	0.034	ND	ND
1987	4	---	---	---	---	---	---	---	---	---	---	---	---	---	---	---	---	---	---
1988	1	---	---	---	---	---	---	---	---	---	---	---	---	---	---	---	---	---	---
1988	2	---	---	---	---	---	---	---	---	---	---	---	---	---	---	---	---	---	---
1988	3	---	---	---	---	---	---	---	---	---	---	---	---	---	---	---	---	---	---

NOTES : WHERE STATE STANDARDS EXIST, THEY ARE SHOWN IN PARENTHESES IMMEDIATELY BELOW THE CHEMICAL NAME.
ND = NOT DETECTED ; BDL = BELOW DETECTION LIMITS ; --- = NOT TESTED.

OGC-003058

SPARTON TECHNOLOGY, INC.
COORS ROAD FACILITY
GROUNDWATER MONITORING RESULTS
PART 2 of 3

mg/l

YEAR	QUARTER NO.	Acrolein	Acrylonitrile	Benzene	Bis-(chloromethyl) ether	Bromoform	Carbon tetrachloride (0.01)	Chlorobenzene	Chlorodibromomethane	Chloroethane	2-Chloroethylvinyl ether	Chloroform (0.1)	Dichlorobromomethane	Di-chlorodifluoromethane	1,1-Dichloroethane (0.025)	1,2-Dichloroethane (0.01)	1,1-Dichloroethylene (0.005)	1,2-Dichloropropane	1,3-Dichloropropylene
***** WELL NO. 08 (UPPER FLOW ZONE) *****																			
1983	4	ND	ND	ND	ND	ND	ND	ND	ND	ND	ND	ND	ND	ND	ND	ND	ND	ND	ND
1984	4	ND	ND	ND	ND	ND	ND	ND	ND	ND	ND	ND	ND	ND	ND	ND	22	ND	ND
1985	1	---	---	---	---	---	---	---	---	---	---	---	---	---	---	---	---	---	---
1985	2	---	---	---	---	---	---	---	---	---	---	---	---	---	---	---	---	---	---
1985	3	BDL	BDL	EDL	EDL	BDL	BDL	BDL	BDL	BDL	BDL	BDL	BDL	BDL	BDL	BDL	0.013	BDL	BDL
1985	4	---	---	---	---	---	---	---	---	---	---	---	---	---	---	---	---	---	---
1986	1	---	---	---	---	---	---	---	---	---	---	---	---	---	---	---	0.0084	---	---
1986	2	---	---	---	---	---	---	---	---	---	---	---	---	---	---	---	0.013	---	---
1986	3	---	---	---	---	---	---	---	---	---	---	---	---	---	---	---	0.01	---	---
1986	4	BDL	BDL	BDL	---	BDL	BDL	BDL	BDL	BDL	BDL	BDL	BDL	---	BDL	BDL	0.009	BDL	BDL
1987	1	---	---	---	---	---	---	---	---	---	---	---	---	---	---	---	0.002	---	---
1987	2	---	---	---	---	---	---	---	---	---	---	---	---	---	---	---	0.0042	---	---
1987	3	---	---	ND	---	ND	ND	ND	ND	ND	ND	ND	ND	---	ND	ND	ND	ND	ND
1987	4	---	---	---	---	---	---	---	---	---	---	---	---	---	---	---	ND	---	---
1988	1	---	---	---	---	---	---	---	---	---	---	---	---	---	---	---	ND	---	---
1988	2	---	---	---	---	---	---	---	---	---	---	---	---	---	---	---	ND	---	---
1988	3	---	---	ND	---	ND	ND	ND	ND	ND	ND	ND	ND	---	ND	ND	0.011	ND	ND

NOTES : WHERE STATE STANDARDS EXIST, THEY ARE SHOWN IN PARENTHESES IMMEDIATELY BELOW THE CHEMICAL NAME.
ND = NOT DETECTED ; BDL = BELOW DETECTION LIMITS ; --- = NOT TESTED.

SPARTON TECHNOLOGY, INC.
COORS ROAD FACILITY
GROUNDWATER MONITORING RESULTS
PART 2 of 3

mg/l

YEAR	QUARTER NO.	Acrolein	Acrylo- nitrile	Benzene	Bis- (chloro- methyl) ether	Bromo- form	Carbon tetra- chloride (0.01)	Chloro- benzene	Chloro- dibromo methane	Chloro- ethane	2-Chloro- ethyl- vinyl- ether	Chloro- form (0.1)	Dichloro- bromo- methane	Di- chloro- difluoro- methane	1,1-Di- chloro- ethane (0.025)	1,2-Di- chloro- ethane (0.01)	1,1-Di- chloro- ethylene (0.005)	1,2-Di- chloro propane	1,3-Di- chloro- propylene
***** WELL NO. 09 (UPPER FLOW ZONE) *****																			
1983	4	ND	ND	0.02	ND	ND	ND	ND	ND	ND	ND	ND	ND	ND	0.13	ND	2.5	ND	ND
1984	4	ND	ND	0.016	ND	ND	ND	ND	ND	ND	ND	0.057	ND	ND	0.12	ND	1.2	ND	ND
1985	1	---	---	---	---	---	---	---	---	---	---	---	---	---	---	---	---	---	---
1985	2	---	---	---	---	---	---	---	---	---	---	---	---	---	---	---	---	---	---
1985	3	BDL	BDL	0.007	BDL	BDL	BDL	BDL	BDL	BDL	BDL	0.028	BDL	BDL	0.035	BDL	1.3	BDL	BDL
1985	4	---	---	---	---	---	---	---	---	---	---	---	---	---	---	---	---	---	---
1986	1	---	---	---	---	---	---	---	---	---	---	---	---	---	---	---	1.3	---	---
1986	2	---	---	---	---	---	---	---	---	---	---	---	---	---	---	---	1.2	---	---
1986	3	---	---	---	---	---	---	---	---	---	---	---	---	---	---	---	0.74	---	---
1986	4	BDL	BDL	BDL	---	BDL	BDL	BDL	BDL	BDL	BDL	BDL	BDL	---	BDL	BDL	0.4	BDL	BDL
1987	1	---	---	---	---	---	---	---	---	---	---	---	---	---	---	---	0.31	---	---
1987	2	---	---	---	---	---	---	---	---	---	---	---	---	---	---	---	0.260	---	---
1987	3	---	---	ND	---	ND	ND	ND	ND	ND	ND	ND	ND	---	ND	ND	0.60	ND	ND
1987	4	---	---	---	---	---	---	---	---	---	---	---	---	---	---	---	0.59	---	---
1988	1	---	---	---	---	---	---	---	---	---	---	---	---	---	---	---	0.49	---	---
1988	2	---	---	---	---	---	---	---	---	---	---	---	---	---	---	---	0.35	---	---
1988	3	---	---	ND	---	ND	ND	ND	ND	ND	ND	ND	ND	---	ND	ND	0.660	ND	ND

NOTES : WHERE STATE STANDARDS EXIST, THEY ARE SHOWN IN PARENTHESES IMMEDIATELY BELOW THE CHEMICAL NAME.
ND = NOT DETECTED ; BDL = BELOW DETECTION LIMITS ; --- = NOT TESTED.

OGC-003060

SPARTON TECHNOLOGY, INC.
COORS ROAD FACILITY
GROUNDWATER MONITORING RESULTS
PART 2 of 3

060

QUARTER		Acrolein	Acrylo- nitrile	Benzene	Bis- (chloro- methyl) ether	Bromo- form	Carbon tetra- chloride (0.01)	Chloro- benzene	Chloro- dibromo methane	Chloro- ethane	2-Chloro- ethyl- vinyl- ether	Chloro- form (0.1)	Dichloro- bromo- methane	Di- chloro- difluoro- methane	1,1-Di- chloro- ethane (0.025)	1,2-Di- chloro- ethane (0.01)	1,1-Di- chloro- ethylene (0.005)	1,2-Di- chloro propane	1,3-Di- chloro- propylene
YEAR	NO.																		
***** WELL NO. 10 (LOWER FLOW ZONE) *****																			
1983	4	ND	ND	ND	ND	ND	ND	ND	ND	ND	ND	ND	ND	ND	ND	ND	ND	ND	ND
1984	4	ND	ND	ND	ND	ND	ND	ND	ND	ND	ND	ND	ND	ND	ND	ND	ND	ND	ND
1985	1	---	---	---	---	---	---	---	---	---	---	---	---	---	---	---	---	---	---
1985	2	---	---	---	---	---	---	---	---	---	---	---	---	---	---	---	---	---	---
1985	3	BDL	BDL	BDL	BDL	BDL	BDL	BDL	BDL	BDL	BDL	BDL	BDL	BDL	BDL	BDL	0.005	BDL	BDL
1985	4	---	---	---	---	---	---	---	---	---	---	---	---	---	---	---	---	---	---
1986	1	---	---	---	---	---	---	---	---	---	---	---	---	---	---	---	0.007	---	---
1986	2	---	---	---	---	---	---	---	---	---	---	---	---	---	---	---	0.046	---	---
1986	3	---	---	---	---	---	---	---	---	---	---	---	---	---	---	---	0.0093	---	---
1986	4	---	---	---	---	---	---	---	---	---	---	---	---	---	---	---	---	---	---
1987	1	---	---	---	---	---	---	---	---	---	---	---	---	---	---	---	---	---	---
1987	2	---	---	---	---	---	---	---	---	---	---	---	---	---	---	---	---	---	---
1987	3	---	---	ND	---	ND	ND	ND	ND	ND	ND	ND	ND	---	ND	ND	0.19	ND	ND
1987	4	---	---	---	---	---	---	---	---	---	---	---	---	---	---	---	---	---	---
1988	1	---	---	---	---	---	---	---	---	---	---	---	---	---	---	---	---	---	---
1988	2	---	---	---	---	---	---	---	---	---	---	---	---	---	---	---	---	---	---
1988	3	---	---	---	---	---	---	---	---	---	---	---	---	---	---	---	---	---	---

NOTES : WHERE STATE STANDARDS EXIST, THEY ARE SHOWN IN PARENTHESES IMMEDIATELY BELOW THE CHEMICAL NAME.
ND = NOT DETECTED ; BDL = BELOW DETECTION LIMITS ; --- = NOT TESTED.

SPARTON TECHNOLOGY, INC.
COORS ROAD FACILITY
GROUNDWATER MONITORING RESULTS
PART 2 of 3

19061

QUARTER		Acrolein	Acrylo- nitrile	Benzene	Bis- (chloro- methyl) ether	Bromo- form	Carbon tetra- chloride (0.01)	Chloro- benzene	Chloro- dibromo methane	Chloro- ethane	2-Chloro- ethyl- vinyl- ether	Chloro- form (0.1)	Dichloro- bromo- methane	Di- chloro- difluoro- methane	1,1-Di- chloro- ethane (0.025)	1,2-Di- chloro- ethane (0.01)	1,1-Di- chloro- ethylene (0.005)	1,2-Di- chloro propane	1,3-Di- chloro- propylene
YEAR	NO.																		
***** WELL NO. 11 (LOWER FLOW ZONE) *****																			
1983	4	ND	ND	ND	ND	ND	ND	ND	ND	ND	ND	ND	ND	ND	ND	ND	ND	ND	ND
1984	4	ND	ND	ND	ND	ND	ND	ND	ND	ND	ND	ND	ND	ND	ND	ND	ND	ND	ND
1985	1	---	---	---	---	---	---	---	---	---	---	---	---	---	---	---	---	---	---
1985	2	---	---	---	---	---	---	---	---	---	---	---	---	---	---	---	---	---	---
1985	3	BDL	BDL	BDL	BDL	BDL	BDL	BDL	BDL	BDL	BDL	BDL	BDL	BDL	BDL	BDL	BDL	BDL	BDL
1985	4	---	---	---	---	---	---	---	---	---	---	---	---	---	---	---	---	---	---
1986	1	---	---	---	---	---	---	---	---	---	---	---	---	---	---	---	ND	---	---
1986	2	---	---	---	---	---	---	---	---	---	---	---	---	---	---	---	ND	---	---
1986	3	---	---	---	---	---	---	---	---	---	---	---	---	---	---	---	ND	---	---
1986	4	BDL	BDL	BDL	---	BDL	BDL	BDL	BDL	BDL	BDL	BDL	BDL	---	BDL	BDL	BDL	BDL	BDL
1987	1	---	---	---	---	---	---	---	---	---	---	---	---	---	---	---	ND	---	---
1987	2	---	---	---	---	---	---	---	---	---	---	---	---	---	---	---	ND	---	---
1987	3	---	---	ND	---	ND	ND	ND	ND	ND	ND	ND	ND	---	ND	ND	ND	ND	ND
1987	4	---	---	---	---	---	---	---	---	---	---	---	---	---	---	---	ND	---	---
1988	1	---	---	---	---	---	---	---	---	---	---	---	---	---	---	---	ND	---	---
1988	2	---	---	---	---	---	---	---	---	---	---	---	---	---	---	---	ND	---	---
1988	3	---	---	ND	---	ND	ND	ND	ND	ND	ND	ND	ND	---	ND	ND	ND	ND	ND

NOTES : WHERE STATE STANDARDS EXIST, THEY ARE SHOWN IN PARENTHESES IMMEDIATELY BELOW THE CHEMICAL NAME.
ND = NOT DETECTED ; BDL = BELOW DETECTION LIMITS ; --- = NOT TESTED.

OGC-003062

SPARTON TECHNOLOGY, INC.
COORS ROAD FACILITY
GROUNDWATER MONITORING RESULTS
PART 2 of 3

2062

QUARTER		Acrolein	Acrylo-		Bis-		Carbon		Chloro-	Chloro-	2-Chloro-		Dichloro-	Di-	1,1-Di-	1,2-Di-	1,1-Di-	1,2-Di-	1,3-Di-
YEAR	NO.		nitrile	Benzene	(chloro- methyl) ether	Bromo- form	tetra- chloride (0.01)	chloro- benzene	dibromo- methane	ethane	ethyl- vinyl- ether	Chloro- form (0.1)	bromo- methane	chloro- difluoro- methane	chloro- ethane (0.025)	chloro- ethane (0.01)	chloro- ethylene (0.005)	chloro propane	chloro- propylene
***** WELL NO. 12 (UPPER FLOW ZONE) *****																			
1983	4	---	---	---	---	---	---	---	---	---	---	---	---	---	---	---	---	---	---
1984	3	ND	ND	ND	ND	ND	ND	ND	ND	ND	ND	ND	ND	ND	ND	ND	ND	ND	ND
1985	1	---	---	---	---	---	---	---	---	---	---	---	---	---	---	---	---	---	---
1985	2	---	---	---	---	---	---	---	---	---	---	---	---	---	---	---	---	---	---
1985	3	---	---	---	---	---	---	---	---	---	---	---	---	---	---	---	---	---	---
1985	4	---	---	---	---	---	---	---	---	---	---	---	---	---	---	---	---	---	---
1986	1	---	---	---	---	---	---	---	---	---	---	---	---	---	---	---	---	---	---
1986	2	---	---	---	---	---	---	---	---	---	---	---	---	---	---	---	---	---	---
1986	3	---	---	---	---	---	---	---	---	---	---	---	---	---	---	---	---	---	---
1986	4	---	---	---	---	---	---	---	---	---	---	---	---	---	---	---	---	---	---
1987	1	---	---	---	---	---	---	---	---	---	---	---	---	---	---	---	---	---	---
1987	2	---	---	---	---	---	---	---	---	---	---	---	---	---	---	---	---	---	---
1987	3	---	---	ND	---	ND	ND	ND	ND	ND	ND	ND	ND	---	ND	ND	0.38	ND	ND
1987	4	---	---	---	---	---	---	---	---	---	---	---	---	---	---	---	---	---	---
1988	1	---	---	---	---	---	---	---	---	---	---	---	---	---	---	---	---	---	---
1988	2	---	---	---	---	---	---	---	---	---	---	---	---	---	---	---	---	---	---
1988	3	---	---	---	---	---	---	---	---	---	---	---	---	---	---	---	---	---	---

NOTES : WHERE STATE STANDARDS EXIST, THEY ARE SHOWN IN PARENTHESES IMMEDIATELY BELOW THE CHEMICAL NAME.
ND = NOT DETECTED ; BDL = BELOW DETECTION LIMITS ; --- = NOT TESTED.

OGC-003063

SPARTON TECHNOLOGY, INC.
COORS ROAD FACILITY
GROUNDWATER MONITORING RESULTS
PART 2 of 3

63

[----- mg/l -----]																		
QUARTER		Acrolein	Acrylo-		Bis-	Carbon		Chloro-		2-Chloro-		Dichloro-	Di-	1,1-Di-	1,2-Di-	1,1-Di-	1,2-Di-	1,3-Di-
YEAR	NO.	nitrile	Benzene	ether	Bromo-	tetra-	Chloro-	dibromo	Chloro-	ethyl-	Chloro-	bromo-	chloro-	chloro-	chloro-	chloro-	chloro	chloro-
					form	chloride	benzene	methane	ethane	vinyl-	form	methane	methane	ethane	ethane	ethylene	propane	propylene
						(0.01)				ether	(0.1)			(0.025)	(0.01)	(0.005)		
***** WELL NO. 13 (UPPER FLOW ZONE) *****																		
1983	4	---	---	---	---	---	---	---	---	---	---	---	---	---	---	---	---	---
1984	4	ND	ND	ND	ND	ND	ND	ND	ND	ND	0.015	ND	ND	0.013	ND	0.82	ND	ND
1985	1	---	---	---	---	---	---	---	---	---	---	---	---	---	---	---	---	---
1985	2	---	---	---	---	---	---	---	---	---	---	---	---	---	---	---	---	---
1985	3	---	---	---	---	---	---	---	---	---	---	---	---	---	---	---	---	---
1985	4	---	---	---	---	---	---	---	---	---	---	---	---	---	---	---	---	---
1986	1	---	---	---	---	---	---	---	---	---	---	---	---	---	---	---	---	---
1986	2	---	---	---	---	---	---	---	---	---	---	---	---	---	---	---	---	---
1986	3	---	---	---	---	---	---	---	---	---	---	---	---	---	---	---	---	---
1986	4	---	---	---	---	---	---	---	---	---	---	---	---	---	---	---	---	---
1987	1	---	---	---	---	---	---	---	---	---	---	---	---	---	---	---	---	---
1987	2	---	---	---	---	---	---	---	---	---	---	---	---	---	---	---	---	---
1987	3	---	---	ND	---	ND	ND	ND	ND	ND	ND	ND	---	ND	ND	0.12	ND	ND
1987	4	---	---	---	---	---	---	---	---	---	---	---	---	---	---	---	---	---
1988	1	---	---	---	---	---	---	---	---	---	---	---	---	---	---	---	---	---
1988	2	---	---	---	---	---	---	---	---	---	---	---	---	---	---	---	---	---
1988	3	---	---	---	---	---	---	---	---	---	---	---	---	---	---	---	---	---

NOTES : WHERE STATE STANDARDS EXIST, THEY ARE SHOWN IN PARENTHESES IMMEDIATELY BELOW THE CHEMICAL NAME.

ND = NOT DETECTED ; BDL = BELOW DETECTION LIMITS ; --- = NOT TESTED.

OGC-003064

SPARTON TECHNOLOGY, INC.
COORS ROAD FACILITY
GROUNDWATER MONITORING RESULTS
PART 2 of 3

064

QUARTER		Acrolein	Acrylo- nitrile	Benzene	Bis- (chloro- methyl) ether	Bromo- form	Carbon tetra- chloride (0.01)	Chloro- benzene	Chloro- dibromo methane	Chloro- ethane	2-Chloro- ethyl- vinyl- ether	Chloro- form (0.1)	Dichloro- bromo- methane	Di- chloro- difluoro- methane	1,1-Di- chloro- ethane (0.025)	1,2-Di- chloro- ethane (0.01)	1,1-Di- chloro- ethylene (0.005)	1,2-Di- chloro propane	1,3-Di- chloro- propylene
YEAR	NO.																		
***** WELL NO. 14 (UPPER FLOW ZONE) *****																			
1983	4	---	---	---	---	---	---	---	---	---	---	---	---	---	---	---	---	---	---
1984	4	ND	ND	0.009	ND	ND	ND	ND	ND	ND	ND	0.034	ND	ND	0.017	ND	1	ND	ND
1985	1	---	---	---	---	---	---	---	---	---	---	---	---	---	---	---	---	---	---
1985	2	---	---	---	---	---	---	---	---	---	---	---	---	---	---	---	---	---	---
1985	3	---	---	---	---	---	---	---	---	---	---	---	---	---	---	---	---	---	---
1985	4	---	---	---	---	---	---	---	---	---	---	---	---	---	---	---	---	---	---
1986	1	---	---	---	---	---	---	---	---	---	---	---	---	---	---	---	---	---	---
1986	2	---	---	---	---	---	---	---	---	---	---	---	---	---	---	---	---	---	---
1986	3	---	---	---	---	---	---	---	---	---	---	---	---	---	---	---	---	---	---
1986	4	BDL	BDL	BDL	---	BDL	BDL	BDL	BDL	BDL	BDL	BDL	BDL	---	BDL	BDL	0.31	BDL	BDL
1987	1	---	---	---	---	---	---	---	---	---	---	---	---	---	---	---	0.23	---	---
1987	2	---	---	---	---	---	---	---	---	---	---	---	---	---	---	---	0.065	---	---
1987	3	---	---	ND	---	ND	ND	ND	ND	ND	ND	ND	ND	---	ND	ND	ND	ND	ND
1987	4	---	---	---	---	---	---	---	---	---	---	---	---	---	---	---	0.13	---	---
1988	1	---	---	---	---	---	---	---	---	---	---	---	---	---	---	---	ND	---	---
1988	2	---	---	---	---	---	---	---	---	---	---	---	---	---	---	---	ND	---	---
1988	3	---	---	ND	---	ND	ND	ND	ND	ND	ND	ND	ND	---	ND	ND	ND	ND	ND

NOTES : WHERE STATE STANDARDS EXIST, THEY ARE SHOWN IN PARENTHESES IMMEDIATELY BELOW THE CHEMICAL NAME.
ND = NOT DETECTED ; BDL = BELOW DETECTION LIMITS ; --- = NOT TESTED.

OGC-003065

SPARTON TECHNOLOGY, INC.
COORS ROAD FACILITY
GROUNDWATER MONITORING RESULTS
PART 2 of 3

mg/l

YEAR	QUARTER NO.	Acrolein	Acrylonitrile	Benzene	Bis-(chloromethyl) ether	Bromoform	Carbon tetrachloride (0.01)	Chlorobenzene	Chlorodibromomethane	Chloroethane	2-Chloroethylvinyl ether	Chloroform (0.1)	Dichlorobromomethane	Di-chlorodifluoromethane	1,1-Dichloroethane (0.025)	1,2-Dichloroethane (0.01)	1,1-Dichloroethylene (0.005)	1,2-Dichloropropane	1,3-Dichloropropylene
***** WELL NO. 15 (UPPER FLOW ZONE) *****																			
1983	4	---	---	---	---	---	---	---	---	---	---	---	---	---	---	---	---	---	---
1984	4	ND	ND	ND	ND	ND	ND	ND	ND	ND	ND	ND	ND	ND	ND	ND	0.085	ND	ND
1985	1	---	---	---	---	---	---	---	---	---	---	---	---	---	---	---	---	---	---
1985	2	---	---	---	---	---	---	---	---	---	---	---	---	---	---	---	---	---	---
1985	3	---	---	---	---	---	---	---	---	---	---	---	---	---	---	---	---	---	---
1985	4	---	---	---	---	---	---	---	---	---	---	---	---	---	---	---	---	---	---
1986	1	---	---	---	---	---	---	---	---	---	---	---	---	---	---	---	---	---	---
1986	2	---	---	---	---	---	---	---	---	---	---	---	---	---	---	---	---	---	---
1986	3	---	---	---	---	---	---	---	---	---	---	---	---	---	---	---	---	---	---
1986	4	BDL	BDL	BDL	---	BDL	BDL	BDL	BDL	BDL	BDL	BDL	BDL	---	BDL	BDL	0.046	BDL	BDL
1987	1	---	---	---	---	---	---	---	---	---	---	---	---	---	---	---	ND	---	---
1987	2	---	---	---	---	---	---	---	---	---	---	---	---	---	---	---	0.021	---	---
1987	3	---	---	ND	---	ND	ND	ND	ND	ND	ND	ND	ND	---	ND	ND	0.03	ND	ND
1987	4	---	---	---	---	---	---	---	---	---	---	---	---	---	---	---	0.028	---	---
1988	1	---	---	---	---	---	---	---	---	---	---	---	---	---	---	---	0.016	---	---
1988	2	---	---	---	---	---	---	---	---	---	---	---	---	---	---	---	ND	---	---
1988	3	---	---	ND	---	ND	ND	ND	ND	ND	ND	ND	ND	---	ND	ND	ND	ND	ND

NOTES : WHERE STATE STANDARDS EXIST, THEY ARE SHOWN IN PARENTHESES IMMEDIATELY BELOW THE CHEMICAL NAME.
ND = NOT DETECTED ; BDL = BELOW DETECTION LIMITS ; --- = NOT TESTED.

SPARTON TECHNOLOGY, INC.
COORS ROAD FACILITY
GROUNDWATER MONITORING RESULTS
PART 2 of 3

QUARTER		Acrolein	Acrylo- nitrile	Benzene	Bis- (chloro- methyl) ether	Bromo- form	Carbon tetra- chloride (0.01)	Chloro- benzene	Chloro- dibromo methane	Chloro- ethane	2-Chloro- ethyl- vinyl- ether	Chloro- form (0.1)	Dichloro- bromo- methane	Di- chloro- difluoro- methane	1,1-Di- chloro- ethane (0.025)	1,2-Di- chloro- ethane (0.01)	1,1-Di- chloro- ethylene (0.005)	1,2-Di- chloro propane	1,3-Di- chloro- propylene
YEAR	NO.																		
***** WELL NO. 16 (UPPER FLOW ZONE) *****																			
1983	4	---	---	---	---	---	---	---	---	---	---	---	---	---	---	---	---	---	---
1984	4	ND	ND	0.058	ND	ND	ND	0.016	ND	0.045	ND	0.025	ND	ND	3.2	ND	3.1	ND	ND
1985	1	---	---	---	---	---	---	---	---	---	---	---	---	---	---	---	---	---	---
1985	2	---	---	---	---	---	---	---	---	---	---	---	---	---	---	---	---	---	---
1985	3	---	---	---	---	---	---	---	---	---	---	---	---	---	---	---	---	---	---
1985	4	---	---	---	---	---	---	---	---	---	---	---	---	---	---	---	---	---	---
1986	1	---	---	---	---	---	---	---	---	---	---	---	---	---	---	---	---	---	---
1986	2	---	---	---	---	---	---	---	---	---	---	---	---	---	---	---	---	---	---
1986	3	---	---	---	---	---	---	---	---	---	---	---	---	---	---	---	2.2	---	---
1986	4	BDL	BDL	BDL	---	BDL	BDL	BDL	BDL	BDL	BDL	BDL	BDL	---	BDL	BDL	3.5	BDL	BDL
1987	1	---	---	---	---	---	---	---	---	---	---	---	---	---	---	---	2.2	---	---
1987	2	---	---	---	---	---	---	---	---	---	---	---	---	---	---	---	1.9	---	---
1987	3	---	---	ND	---	ND	ND	ND	ND	ND	ND	ND	ND	---	ND	ND	2.2	ND	ND
1987	4	---	---	---	---	---	---	---	---	---	---	---	---	---	---	---	1.6	---	---
1988	1	---	---	---	---	---	---	---	---	---	---	---	---	---	---	---	1.4	---	---
1988	2	---	---	---	---	---	---	---	---	---	---	---	---	---	---	---	1.4	---	---
1988	3	---	---	ND	---	ND	ND	ND	ND	ND	ND	ND	ND	---	ND	ND	1.900	ND	ND

NOTES : WHERE STATE STANDARDS EXIST, THEY ARE SHOWN IN PARENTHESES IMMEDIATELY BELOW THE CHEMICAL NAME.
ND = NOT DETECTED ; BDL = BELOW DETECTION LIMITS ; --- = NOT TESTED.

SPARTON TECHNOLOGY, INC.
COORS ROAD FACILITY
GROUNDWATER MONITORING RESULTS
PART 2 of 3

		[----- mg/l -----]																	
YEAR	QUARTER NO.	Acrolein	Acrylo-nitrile	Benzene	Bis-(chloro-methyl) ether	Bromo-form	Carbon tetra-chloride (0.01)	Chloro-benzene	Chloro-dibromo methane	Chloro-ethane	2-Chloro-ethyl-vinyl-ether	Chloro-form (0.1)	Dichloro-bromo-methane	Di-chloro-difluoro-methane	1,1-Di-chloro-ethane (0.025)	1,2-Di-chloro-ethane (0.01)	1,1-Di-chloro-ethylene (0.005)	1,2-Di-chloro-propane	1,3-Di-chloro-propylene
***** WELL NO. 17 (UPPER FLOW ZONE) *****																			
1983	4	---	---	---	---	---	---	---	---	---	---	---	---	---	---	---	---	---	---
1984	4	ND	ND	ND	ND	ND	ND	ND	ND	ND	ND	ND	ND	ND	1.9	ND	0.26	ND	ND
1985	1	---	---	---	---	---	---	---	---	---	---	---	---	---	---	---	---	---	---
1985	2	---	---	---	---	---	---	---	---	---	---	---	---	---	---	---	---	---	---
1985	3	---	---	---	---	---	---	---	---	---	---	---	---	---	---	---	---	---	---
1985	4	---	---	---	---	---	---	---	---	---	---	---	---	---	---	---	---	---	---
1986	1	---	---	---	---	---	---	---	---	---	---	---	---	---	---	---	---	---	---
1986	2	---	---	---	---	---	---	---	---	---	---	---	---	---	---	---	---	---	---
1986	3	---	---	---	---	---	---	---	---	---	---	---	---	---	---	---	---	---	---
1986	4	---	---	---	---	---	---	---	---	---	---	---	---	---	---	---	---	---	---
1987	1	---	---	---	---	---	---	---	---	---	---	---	---	---	---	---	---	---	---
1987	2	---	---	---	---	---	---	---	---	---	---	---	---	---	---	---	---	---	---
1987	3	---	---	ND	---	ND	ND	ND	ND	ND	ND	ND	ND	---	ND	ND	0.43	ND	ND
1987	4	---	---	---	---	---	---	---	---	---	---	---	---	---	---	---	---	---	---
1988	1	---	---	---	---	---	---	---	---	---	---	---	---	---	---	---	---	---	---
1988	2	---	---	---	---	---	---	---	---	---	---	---	---	---	---	---	---	---	---
1988	3	---	---	---	---	---	---	---	---	---	---	---	---	---	---	---	---	---	---

NOTES : WHERE STATE STANDARDS EXIST, THEY ARE SHOWN IN PARENTHESES IMMEDIATELY BELOW THE CHEMICAL NAME.
ND = NOT DETECTED ; BDL = BELOW DETECTION LIMITS ; --- = NOT TESTED.

OGC-003068

SPARTON TECHNOLOGY, INC.
COORS ROAD FACILITY
GROUNDWATER MONITORING RESULTS
PART 2 of 3

----- mg/l -----															-----				
QUARTER YEAR	NO.	Acrolein	Acrylo- nitrile	Benzene	Bis- (chloro- methyl) ether	Bromo- form	Carbon tetra- chloride (0.01)	Chloro- benzene	Chloro- dibromo methane	Chloro- ethane	2-Chloro- ethyl- vinyl- ether	Chloro- form (0.1)	Dichloro- bromo- methane	Di- chloro- difluoro- methane	1,1-Di- chloro- ethane (0.025)	1,2-Di- chloro- ethane (0.01)	1,1-Di- chloro- ethylene (0.005)	1,2-Di- chloro propane	1,3-Di- chloro- propylene
***** WELL NO. 18 (UPPER FLOW ZONE) *****																			
1983	4	---	---	---	---	---	---	---	---	---	---	---	---	---	---	---	---	---	---
1984	4	---	---	---	---	---	---	---	---	---	---	---	---	---	---	---	---	---	---
1985	1	---	---	---	---	---	---	---	---	---	---	---	---	---	---	---	---	---	---
1985	2	---	---	---	---	---	---	---	---	---	---	---	---	---	---	---	---	---	---
1985	3	---	---	---	---	---	---	---	---	---	---	---	---	---	---	---	---	---	---
1985	4	---	---	---	---	---	---	---	---	---	---	---	---	---	---	---	---	---	---
1986	1	---	---	---	---	---	---	---	---	---	---	---	---	---	---	---	---	---	---
1986	2	---	---	---	---	---	---	---	---	---	---	---	---	---	---	---	---	---	---
1986	3	---	---	---	---	---	---	---	---	---	---	---	---	---	---	---	0.65	---	---
1986	4	BDL	BDL	BDL	---	BDL	BDL	BDL	BDL	BDL	BDL	BDL	BDL	---	BDL	BDL	0.39	BDL	BDL
1987	1	---	---	---	---	---	---	---	---	---	---	---	---	---	---	---	0.4	---	---
1987	2	---	---	---	---	---	---	---	---	---	---	---	---	---	---	---	0.29	---	---
1987	3	---	---	ND	---	ND	ND	ND	ND	ND	ND	ND	ND	---	ND	ND	0.48	ND	ND
1987	4	---	---	---	---	---	---	---	---	---	---	---	---	---	---	---	0.34	---	---
1988	1	---	---	---	---	---	---	---	---	---	---	---	---	---	---	---	0.32	---	---
1988	2	---	---	---	---	---	---	---	---	---	---	---	---	---	---	---	ND	---	---
1988	3	---	---	ND	---	ND	ND	ND	ND	ND	ND	ND	ND	---	ND	ND	0.77	ND	ND

NOTES : WHERE STATE STANDARDS EXIST, THEY ARE SHOWN IN PARENTHESES IMMEDIATELY BELOW THE CHEMICAL NAME.
ND = NOT DETECTED ; BDL = BELOW DETECTION LIMITS ; --- = NOT TESTED.

SPARTON TECHNOLOGY, INC.
COORS ROAD FACILITY
GROUNDWATER MONITORING RESULTS
PART 2 of 3

		----- mg/l -----																	
YEAR	QUARTER NO.	Acrolein	Acrylonitrile	Benzene	Bis-(chloromethyl) ether	Bromoform	Carbon tetrachloride (0.01)	Chlorobenzene	Chlorodibromomethane	Chloroethane	2-Chloroethylvinyl ether	Chloroform (0.1)	Dichlorobromomethane	Di-chlorodifluoromethane	1,1-Di-chloroethane (0.025)	1,2-Di-chloroethane (0.01)	1,1-Di-chloroethylene (0.005)	1,2-Di-chloropropane	1,3-Di-chloropropylene
***** WELL NO. 19 (LOWER FLOW ZONE) *****																			
1983	4	---	---	---	---	---	---	---	---	---	---	---	---	---	---	---	---	---	---
1984	4	---	---	---	---	---	---	---	---	---	---	---	---	---	---	---	---	---	---
1985	1	---	---	---	---	---	---	---	---	---	---	---	---	---	---	---	---	---	---
1985	2	---	---	---	---	---	---	---	---	---	---	---	---	---	---	---	---	---	---
1985	3	---	---	---	---	---	---	---	---	---	---	---	---	---	---	---	---	---	---
1985	4	---	---	---	---	---	---	---	---	---	---	---	---	---	---	---	---	---	---
1986	1	---	---	---	---	---	---	---	---	---	---	---	---	---	---	---	---	---	---
1986	2	---	---	---	---	---	---	---	---	---	---	---	---	---	---	---	---	---	---
1986	3	---	---	---	---	---	---	---	---	---	---	---	---	---	---	---	---	---	---
1986	4	BDL	BDL	BDL	---	BDL	BDL	BDL	BDL	BDL	BDL	BDL	BDL	---	BDL	BDL	0.32	BDL	BDL
1987	1	---	---	---	---	---	---	---	---	---	---	---	---	---	---	---	0.2	---	---
1987	2	---	---	---	---	---	---	---	---	---	---	---	---	---	---	---	0.19	---	---
1987	3	---	---	ND	---	ND	ND	ND	ND	ND	ND	ND	ND	---	ND	ND	0.36	ND	ND
1987	4	---	---	---	---	---	---	---	---	---	---	---	---	---	---	---	0.33	---	---
1988	1	---	---	---	---	---	---	---	---	---	---	---	---	---	---	---	0.26	---	---
1988	2	---	---	---	---	---	---	---	---	---	---	---	---	---	---	---	ND	---	---
1988	3	---	---	ND	---	ND	ND	ND	ND	ND	ND	ND	ND	---	ND	ND	0.790	ND	ND

NOTES : WHERE STATE STANDARDS EXIST, THEY ARE SHOWN IN PARENTHESES IMMEDIATELY BELOW THE CHEMICAL NAME.
ND = NOT DETECTED ; BDL = BELOW DETECTION LIMITS ; --- = NOT TESTED.

SPARTON TECHNOLOGY, INC.
COORS ROAD FACILITY
GROUNDWATER MONITORING RESULTS
PART 2 of 3

mg/l

YEAR	QUARTER NO.	Acrolein	Acrylonitrile	Benzene	Bis-(chloromethyl) ether	Bromoform	Carbon tetrachloride (0.01)	Chlorobenzene	Chlorodibromomethane	Chloroethane	2-Chloroethylvinyl ether	Chloroform (0.1)	Dichlorobromomethane	Dichlorodifluoromethane	1,1-Dichloroethane (0.025)	1,2-Dichloroethane (0.01)	1,1-Dichloroethylene (0.005)	1,2-Dichloropropane	1,3-Dichloropropylene
1983	4	---	---	---	---	---	---	---	---	---	---	---	---	---	---	---	---	---	---
1984	4	---	---	---	---	---	---	---	---	---	---	---	---	---	---	---	---	---	---
1985	1	---	---	---	---	---	---	---	---	---	---	---	---	---	---	---	---	---	---
1985	2	---	---	---	---	---	---	---	---	---	---	---	---	---	---	---	---	---	---
1985	3	---	---	---	---	---	---	---	---	---	---	---	---	---	---	---	---	---	---
1985	4	---	---	---	---	---	---	---	---	---	---	---	---	---	---	---	---	---	---
1986	1	---	---	---	---	---	---	---	---	---	---	---	---	---	---	---	---	---	---
1986	2	---	---	---	---	---	---	---	---	---	---	---	---	---	---	---	---	---	---
1986	3	---	---	---	---	---	---	---	---	---	---	---	---	---	---	---	---	---	---
1986	4	BDL	BDL	BDL	---	BDL	BDL	BDL	BDL	BDL	BDL	BDL	BDL	---	BDL	BDL	BDL	BDL	BDL
1987	1	---	---	---	---	---	---	---	---	---	---	---	---	---	---	---	ND	---	---
1987	2	---	---	---	---	---	---	---	---	---	---	---	---	---	---	---	0.0018	---	---
1987	3	---	---	ND	---	ND	ND	ND	ND	ND	ND	ND	ND	---	ND	ND	ND	ND	ND
1987	4	---	---	---	---	---	---	---	---	---	---	---	---	---	---	---	ND	---	---
1988	1	---	---	---	---	---	---	---	---	---	---	---	---	---	---	---	ND	---	---
1988	2	---	---	---	---	---	---	---	---	---	---	---	---	---	---	---	ND	---	---
1988	3	---	---	ND	---	ND	ND	ND	ND	ND	ND	ND	ND	---	ND	ND	ND	ND	ND

NOTES : WHERE STATE STANDARDS EXIST, THEY ARE SHOWN IN PARENTHESES IMMEDIATELY BELOW THE CHEMICAL NAME.
ND = NOT DETECTED ; BDL = BELOW DETECTION LIMITS ; --- = NOT TESTED.

SPARTON TECHNOLOGY, INC.
COORS ROAD FACILITY
GROUNDWATER MONITORING RESULTS
PART 2 of 3

QUARTER		Acrolein	Acrylo-		Bis-		Carbon		Chloro-		2-Chloro-		Dichloro-	Di-	1,1-Di-	1,2-Di-	1,1-Di-	1,2-Di-	1,3-Di-
YEAR	NO.		nitrile	Benzene	(chloro- methyl) ether	Bromo- form	tetra- chloride (0.01)	chloro- benzene	dibromo methane	chloro- ethane	ethyl- vinyl- ether	Chloro- form (0.1)	bromo- methane	chloro- difluoro- methane	chloro- ethane (0.025)	chloro- ethane (0.01)	chloro- ethylene (0.005)	chloro propane	chloro- propylene
***** WELL NO. 21 (UPPER FLOW ZONE) *****																			
1983	4	---	---	---	---	---	---	---	---	---	---	---	---	---	---	---	---	---	---
1984	4	---	---	---	---	---	---	---	---	---	---	---	---	---	---	---	---	---	---
1985	1	---	---	---	---	---	---	---	---	---	---	---	---	---	---	---	---	---	---
1985	2	---	---	---	---	---	---	---	---	---	---	---	---	---	---	---	---	---	---
1985	3	---	---	---	---	---	---	---	---	---	---	---	---	---	---	---	---	---	---
1985	4	---	---	---	---	---	---	---	---	---	---	---	---	---	---	---	---	---	---
1986	1	---	---	---	---	---	---	---	---	---	---	---	---	---	---	---	---	---	---
1986	2	---	---	---	---	---	---	---	---	---	---	---	---	---	---	---	---	---	---
1986	3	---	---	---	---	---	---	---	---	---	---	---	---	---	---	---	---	---	---
1986	4	BDL	BDL	BDL	---	BDL	BDL	BDL	BDL	BDL	BDL	BDL	BDL	---	BDL	BDL	0.3	BDL	BDL
1987	1	---	---	---	---	---	---	---	---	---	---	---	---	---	---	---	0.13	---	---
1987	2	---	---	---	---	---	---	---	---	---	---	---	---	---	---	---	0.084	---	---
1987	3	---	---	ND	---	ND	ND	ND	ND	ND	ND	ND	ND	---	ND	ND	0.25	ND	ND
1987	4	---	---	---	---	---	---	---	---	---	---	---	---	---	---	---	0.2	---	---
1988	1	---	---	---	---	---	---	---	---	---	---	---	---	---	---	---	0.15	---	---
1988	2	---	---	---	---	---	---	---	---	---	---	---	---	---	---	---	0.088	---	---
1988	3	---	---	ND	---	ND	ND	ND	ND	ND	ND	ND	ND	---	ND	ND	0.100	ND	ND

NOTES : WHERE STATE STANDARDS EXIST, THEY ARE SHOWN IN PARENTHESES IMMEDIATELY BELOW THE CHEMICAL NAME.
ND = NOT DETECTED ; BDL = BELOW DETECTION LIMITS ; --- = NOT TESTED.

SPARTON TECHNOLOGY, INC.
COORS ROAD FACILITY
GROUNDWATER MONITORING RESULTS
PART 2 of 3

2

[----- mg/l -----]																			
QUARTER		Acrolein	Acrylo- nitrile	Benzene	Bis- (chloro- methyl) ether	Bromo- form	Carbon tetra- chloride (0.01)	Chloro- benzene	Chloro- dibromo methane	Chloro- ethane	2-Chloro- ethyl- vinyl- ether	Chloro- form (0.1)	Dichloro- bromo- methane	Di- chloro- difluoro- methane	1,1-Di- chloro- ethane (0.025)	1,2-Di- chloro- ethane (0.01)	1,1-Di- chloro- ethylene (0.005)	1,2-Di- chloro propane	1,3-Di- chloro- propylene
YEAR	NO.	Acrolein	nitrile	Benzene	ether	form	(0.01)	benzene	methane	ethane	ether	(0.1)	methane	methane	(0.025)	(0.01)	(0.005)	propane	propylene
***** WELL NO. 22 (UPPER FLOW ZONE) *****																			
1983	4	---	---	---	---	---	---	---	---	---	---	---	---	---	---	---	---	---	---
1984	4	---	---	---	---	---	---	---	---	---	---	---	---	---	---	---	---	---	---
1985	1	---	---	---	---	---	---	---	---	---	---	---	---	---	---	---	---	---	---
1985	2	---	---	---	---	---	---	---	---	---	---	---	---	---	---	---	---	---	---
1985	3	---	---	---	---	---	---	---	---	---	---	---	---	---	---	---	---	---	---
1985	4	---	---	---	---	---	---	---	---	---	---	---	---	---	---	---	---	---	---
1986	1	---	---	---	---	---	---	---	---	---	---	---	---	---	---	---	---	---	---
1986	2	---	---	---	---	---	---	---	---	---	---	---	---	---	---	---	---	---	---
1986	3	---	---	---	---	---	---	---	---	---	---	---	---	---	---	---	---	---	---
1986	4	BDL	BDL	BDL	---	BDL	BDL	BDL	BDL	BDL	BDL	BDL	BDL	---	BDL	BDL	0.2	BDL	BDL
1987	1	---	---	---	---	---	---	---	---	---	---	---	---	---	---	---	0.11	---	---
1987	2	---	---	---	---	---	---	---	---	---	---	---	---	---	---	---	0.1	---	---
1987	3	---	---	ND	---	ND	ND	ND	ND	ND	ND	ND	ND	---	ND	ND	0.078	ND	ND
1987	4	---	---	---	---	---	---	---	---	---	---	---	---	---	---	---	0.12	---	---
1988	1	---	---	---	---	---	---	---	---	---	---	---	---	---	---	---	0.098	---	---
1988	2	---	---	---	---	---	---	---	---	---	---	---	---	---	---	---	0.067	---	---
1988	3	---	---	ND	---	ND	ND	ND	ND	ND	ND	ND	ND	---	ND	ND	0.110	ND	ND

NOTES : WHERE STATE STANDARDS EXIST, THEY ARE SHOWN IN PARENTHESES IMMEDIATELY BELOW THE CHEMICAL NAME.
ND = NOT DETECTED ; BDL = BELOW DETECTION LIMITS ; --- = NOT TESTED.

SPARTON TECHNOLOGY, INC.
COORS ROAD FACILITY
GROUNDWATER MONITORING RESULTS
PART 2 of 3

073

[----- mg/l -----]																			
QUARTER		Acrolein	Acrylo- nitrile	Benzene	Bis- (chloro- methyl) ether	Bromo- form	Carbon tetra- chloride (0.01)	Chloro- benzene	Chloro- dibromo methane	Chloro- ethane	2-Chloro- ethyl- vinyl- ether	Chloro- form (0.1)	Dichloro- bromo- methane	Di- chloro- difluoro- methane	1,1-Di- chloro- ethane (0.025)	1,2-Di- chloro- ethane (0.01)	1,1-Di- chloro- ethylene (0.005)	1,2-Di- chloro propane	1,3-Di- chloro- propylene
YEAR	NO.	Acrolein	nitrile	Benzene	ether	form	(0.01)	benzene	methane	ethane	ether	(0.1)	methane	methane	(0.025)	(0.01)	(0.005)	propane	propylene
***** WELL NO. 23 (UPPER FLOW ZONE) *****																			
1983	4	---	---	---	---	---	---	---	---	---	---	---	---	---	---	---	---	---	---
1984	4	---	---	---	---	---	---	---	---	---	---	---	---	---	---	---	---	---	---
1985	1	---	---	---	---	---	---	---	---	---	---	---	---	---	---	---	---	---	---
1985	2	---	---	---	---	---	---	---	---	---	---	---	---	---	---	---	---	---	---
1985	3	---	---	---	---	---	---	---	---	---	---	---	---	---	---	---	---	---	---
1985	4	---	---	---	---	---	---	---	---	---	---	---	---	---	---	---	---	---	---
1986	1	---	---	---	---	---	---	---	---	---	---	---	---	---	---	---	---	---	---
1986	2	---	---	---	---	---	---	---	---	---	---	---	---	---	---	---	---	---	---
1986	3	---	---	---	---	---	---	---	---	---	---	---	---	---	---	---	---	---	---
1986	4	BDL	BDL	BDL	---	BDL	BDL	BDL	BDL	BDL	BDL	BDL	EDL	---	BDL	BDL	1.2	BDL	BDL
1987	1	---	---	---	---	---	---	---	---	---	---	---	---	---	---	---	1	---	---
1987	2	---	---	---	---	---	---	---	---	---	---	---	---	---	---	---	0.62	---	---
1987	3	---	---	ND	---	ND	ND	ND	ND	ND	ND	ND	ND	---	ND	ND	0.61	ND	ND
1987	4	---	---	---	---	---	---	---	---	---	---	---	---	---	---	---	1.4	---	---
1988	1	---	---	---	---	---	---	---	---	---	---	---	---	---	---	---	1.8	---	---
1988	2	---	---	---	---	---	---	---	---	---	---	---	---	---	---	---	1.6	---	---
1988	3	---	---	ND	---	ND	ND	ND	ND	ND	ND	ND	ND	---	ND	ND	2.400	ND	ND

NOTES : WHERE STATE STANDARDS EXIST, THEY ARE SHOWN IN PARENTHESES IMMEDIATELY BELOW THE CHEMICAL NAME.
ND = NOT DETECTED ; BDL = BELOW DETECTION LIMITS ; --- = NOT TESTED.

SPARTON TECHNOLOGY, INC.
COORS ROAD FACILITY
GROUNDWATER MONITORING RESULTS
PART 3 of 3

[----- mg/l -----]																		
															[----- Non-Priority Pollutants -----]			
QUARTER YEAR	Ethyl- benzene	Methyl- bromide	Methyl- chloride	Methylene Chloride (0.1)	1,1,2,2- Tetra- chloro- ethane	Tetra- chloro- ethylene (0.02)	Toluene (0.75)	1,2- trans- Dichloro- ethylene	1,1,1- Tri- chloro- ethane (0.06)	1,1,2- Tri- chloro- ethane (0.01)	Tri- chloro- ethylene (0.1)	Tri- chloro- fluoro- methane	Vinyl chloride (0.001)	Acetone	Tri- chloro- tri- fluoro- ethane	2- Hexanone	Di- methyl benzene (0.62)	Methyl ethyl ketone
***** WELL NO. 05 (UPPER FLOW ZONE) *****																		
1983 4	ND	ND	ND	ND	ND	ND	0.045	ND	0.079	ND	0.17	ND	ND	0.16	ND	ND	ND	ND
1984 4	ND	ND	ND	ND	ND	ND	ND	ND	0.07	ND	0.14	ND	ND	ND	ND	ND	---	---
1985 1	---	---	---	---	---	---	---	---	---	---	---	---	---	---	---	---	---	---
1985 2	---	---	---	---	---	---	---	---	---	---	---	---	---	---	---	---	---	---
1985 3	---	---	---	---	---	---	---	---	---	---	---	---	---	---	---	---	---	---
1985 4	---	---	---	---	---	---	---	---	---	---	---	---	---	---	---	---	---	---
1986 1	---	---	---	---	---	---	---	---	---	---	---	---	---	---	---	---	---	---
1986 2	---	---	---	---	---	---	---	---	---	---	---	---	---	---	---	---	---	---
1986 3	---	---	---	---	---	---	---	---	---	---	---	---	---	---	---	---	---	---
1986 4	---	---	---	---	---	---	---	---	---	---	---	---	---	---	---	---	---	---
1987 1	---	---	---	---	---	---	---	---	---	---	---	---	---	---	---	---	---	---
1987 2	---	---	---	---	---	---	---	---	---	---	---	---	---	---	---	---	---	---
1987 3	ND	ND	ND	ND	ND	ND	ND	ND	0.015	ND	0.039	---	ND	ND	---	ND	ND	ND
1987 4	---	---	---	---	---	---	---	---	---	---	---	---	---	---	---	---	---	---
1988 1	---	---	---	---	---	---	---	---	---	---	---	---	---	---	---	---	---	---
1988 2	---	---	---	---	---	---	---	---	---	---	---	---	---	---	---	---	---	---
1988 3	---	---	---	---	---	---	---	---	---	---	---	---	---	---	---	---	---	---

NOTES : WHERE STATE STANDARDS EXIST, THEY ARE SHOWN IN PARENTHESES IMMEDIATELY BELOW THE CHEMICAL NAME.

ND = NOT DETECTED ; BDL = BELOW DETECTION LIMITS ; --- = NOT TESTED

OGC-003075

SPARTON TECHNOLOGY, INC.
COORS ROAD FACILITY
GROUNDWATER MONITORING RESULTS
PART 3 of 3

[----- mg/l -----]																		
															[----- Non-Priority Pollutants -----]			
QUARTER	Ethyl-	Methyl-	Methyl-	Methylene	1,1,2,2-	Tetra-		1,2-	1,1,1-	1,1,2-	Tri-	Tri-	Vinyl		Tri-	Di-	Methyl	Methyl
YEAR	benzene	bromide	chloride	Chloride	chloro-	chloro-	Toluene	Dichloro-	chloro-	chloro-	chloro-	chloro-	chloride	Acetone	chloro-	2-	benzene	ethyl
NO.				(0.1)	ethane	ethylene	(0.75)	ethylene	ethane	ethane	ethylene	methane	(0.001)		ethane	Hexanone	(0.62)	ketone
---	---	---	---	---	---	---	---	---	---	---	---	---	---	---	---	---	---	---
***** WELL NO. 06 (UPPER FLOW ZONE) *****																		
1983	4	ND	ND	ND	ND	ND	ND	ND	ND	ND	0.56	ND	ND	ND	ND	ND	ND	ND
1984	4	ND	ND	ND	ND	ND	ND	ND	ND	0.081	ND	0.31	ND	ND	ND	0.061	ND	---
1985	1	---	---	---	---	---	---	---	---	---	---	---	---	---	---	---	---	---
1985	2	---	---	---	---	---	---	---	---	---	---	---	---	---	---	---	---	---
1985	3	EDL	BDL	BDL	BDL	BDL	BDL	BDL	BDL	0.062	BDL	0.3	---	BDL	---	---	---	---
1985	4	---	---	---	---	---	---	---	---	---	---	---	---	---	---	---	---	---
1986	1	---	---	---	---	---	---	---	---	---	---	0.31	---	---	---	---	---	---
1986	2	---	---	---	---	---	---	---	---	---	---	0.11	---	---	---	---	---	---
1986	3	---	---	---	---	---	---	---	---	---	---	0.42	---	---	---	---	---	---
1986	4	EDL	BDL	BDL	BDL	BDL	BDL	BDL	BDL	0.14	BDL	0.39	---	BDL	---	---	---	---
1987	1	---	---	---	---	---	---	---	---	---	---	0.3	---	---	---	---	---	---
1987	2	---	---	---	---	---	---	---	---	---	---	0.32	---	---	---	---	---	---
1987	3	ND	ND	ND	ND	ND	ND	ND	ND	0.13	ND	0.54	---	ND	ND	---	ND	ND
1987	4	---	---	---	---	---	---	---	---	---	---	0.36	---	---	---	---	---	---
1988	1	---	---	---	---	---	---	---	---	---	---	0.28	---	---	---	---	---	---
1988	2	---	---	---	---	---	---	---	---	---	---	0.17	---	---	---	---	---	---
1988	3	ND	ND	ND	ND	ND	ND	ND	ND	0.021	ND	0.052	---	ND	ND	---	ND	ND

NOTES : WHERE STATE STANDARDS EXIST, THEY ARE SHOWN IN PARENTHESES IMMEDIATELY BELOW THE CHEMICAL NAME.
ND = NOT DETECTED ; BDL = BELOW DETECTION LIMITS ; --- = NOT TESTED

OGC-003076

SPARTON TECHNOLOGY, INC.
COORS ROAD FACILITY
GROUNDWATER MONITORING RESULTS
PART 3 of 3

		mg/l															Non-Priority Pollutants		
QUARTER	Ethyl-	Methyl-	Methyl-	Methylene	1,1,2,2-	Tetra-		1,2-	1,1,1-	1,1,2-	Tri-	Tri-	Tri-	Tri-	Vinyl	Acetone	Tri-	Di-	Methyl
YEAR NO.	benzene	bromide	chloride	Chloride	chloro-	chloro-	Toluene	Dichloro-	chloro-	chloro-	chloro-	chloro-	chloro-	fluoro-	chloride		chloro-	2-	benzene
				(0.1)	ethane	ethylene	(0.75)	ethylene	ethane	ethane	ethylene	ethylene	methane	(0.001)			fluoro-	Hexanone	(0.62)
																	ethane		ethyl
																			ketone
***** WELL NO. 07 (UPPER FLOW ZONE) *****																			
1983	4	ND	ND	ND	ND	ND	0.005	ND	0.014	ND	0.083	ND	ND	ND	ND	ND	ND	ND	ND
1984	4	ND	ND	ND	ND	ND	ND	ND	0.18	ND	0.53	ND	ND	ND	ND	0.073	ND	---	---
1985	1	---	---	---	---	---	---	---	---	---	---	---	---	---	---	---	---	---	---
1985	2	---	---	---	---	---	---	---	---	---	---	---	---	---	---	---	---	---	---
1985	3	---	---	---	---	---	---	---	---	---	---	---	---	---	---	---	---	---	---
1985	4	---	---	---	---	---	---	---	---	---	---	---	---	---	---	---	---	---	---
1986	1	---	---	---	---	---	---	---	---	---	---	---	---	---	---	---	---	---	---
1986	2	---	---	---	---	---	---	---	---	---	---	---	---	---	---	---	---	---	---
1986	3	---	---	---	---	---	---	---	---	---	---	---	---	---	---	---	---	---	---
1986	4	---	---	---	---	---	---	---	---	---	---	---	---	---	---	---	---	---	---
1987	1	---	---	---	---	---	---	---	---	---	---	---	---	---	---	---	---	---	---
1987	2	---	---	---	---	---	---	---	---	---	---	---	---	---	---	---	---	---	---
1987	3	ND	ND	ND	ND	ND	ND	ND	0.11	ND	0.37	---	ND	ND	---	ND	---	ND	ND
1987	4	---	---	---	---	---	---	---	---	---	---	---	---	---	---	---	---	---	---
1988	1	---	---	---	---	---	---	---	---	---	---	---	---	---	---	---	---	---	---
1988	2	---	---	---	---	---	---	---	---	---	---	---	---	---	---	---	---	---	---
1988	3	---	---	---	---	---	---	---	---	---	---	---	---	---	---	---	---	---	---

NOTES : WHERE STATE STANDARDS EXIST, THEY ARE SHOWN IN PARENTHESES IMMEDIATELY BELOW THE CHEMICAL NAME.

ND = NOT DETECTED ; BDL = BELOW DETECTION LIMITS ; --- = NOT TESTED

OGC-003077

SPARTON TECHNOLOGY, INC.
COORS ROAD FACILITY
GROUNDWATER MONITORING RESULTS
PART 3 of 3

[----- mg/l -----]		[----- Non-Priority Pollutants -----]																	
QUARTER	Ethyl- benzene	Methyl- bromide	Methyl- chloride	Methylene Chloride (0.1)	1,1,2,2- Tetra- chloro- ethane	Tetra- chloro- ethylene (0.02)	Toluene (0.75)	1,2- trans- Dichloro- ethylene	1,1,1- Tri- chloro- ethane (0.06)	1,1,2- Tri- chloro- ethane (0.01)	Tri- chloro- ethylene (0.1)	Tri- chloro- fluoro- methane	Vinyl chloride (0.001)	Acetone	Tri- chloro- tri- fluoro- ethane	2- Hexanone	Di- methyl benzene (0.62)	Methyl ethyl ketone	
YEAR	NO.																		
***** WELL NO. 08 (UPPER FLOW ZONE) *****																			
1983	4	ND	ND	ND	ND	ND	ND	ND	0.007	ND	0.042	ND	ND	ND	ND	ND	ND	ND	ND
1984	4	ND	ND	ND	ND	ND	ND	ND	0.082	ND	0.25	ND	ND	ND	ND	ND	---	---	---
1985	1	---	---	---	---	---	---	---	---	---	---	---	---	---	---	---	---	---	---
1985	2	---	---	---	---	---	---	---	---	---	---	---	---	---	---	---	---	---	---
1985	3	BDL	BDL	BDL	BDL	BDL	BDL	BDL	0.039	BDL	0.19	---	BDL	---	---	---	---	---	---
1985	4	---	---	---	---	---	---	---	---	---	---	---	---	---	---	---	---	---	---
1986	1	---	---	---	---	---	---	---	---	---	0.1	---	---	---	---	---	---	---	---
1986	2	---	---	---	---	---	---	---	---	---	0.16	---	---	---	---	---	---	---	---
1986	3	---	---	---	---	---	---	---	---	---	0.15	---	---	---	---	---	---	---	---
1986	4	BDL	BDL	BDL	BDL	BDL	BDL	BDL	0.039	BDL	0.19	---	BDL	---	---	---	---	---	---
1987	1	---	---	---	---	---	---	---	---	---	0.084	---	---	---	---	---	---	---	---
1987	2	---	---	---	---	---	---	---	---	---	0.069	---	---	---	---	---	---	---	---
1987	3	ND	ND	ND	ND	ND	ND	ND	0.033	ND	0.3	---	ND	ND	---	ND	ND	ND	ND
1987	4	---	---	---	---	---	---	---	---	---	0.15	---	---	---	---	---	---	---	---
1988	1	---	---	---	---	---	---	---	---	---	0.045	---	---	---	---	---	---	---	---
1988	2	---	---	---	---	---	---	---	---	---	0.093	---	---	---	---	---	---	---	---
1988	3	ND	ND	ND	ND	ND	ND	ND	0.0068	ND	0.066	---	ND	ND	---	ND	ND	ND	ND

NOTES : WHERE STATE STANDARDS EXIST, THEY ARE SHOWN IN PARENTHESES IMMEDIATELY BELOW THE CHEMICAL NAME.
ND = NOT DETECTED ; BDL = BELOW DETECTION LIMITS ; --- = NOT TESTED

SPARTON TECHNOLOGY, INC.
COORS ROAD FACILITY
GROUNDWATER MONITORING RESULTS
PART 3 of 3

[----- mg/l -----]																		
														[----- Non-Priority Pollutants -----]				
QUARTER	Ethyl-	Methyl-	Methyl-	Methylene	1,1,2,2-	Tetra-	Toluene	1,2-	1,1,1-	1,1,2-	Tri-	Tri-	Vinyl	Acetone	Tri-	2-	Di-	Methyl
YEAR	benzene	bromide	chloride	Chloride	chloro-	chloro-	(0.75)	trans-	chloro-	chloro-	chloro-	chloro-	chloride		chloro-	Hexanone	benzene	ethyl
NO.				(0.1)	ethane	ethylene		ethylene	ethane	ethane	ethylene	methane	(0.001)		ethane		(0.62)	ketone
									(0.06)	(0.01)	(0.1)							
***** WELL NO. 09 (UPPER FLOW ZONE) *****																		
1983	4	0.013	ND	ND	9.1	ND	0.054	1.2	ND	15	ND	21	ND	ND	2.3	ND	0.17	ND
1984	4	0.013	ND	ND	5.2	ND	0.06	0.29	0.011	6.9	0.11	9.6	ND	ND	0.033	0.2	ND	---
1985	1	---	---	---	---	---	---	---	---	---	---	---	---	---	---	---	---	---
1985	2	---	---	---	---	---	---	---	---	---	---	---	---	---	---	---	---	---
1985	3	BDL	BDL	BDL	1.2	BDL	0.028	0.023	BDL	6.3	0.049	7.3	---	BDL	---	---	---	---
1985	4	---	---	---	---	---	---	---	---	---	---	---	---	---	---	---	---	---
1986	1	---	---	---	---	---	---	---	---	---	---	6.1	---	---	---	---	---	---
1986	2	---	---	---	---	---	---	---	---	---	---	8.3	---	---	---	---	---	---
1986	3	---	---	---	---	---	---	---	---	---	---	5	---	---	---	---	---	---
1986	4	BDL	BDL	BDL	BDL	BDL	BDL	BDL	BDL	2.7	BDL	5	---	BDL	---	---	---	---
1987	1	---	---	---	---	---	---	---	---	---	---	4.5	---	---	---	---	---	---
1987	2	---	---	---	---	---	---	---	---	---	---	3.600	---	---	---	---	---	---
1987	3	ND	ND	ND	ND	ND	ND	ND	ND	3.3	ND	6.400	---	ND	ND	---	ND	ND
1987	4	---	---	---	---	---	---	---	---	---	---	7.100	---	---	---	---	---	---
1988	1	---	---	---	---	---	---	---	---	---	---	5.500	---	---	---	---	---	---
1988	2	---	---	---	---	---	---	---	---	---	---	4.800	---	---	---	---	---	---
1988	3	ND	ND	ND	ND	ND	ND	ND	ND	1.800	ND	3.300	---	ND	ND	---	ND	ND

NOTES : WHERE STATE STANDARDS EXIST, THEY ARE SHOWN IN PARENTHESES IMMEDIATELY BELOW THE CHEMICAL NAME.
ND = NOT DETECTED ; BDL = BELOW DETECTION LIMITS ; --- = NOT TESTED

SPARTON TECHNOLOGY, INC.
COORS ROAD FACILITY
GROUNDWATER MONITORING RESULTS
PART 3 of 3

QUARTER		[----- mg/l -----]															[----- Non-Priority Pollutants -----]				
YEAR	NO.	Ethyl- benzene	Methyl- bromide	Methyl- chloride	Methylene Chloride (0.1)	1,1,2,2- Tetra- chloro- ethane	Tetra- chloro- ethylene (0.02)	Toluene (0.75)	1,2- trans- Dichloro- ethylene	1,1,1- Tri- chloro- ethane (0.06)	1,1,2- Tri- chloro- ethane (0.01)	Tri- chloro- ethylene (0.1)	Tri- chloro- fluoro- methane	Vinyl chloride (0.001)	Acetone	Tri- chloro- tri- fluoro- ethane	2- Hexanone	Di- methyl benzene (0.62)	Methyl ethyl ketone		
***** WELL NO. 10 (LOWER FLOW ZONE) *****																					
1983	4	ND	ND	ND	ND	ND	ND	ND	ND	0.008	ND	0.027	ND	ND	ND	ND	ND	ND	ND		
1984	4	ND	ND	16	ND	ND	ND	ND	ND	0.005	ND	0.012	ND	ND	ND	ND	ND	---	---		
1985	1	---	---	---	---	---	---	---	---	---	---	---	---	---	---	---	---	---	---		
1985	2	---	---	---	---	---	---	---	---	---	---	---	---	---	---	---	---	---	---		
1985	3	BDL	BDL	BDL	BDL	BDL	BDL	BDL	BDL	0.013	BDL	0.041	---	BDL	---	---	---	---	---		
1985	4	---	---	---	---	---	---	---	---	---	---	---	---	---	---	---	---	---	---		
1986	1	---	---	---	---	---	---	---	---	---	---	0.042	---	---	---	---	---	---	---		
1986	2	---	---	---	---	---	---	---	---	---	---	0.19	---	---	---	---	---	---	---		
1986	3	---	---	---	---	---	---	---	---	---	---	0.054	---	---	---	---	---	---	---		
1986	4	---	---	---	---	---	---	---	---	---	---	---	---	---	---	---	---	---	---		
1987	1	---	---	---	---	---	---	---	---	---	---	---	---	---	---	---	---	---	---		
1987	2	---	---	---	---	---	---	---	---	---	---	---	---	---	---	---	---	---	---		
1987	3	ND	ND	ND	1.9	ND	ND	ND	ND	0.25	ND	1.4	---	ND	0.59	---	ND	ND	ND		
1987	4	---	---	---	---	---	---	---	---	---	---	---	---	---	---	---	---	---	---		
1988	1	---	---	---	---	---	---	---	---	---	---	---	---	---	---	---	---	---	---		
1988	2	---	---	---	---	---	---	---	---	---	---	---	---	---	---	---	---	---	---		
1988	3	---	---	---	---	---	---	---	---	---	---	---	---	---	---	---	---	---	---		

NOTES : WHERE STATE STANDARDS EXIST, THEY ARE SHOWN IN PARENTHESES IMMEDIATELY BELOW THE CHEMICAL NAME.

ND = NOT DETECTED ; BDL = BELOW DETECTION LIMITS ; --- = NOT TESTED

SPARTON TECHNOLOGY, INC.
COORS ROAD FACILITY
GROUNDWATER MONITORING RESULTS
PART 3 of 3

[----- mg/l -----]																			[----- Non-Priority Pollutants -----]				
QUARTER	Ethyl- benzene	Methyl- bromide	Methyl- chloride	Methylene Chloride (0.1)	1,1,2,2- Tetra- chloro- ethane	Tetra- chloro- ethylene (0.02)	Toluene (0.75)	1,2- trans- Dichloro- ethylene	1,1,1- Tri- chloro- ethane (0.06)	1,1,2- Tri- chloro- ethane (0.01)	Tri- chloro- ethylene (0.1)	Tri- chloro- fluoro- methane	Vinyl chloride (0.001)	Acetone	Tri- chloro- tri- fluoro- ethane	2- Hexanone	Di- methyl benzene (0.62)	Methyl ethyl ketone					
YEAR NO.	-----	-----	-----	-----	-----	-----	-----	-----	-----	-----	-----	-----	-----	-----	-----	-----	-----	-----					
***** WELL NO. 11 (LOWER FLOW ZONE) *****																							
1983 4	ND	ND	ND	0.42	ND	ND	0.091	ND	0.13	ND	0.84	ND	ND	ND	ND	ND	ND	ND					
1984 4	ND	ND	ND	ND	ND	ND	ND	ND	ND	ND	ND	ND	ND	ND	ND	ND	---	---					
1985 1	---	---	---	---	---	---	---	---	---	---	---	---	---	---	---	---	---	---					
1985 2	---	---	---	---	---	---	---	---	---	---	---	---	---	---	---	---	---	---					
1985 3	BDL	BDL	BDL	BDL	BDL	BDL	BDL	BDL	BDL	BDL	0.007	---	BDL	---	---	---	---	---					
1985 4	---	---	---	---	---	---	---	---	---	---	---	---	---	---	---	---	---	---					
1986 1	---	---	---	---	---	---	---	---	---	---	0.0099	---	---	---	---	---	---	---					
1986 2	---	---	---	---	---	---	---	---	---	---	0.012	---	---	---	---	---	---	---					
1986 3	---	---	---	---	---	---	---	---	---	---	0.0069	---	---	---	---	---	---	---					
1986 4	BDL	BDL	BDL	BDL	BDL	BDL	BDL	BDL	BDL	BDL	BDL	---	BDL	---	---	---	---	---					
1987 1	---	---	---	---	---	---	---	---	---	---	0.0012	---	---	---	---	---	---	---					
1987 2	---	---	---	---	---	---	---	---	---	---	ND	---	---	---	---	---	---	---					
1987 3	ND	ND	ND	ND	ND	ND	ND	ND	ND	ND	ND	---	ND	ND	---	ND	ND	ND					
1987 4	---	---	---	---	---	---	---	---	---	---	ND	---	---	---	---	---	---	---					
1988 1	---	---	---	---	---	---	---	---	---	---	ND	---	---	---	---	---	---	---					
1988 2	---	---	---	---	---	---	---	---	---	---	ND	---	---	---	---	---	---	---					
1988 3	ND	ND	ND	ND	ND	ND	ND	ND	ND	ND	ND	---	ND	ND	---	ND	ND	ND					

NOTES : WHERE STATE STANDARDS EXIST, THEY ARE SHOWN IN PARENTHESES IMMEDIATELY BELOW THE CHEMICAL NAME.

ND = NOT DETECTED ; BDL = BELOW DETECTION LIMITS ; --- = NOT TESTED

SPARTON TECHNOLOGY, INC.
COORS ROAD FACILITY
GROUNDWATER MONITORING RESULTS
PART 3 of 3

[----- mg/l -----]										[----- Non-Priority Pollutants -----]									
QUARTER	Ethyl- benzene	Methyl- bromide	Methyl- chloride	Methylene Chloride (0.1)	1,1,2,2- Tetra- chloro- ethane	Tetra- chloro- ethylene (0.02)	Toluene (0.75)	1,2- trans- Dichloro- ethylene	1,1,1- Tri- chloro- ethane (0.06)	1,1,2- Tri- chloro- ethane (0.01)	Tri- chloro- ethylene (0.1)	Tri- chloro- fluoro- methane	Vinyl chloride (0.001)	Acetone	Tri- chloro- tri- fluoro- ethane	2- Hexanone	Di- methyl benzene (0.62)	Methyl ethyl ketone	
YEAR NO.	-----	-----	-----	-----	-----	-----	-----	-----	-----	-----	-----	-----	-----	-----	-----	-----	-----	-----	
***** WELL NO. 12 (UPPER FLOW ZONE) *****																			
1983	4	---	---	---	---	---	---	---	---	---	---	---	---	---	---	---	---	---	
1984	3	ND	ND	ND	0.02	ND	ND	ND	ND	ND	0.061	ND	ND	ND	ND	ND	ND	ND	
1985	1	---	---	---	---	---	---	---	---	---	---	---	---	---	---	---	---	---	
1985	2	---	---	---	---	---	---	---	---	---	---	---	---	---	---	---	---	---	
1985	3	---	---	---	---	---	---	---	---	---	---	---	---	---	---	---	---	---	
1985	4	---	---	---	---	---	---	---	---	---	---	---	---	---	---	---	---	---	
1986	1	---	---	---	---	---	---	---	---	---	---	---	---	---	---	---	---	---	
1986	2	---	---	---	---	---	---	---	---	---	---	---	---	---	---	---	---	---	
1986	3	---	---	---	---	---	---	---	---	---	---	---	---	---	---	---	---	---	
1986	4	---	---	---	---	---	---	---	---	---	---	---	---	---	---	---	---	---	
1987	1	---	---	---	---	---	---	---	---	---	---	---	---	---	---	---	---	---	
1987	2	---	---	---	---	---	---	---	---	---	---	---	---	---	---	---	---	---	
1987	3	ND	ND	ND	0.85	ND	ND	ND	ND	1.7	ND	3.7	---	ND	ND	---	ND	ND	
1987	4	---	---	---	---	---	---	---	---	---	---	---	---	---	---	---	---	---	
1988	1	---	---	---	---	---	---	---	---	---	---	---	---	---	---	---	---	---	
1988	2	---	---	---	---	---	---	---	---	---	---	---	---	---	---	---	---	---	
1988	3	---	---	---	---	---	---	---	---	---	---	---	---	---	---	---	---	---	

NOTES : WHERE STATE STANDARDS EXIST, THEY ARE SHOWN IN PARENTHESES IMMEDIATELY BELOW THE CHEMICAL NAME.

ND = NOT DETECTED ; BDL = BELOW DETECTION LIMITS ; --- = NOT TESTED

SPARTON TECHNOLOGY, INC.
COORS ROAD FACILITY
GROUNDWATER MONITORING RESULTS
PART 3 of 3

		[----- mg/l -----]															[----- Non-Priority Pollutants -----]		
YEAR	QUARTER NO.	Ethyl- benzene	Methyl- bromide	Methyl- chloride	Methylene Chloride (0.1)	1,1,2,2- Tetra- chloro- ethane	Tetra- chloro- ethylene (0.02)	Toluene (0.75)	1,2- trans- ethylene	1,1,1- Tri- chloro- ethane (0.06)	1,1,2- Tri- chloro- ethane (0.01)	Tri- chloro- ethylene (0.1)	Tri- chloro- fluoro- methane	Vinyl chloride (0.001)	Acetone	Tri- chloro- tri- fluoro- ethane	2- Hexanone	Di- methyl benzene (0.62)	Methyl ethyl ketone
***** WELL NO. 13 (UPPER FLOW ZONE) *****																			
1983	4	---	---	---	---	---	---	---	---	---	---	---	---	---	---	---	---	---	---
1984	4	ND	ND	ND	1.7	ND	0.017	0.045	ND	4.6	ND	6.9	ND	ND	ND	0.024	ND	---	---
1985	1	---	---	---	---	---	---	---	---	---	---	---	---	---	---	---	---	---	---
1985	2	---	---	---	---	---	---	---	---	---	---	---	---	---	---	---	---	---	---
1985	3	---	---	---	---	---	---	---	---	---	---	---	---	---	---	---	---	---	---
1985	4	---	---	---	---	---	---	---	---	---	---	---	---	---	---	---	---	---	---
1986	1	---	---	---	---	---	---	---	---	---	---	---	---	---	---	---	---	---	---
1986	2	---	---	---	---	---	---	---	---	---	---	---	---	---	---	---	---	---	---
1986	3	---	---	---	---	---	---	---	---	---	---	---	---	---	---	---	---	---	---
1986	4	---	---	---	---	---	---	---	---	---	---	---	---	---	---	---	---	---	---
1987	1	---	---	---	---	---	---	---	---	---	---	---	---	---	---	---	---	---	---
1987	2	---	---	---	---	---	---	---	---	---	---	---	---	---	---	---	---	---	---
1987	3	ND	ND	ND	ND	ND	ND	ND	ND	0.52	ND	1.3	---	ND	ND	---	ND	ND	ND
1987	4	---	---	---	---	---	---	---	---	---	---	---	---	---	---	---	---	---	---
1988	1	---	---	---	---	---	---	---	---	---	---	---	---	---	---	---	---	---	---
1988	2	---	---	---	---	---	---	---	---	---	---	---	---	---	---	---	---	---	---
1988	3	---	---	---	---	---	---	---	---	---	---	---	---	---	---	---	---	---	---

NOTES : WHERE STATE STANDARDS EXIST, THEY ARE SHOWN IN PARENTHESES IMMEDIATELY BELOW THE CHEMICAL NAME.

ND = NOT DETECTED ; BDL = BELOW DETECTION LIMITS ; --- = NOT TESTED

SPARTON TECHNOLOGY, INC.
COORS ROAD FACILITY
GROUNDWATER MONITORING RESULTS
PART 3 of 3

OGC-003083

		[----- mg/l -----]													[----- Non-Priority Pollutants -----]			
QUARTER	Ethyl- benzene	Methyl- bromide	Methyl- chloride	Methylene Chloride (0.1)	1,1,2,2- Tetra- chloro- ethane	Tetra- chloro- ethylene (0.02)	Toluene (0.75)	1,2- trans- Dichloro- ethylene	1,1,1- Tri- chloro- ethane (0.06)	1,1,2- Tri- chloro- ethane (0.01)	Tri- chloro- ethylene (0.1)	Tri- chloro- fluoro- methane	Vinyl chloride (0.001)	Acetone	Tri- chloro- tri- fluoro- ethane	2- Hexanone	Di- methyl benzene (0.62)	Methyl ethyl ketone
YEAR NO.	-----	-----	-----	-----	-----	-----	-----	-----	-----	-----	-----	-----	-----	-----	-----	-----	-----	-----
***** WELL NO. 14 (UPPER FLOW ZONE) *****																		
1983 4	---	---	---	---	---	---	---	---	---	---	---	---	---	---	---	---	---	---
1984 4	ND	ND	ND	3.6	ND	0.025	0.006	ND	4.1	ND	12	ND	ND	ND	0.009	ND	---	---
1985 1	---	---	---	---	---	---	---	---	---	---	---	---	---	---	---	---	---	---
1985 2	---	---	---	---	---	---	---	---	---	---	---	---	---	---	---	---	---	---
1985 3	---	---	---	---	---	---	---	---	---	---	---	---	---	---	---	---	---	---
1985 4	---	---	---	---	---	---	---	---	---	---	---	---	---	---	---	---	---	---
1986 1	---	---	---	---	---	---	---	---	---	---	---	---	---	---	---	---	---	---
1986 2	---	---	---	---	---	---	---	---	---	---	---	---	---	---	---	---	---	---
1986 3	---	---	---	---	---	---	---	---	---	---	---	---	---	---	---	---	---	---
1986 4	BDL	BDL	BDL	BDL	BDL	BDL	BDL	BDL	0.63	BDL	4.9	---	BDL	---	---	---	---	---
1987 1	---	---	---	---	---	---	---	---	---	---	5	---	---	---	---	---	---	---
1987 2	---	---	---	---	---	---	---	---	---	---	1.8	---	---	---	---	---	---	---
1987 3	ND	ND	ND	ND	ND	ND	ND	ND	0.17	ND	2.1	---	ND	ND	---	ND	ND	ND
1987 4	---	---	---	---	---	---	---	---	---	---	2.7	---	---	---	---	---	---	---
1988 1	---	---	---	---	---	---	---	---	---	---	6.2	---	---	---	---	---	---	---
1988 2	---	---	---	---	---	---	---	---	---	---	5	---	---	---	---	---	---	---
1988 3	ND	ND	ND	ND	ND	ND	ND	ND	ND	ND	5.200	---	ND	ND	---	ND	ND	ND

NOTES : WHERE STATE STANDARDS EXIST, THEY ARE SHOWN IN PARENTHESES IMMEDIATELY BELOW THE CHEMICAL NAME.

ND = NOT DETECTED ; BDL = BELOW DETECTION LIMITS ; --- = NOT TESTED

OGC-003084

SPARTON TECHNOLOGY, INC.
COORS ROAD FACILITY
GROUNDWATER MONITORING RESULTS
PART 3 of 3

		mg/l														Non-Priority Pollutants			
QUARTER	YEAR	Ethyl- benzene	Methyl- bromide	Methyl- chloride	Methylene Chloride (0.1)	1,1,2,2- Tetra- chloro- ethane	Tetra- chloro- ethylene (0.02)	Toluene (0.75)	1,2- trans- ethylene	1,1,1- Tri- chloro- ethane (0.06)	1,1,2- Tri- chloro- ethane (0.01)	Tri- chloro- ethylene (0.1)	Tri- chloro- fluoro- methane	Vinyl chloride (0.001)	Acetone	Tri- chloro- tri- fluoro- ethane	2- Hexanone	Di- methyl benzene (0.62)	Methyl ethyl ketone
*****	WELL NO. 15 (UPPER FLOW ZONE)	*****																	
1983	4	---	---	---	---	---	---	---	---	---	---	---	---	---	---	---	---	---	---
1984	4	ND	ND	ND	0.011	ND	0.034	ND	ND	2.2	ND	4.4	ND	ND	ND	0.048	ND	---	---
1985	1	---	---	---	---	---	---	---	---	---	---	---	---	---	---	---	---	---	---
1985	2	---	---	---	---	---	---	---	---	---	---	---	---	---	---	---	---	---	---
1985	3	---	---	---	---	---	---	---	---	---	---	---	---	---	---	---	---	---	---
1985	4	---	---	---	---	---	---	---	---	---	---	---	---	---	---	---	---	---	---
1986	1	---	---	---	---	---	---	---	---	---	---	---	---	---	---	---	---	---	---
1986	2	---	---	---	---	---	---	---	---	---	---	---	---	---	---	---	---	---	---
1986	3	---	---	---	---	---	---	---	---	---	---	---	---	---	---	---	---	---	---
1986	4	BDL	BDL	BDL	BDL	BDL	BDL	BDL	BDL	0.39	BDL	0.94	---	BDL	---	---	---	---	---
1987	1	---	---	---	---	---	---	---	---	---	---	0.63	---	---	---	---	---	---	---
1987	2	---	---	---	---	---	---	---	---	---	---	0.58	---	---	---	---	---	---	---
1987	3	ND	ND	ND	ND	ND	ND	ND	ND	0.25	ND	0.65	---	ND	ND	---	ND	ND	ND
1987	4	---	---	---	---	---	---	---	---	---	---	0.48	---	---	---	---	---	---	---
1988	1	---	---	---	---	---	---	---	---	---	---	0.37	---	---	---	---	---	---	---
1988	2	---	---	---	---	---	---	---	---	---	---	ND	---	---	---	---	---	---	---
1988	3	ND	ND	ND	ND	ND	ND	ND	ND	0.150	ND	0.380	---	ND	ND	---	ND	ND	ND

NOTES : WHERE STATE STANDARDS EXIST, THEY ARE SHOWN IN PARENTHESES IMMEDIATELY BELOW THE CHEMICAL NAME.

ND = NOT DETECTED ; BDL = BELOW DETECTION LIMITS ; --- = NOT TESTED

OGC-003085

SPARTON TECHNOLOGY, INC.
COORS ROAD FACILITY
GROUNDWATER MONITORING RESULTS
PART 3 of 3

[----- mg/l -----]		[----- Non-Priority Pollutants -----]																	
QUARTER	Ethyl- benzene	Methyl- bromide	Methyl- chloride	Methylene Chloride (0.1)	1,1,2,2- Tetra- chloro- ethane	Tetra- chloro- ethylene (0.02)	Toluene (0.75)	1,2- trans- Dichloro- ethylene	1,1,1- Tri- chloro- ethane (0.06)	1,1,2- Tri- chloro- ethane (0.01)	Tri- chloro- ethylene (0.1)	Tri- chloro- fluoro- methane	Vinyl chloride (0.001)	Acetone	Tri- chloro- tri- fluoro- ethane	2- Hexanone	Di- methyl benzene (0.62)	Methyl ethyl ketone	
YEAR NO.	---	---	---	---	---	---	---	---	---	---	---	---	---	---	---	---	---	---	---
***** WELL NO. 16 (UPPER FLOW ZONE) *****																			
1983	4	---	---	---	---	---	---	---	---	---	---	---	---	---	---	---	---	---	---
1984	4	0.063	ND	0.07	49	ND	0.14	1.6	0.2	5.5	ND	37	ND	ND	17	0.073	ND	---	---
1985	1	---	---	---	---	---	---	---	---	---	---	---	---	---	---	---	---	---	---
1985	2	---	---	---	---	---	---	---	---	---	---	---	---	---	---	---	---	---	---
1985	3	---	---	---	---	---	---	---	---	---	---	---	---	---	---	---	---	---	---
1985	4	---	---	---	---	---	---	---	---	---	---	---	---	---	---	---	---	---	---
1986	1	---	---	---	---	---	---	---	---	---	---	---	---	---	---	---	---	---	---
1986	2	---	---	---	---	---	---	---	---	---	---	---	---	---	---	---	---	---	---
1986	3	---	---	---	---	---	---	---	---	---	20	---	---	---	---	---	---	---	---
1986	4	BDL	BDL	BDL	16	BDL	BDL	BDL	BDL	30	BDL	36	---	BDL	---	---	---	---	---
1987	1	---	---	---	---	---	---	---	---	---	---	21	---	---	---	---	---	---	---
1987	2	---	---	---	---	---	---	---	---	---	---	23	---	---	---	---	---	---	---
1987	3	ND	ND	ND	ND	ND	ND	ND	ND	21	ND	25	---	ND	ND	---	ND	ND	ND
1987	4	---	---	---	---	---	---	---	---	---	---	28	---	---	---	---	---	---	---
1988	1	---	---	---	---	---	---	---	---	---	---	26	---	---	---	---	---	---	---
1988	2	---	---	---	---	---	---	---	---	---	---	25	---	---	---	---	---	---	---
1988	3	ND	ND	ND	ND	ND	ND	ND	ND	24.000	ND	26.000	---	ND	ND	---	ND	ND	ND

NOTES : WHERE STATE STANDARDS EXIST, THEY ARE SHOWN IN PARENTHESES IMMEDIATELY BELOW THE CHEMICAL NAME.

ND = NOT DETECTED ; BDL = BELOW DETECTION LIMITS ; --- = NOT TESTED

OGC-003086

SPARTON TECHNOLOGY, INC.
COORS ROAD FACILITY
GROUNDWATER MONITORING RESULTS
PART 3 of 3

		----- mg/l -----														[----- Non-Priority Pollutants -----]			
YEAR	QUARTER NO.	Ethyl- benzene	Methyl- bromide	Methyl- chloride	Methylene Chloride (0.1)	1,1,2,2- Tetra- chloro- ethane	Tetra- chloro- ethylene (0.02)	Toluene (0.75)	1,2- trans- ethylene	1,1,1- Tri- chloro- ethane (0.06)	1,1,2- Tri- chloro- ethane (0.01)	Tri- chloro- ethylene (0.1)	Tri- chloro- fluoro- methane	Vinyl chloride (0.001)	Acetone	Tri- chloro- tri- fluoro- ethane	2- Hexanone	Di- methyl benzene (0.62)	Methyl ethyl ketone
***** WELL NO. 17 (UPPER FLOW ZONE) *****																			
1983	4	---	---	---	---	---	---	---	---	---	---	---	---	---	---	---	---	---	---
1984	4	ND	ND	ND	0.017	ND	0.053	0.05	0.019	2.3	ND	4.3	ND	ND	0.028	0.035	ND	---	---
1985	1	---	---	---	---	---	---	---	---	---	---	---	---	---	---	---	---	---	---
1985	2	---	---	---	---	---	---	---	---	---	---	---	---	---	---	---	---	---	---
1985	3	---	---	---	---	---	---	---	---	---	---	---	---	---	---	---	---	---	---
1985	4	---	---	---	---	---	---	---	---	---	---	---	---	---	---	---	---	---	---
1986	1	---	---	---	---	---	---	---	---	---	---	---	---	---	---	---	---	---	---
1986	2	---	---	---	---	---	---	---	---	---	---	---	---	---	---	---	---	---	---
1986	3	---	---	---	---	---	---	---	---	---	---	---	---	---	---	---	---	---	---
1986	4	---	---	---	---	---	---	---	---	---	---	---	---	---	---	---	---	---	---
1987	1	---	---	---	---	---	---	---	---	---	---	---	---	---	---	---	---	---	---
1987	2	---	---	---	---	---	---	---	---	---	---	---	---	---	---	---	---	---	---
1987	3	ND	ND	ND	ND	ND	ND	ND	ND	4	ND	4.2	---	ND	ND	---	ND	ND	ND
1987	4	---	---	---	---	---	---	---	---	---	---	---	---	---	---	---	---	---	---
1988	1	---	---	---	---	---	---	---	---	---	---	---	---	---	---	---	---	---	---
1988	2	---	---	---	---	---	---	---	---	---	---	---	---	---	---	---	---	---	---
1988	3	---	---	---	---	---	---	---	---	---	---	---	---	---	---	---	---	---	---

NOTES : WHERE STATE STANDARDS EXIST, THEY ARE SHOWN IN PARENTHESES IMMEDIATELY BELOW THE CHEMICAL NAME.

ND = NOT DETECTED ; BDL = BELOW DETECTION LIMITS ; --- = NOT TESTED

SPARTON TECHNOLOGY, INC.
COORS ROAD FACILITY
GROUNDWATER MONITORING RESULTS
PART 3 of 3

[----- mg/l -----]														[----- Non-Priority Pollutants -----]				
QUARTER	Ethyl-	Methyl-	Methyl-	Methylene	1,1,2,2-	Tetra-		1,2-	1,1,1-	1,1,2-	Tri-	Tri-	Vinyl		Tri-		Di-	Methyl
YEAR NO.	benzene	bromide	chloride	Chloride	chloro-	chloro-	Toluene	Dichloro-	chloro-	chloro-	chloro-	chloro-	chloride	Acetone	chloro-	2-	methyl	ethyl
				(0.1)	ethane	ethylene	(0.75)	ethylene	ethane	ethane	ethylene	fluoro-	(0.001)		fluoro-	Hexanone	(0.62)	ketone
***** WELL NO. 18 (UPPER FLOW ZONE) *****																		
1983	4	---	---	---	---	---	---	---	---	---	---	---	---	---	---	---	---	---
1984	4	---	---	---	---	---	---	---	---	---	---	---	---	---	---	---	---	---
1985	1	---	---	---	---	---	---	---	---	---	---	---	---	---	---	---	---	---
1985	2	---	---	---	---	---	---	---	---	---	---	---	---	---	---	---	---	---
1985	3	---	---	---	---	---	---	---	---	---	---	---	---	---	---	---	---	---
1985	4	---	---	---	---	---	---	---	---	---	---	---	---	---	---	---	---	---
1986	1	---	---	---	---	---	---	---	---	---	---	---	---	---	---	---	---	---
1986	2	---	---	---	---	---	---	---	---	---	---	---	---	---	---	---	---	---
1986	3	---	---	---	---	---	---	---	---	---	5.4	---	---	---	---	---	---	---
1986	4	BDL	BDL	BDL	BDL	BDL	BDL	BDL	3.4	BDL	3.6	---	BDL	---	---	---	---	---
1987	1	---	---	---	---	---	---	---	---	---	4	---	---	---	---	---	---	---
1987	2	---	---	---	---	---	---	---	---	---	3	---	---	---	---	---	---	---
1987	3	ND	ND	ND	ND	ND	ND	ND	2.9	ND	4.8	---	ND	ND	---	ND	ND	ND
1987	4	---	---	---	---	---	---	---	---	---	4.3	---	---	---	---	---	---	---
1988	1	---	---	---	---	---	---	---	---	---	3.5	---	---	---	---	---	---	---
1988	2	---	---	---	---	---	---	---	---	---	3.1	---	---	---	---	---	---	---
1988	3	ND	ND	ND	ND	ND	ND	ND	2.200	ND	3.800	---	ND	ND	---	ND	ND	ND

NOTES : WHERE STATE STANDARDS EXIST, THEY ARE SHOWN IN PARENTHESES IMMEDIATELY BELOW THE CHEMICAL NAME.

ND = NOT DETECTED ; BDL = BELOW DETECTION LIMITS ; --- = NOT TESTED

OGC-003088

SPARTON TECHNOLOGY, INC.
COORS ROAD FACILITY
GROUNDWATER MONITORING RESULTS
PART 3 of 3

		----- mg/l -----																
														[----- Non-Priority Pollutants -----]				
QUARTER	Ethyl-	Methyl-	Methyl-	Methylene	1,1,2,2-	Tetra-		1,2-	1,1,1-	1,1,2-	Tri-	Tri-	Vinyl		Tri-	Di-	Methyl	
YEAR NO.	benzene	bromide	chloride	Chloride	chloro-	chloro-	Toluene	Dichloro-	chloro-	chloro-	chloro-	chloro-	chloride	Acetone	chloro-	2-	benzene	ethyl
---	---	---	---	(0.1)	ethane	ethylene	(0.75)	ethylene	ethane	ethane	ethylene	methane	(0.001)	---	ethane	Hexanone	(0.62)	ketone
***** WELL NO. 19 (LOWER FLOW ZONE) *****																		
1983	4	---	---	---	---	---	---	---	---	---	---	---	---	---	---	---	---	---
1984	4	---	---	---	---	---	---	---	---	---	---	---	---	---	---	---	---	---
1985	1	---	---	---	---	---	---	---	---	---	---	---	---	---	---	---	---	---
1985	2	---	---	---	---	---	---	---	---	---	---	---	---	---	---	---	---	---
1985	3	---	---	---	---	---	---	---	---	---	---	---	---	---	---	---	---	---
1985	4	---	---	---	---	---	---	---	---	---	---	---	---	---	---	---	---	---
1986	1	---	---	---	---	---	---	---	---	---	---	---	---	---	---	---	---	---
1986	2	---	---	---	---	---	---	---	---	---	---	---	---	---	---	---	---	---
1986	3	---	---	---	---	---	---	---	---	---	---	---	---	---	---	---	---	---
1986	4	BDL	BDL	BDL	5	BDL	BDL	BDL	0.28	BDL	3.6	---	BDL	---	---	---	---	---
1987	1	---	---	---	---	---	---	---	---	---	2.7	---	---	---	---	---	---	---
1987	2	---	---	---	---	---	---	---	---	---	2.9	---	---	---	---	---	---	---
1987	3	ND	ND	ND	3.1	ND	ND	ND	0.34	ND	4.6	---	ND	ND	---	ND	ND	ND
1987	4	---	---	---	---	---	---	---	---	---	3.4	---	---	---	---	---	---	---
1988	1	---	---	---	---	---	---	---	---	---	2.9	---	---	---	---	---	---	---
1988	2	---	---	---	---	---	---	---	---	---	ND	---	---	---	---	---	---	---
1988	3	ND	ND	ND	2.700	ND	ND	ND	0.180	ND	1.800	---	ND	ND	---	ND	ND	ND

NOTES : WHERE STATE STANDARDS EXIST, THEY ARE SHOWN IN PARENTHESES IMMEDIATELY BELOW THE CHEMICAL NAME.

ND = NOT DETECTED ; BDL = BELOW DETECTION LIMITS ; --- = NOT TESTED

OGC-003089

SPARTON TECHNOLOGY, INC.
COORS ROAD FACILITY
GROUNDWATER MONITORING RESULTS
PART 3 of 3

[----- mg/l -----]													[----- Non-Priority Pollutants -----]					
QUARTER	Ethyl-	Methyl-	Methyl-	Methylene	1,1,2,2-	Tetra-		1,2-	1,1,1-	1,1,2-	Tri-	Tri-	Vinyl		Tri-		Di-	Methyl
YEAR NO.	benzene	bromide	chloride	Chloride	chloro-	chloro-	Toluene	Dichloro-	chloro-	chloro-	chloro-	chloro-	chloride	Acetone	fluoro-	2-	methyl	ethyl
---	---	---	---	(0.1)	ethane	(0.02)	(0.75)	ethylene	ethane	ethane	ethylene	fluoro-	(0.001)	---	ethane	Hexanone	(0.62)	ketone
***** WELL NO. 20 (LOWER FLOW ZONE) *****																		
1983	4	---	---	---	---	---	---	---	---	---	---	---	---	---	---	---	---	---
1984	4	---	---	---	---	---	---	---	---	---	---	---	---	---	---	---	---	---
1985	1	---	---	---	---	---	---	---	---	---	---	---	---	---	---	---	---	---
1985	2	---	---	---	---	---	---	---	---	---	---	---	---	---	---	---	---	---
1985	3	---	---	---	---	---	---	---	---	---	---	---	---	---	---	---	---	---
1985	4	---	---	---	---	---	---	---	---	---	---	---	---	---	---	---	---	---
1986	1	---	---	---	---	---	---	---	---	---	---	---	---	---	---	---	---	---
1986	2	---	---	---	---	---	---	---	---	---	---	---	---	---	---	---	---	---
1986	3	---	---	---	---	---	---	---	---	---	---	---	---	---	---	---	---	---
1986	4	BDL	BDL	BDL	BDL	BDL	BDL	BDL	BDL	BDL	0.017	---	BDL	---	---	---	---	---
1987	1	---	---	---	---	---	---	---	---	---	0.012	---	---	---	---	---	---	---
1987	2	---	---	---	---	---	---	---	---	---	0.032	---	---	---	---	---	---	---
1987	3	ND	ND	ND	ND	ND	ND	ND	ND	ND	0.035	---	ND	ND	---	ND	ND	ND
1987	4	---	---	---	---	---	---	---	---	---	0.025	---	---	---	---	---	---	---
1988	1	---	---	---	---	---	---	---	---	---	0.01	---	---	---	---	---	---	---
1988	2	---	---	---	---	---	---	---	---	---	0.028	---	---	---	---	---	---	---
1988	3	ND	ND	ND	ND	ND	ND	ND	ND	ND	0.019	---	ND	ND	---	ND	ND	ND

NOTES : WHERE STATE STANDARDS EXIST, THEY ARE SHOWN IN PARENTHESES IMMEDIATELY BELOW THE CHEMICAL NAME.

ND = NOT DETECTED ; BDL = BELOW DETECTION LIMITS ; --- = NOT TESTED

OGC-003090

SPARTON TECHNOLOGY, INC.
COORS ROAD FACILITY
GROUNDWATER MONITORING RESULTS
PART 3 of 3

		mg/l												Non-Priority Pollutants					
QUARTER	Ethyl- benzene	Methyl- bromide	Methyl- chloride	Methylene Chloride (0.1)	1,1,2,2- Tetra- chloro- ethane	Tetra- chloro- ethylene (0.02)	Toluene (0.75)	1,2- trans- Dichloro- ethylene	1,1,1- Tri- chloro- ethane (0.06)	1,1,2- Tri- chloro- ethane (0.01)	Tri- chloro- ethylene (0.1)	Tri- chloro- fluoro- methane	Vinyl chloride (0.001)	Acetone	Tri- chloro- tri- fluoro- ethane	2- Hexanone	Di- methyl benzene (0.62)	Methyl ethyl ketone	
***** WELL NO. 21 (UPPER FLOW ZONE) *****																			
1983	4	---	---	---	---	---	---	---	---	---	---	---	---	---	---	---	---	---	
1984	4	---	---	---	---	---	---	---	---	---	---	---	---	---	---	---	---	---	
1985	1	---	---	---	---	---	---	---	---	---	---	---	---	---	---	---	---	---	
1985	2	---	---	---	---	---	---	---	---	---	---	---	---	---	---	---	---	---	
1985	3	---	---	---	---	---	---	---	---	---	---	---	---	---	---	---	---	---	
1985	4	---	---	---	---	---	---	---	---	---	---	---	---	---	---	---	---	---	
1986	1	---	---	---	---	---	---	---	---	---	---	---	---	---	---	---	---	---	
1986	2	---	---	---	---	---	---	---	---	---	---	---	---	---	---	---	---	---	
1986	3	---	---	---	---	---	---	---	---	---	---	---	---	---	---	---	---	---	
1986	4	BDL	BDL	BDL	BDL	BDL	BDL	BDL	3.3	BDL	2.3	---	BDL	---	---	---	---	---	
1987	1	---	---	---	---	---	---	---	---	---	1.7	---	---	---	---	---	---	---	
1987	2	---	---	---	---	---	---	---	---	---	1.4	---	---	---	---	---	---	---	
1987	3	ND	ND	ND	ND	ND	ND	ND	2.8	ND	2.1	---	ND	ND	---	ND	ND	ND	
1987	4	---	---	---	---	---	---	---	---	---	2	---	---	---	---	---	---	---	
1988	1	---	---	---	---	---	---	---	---	---	1.8	---	---	---	---	---	---	---	
1988	2	---	---	---	---	---	---	---	---	---	1.1	---	---	---	---	---	---	---	
1988	3	ND	ND	ND	ND	ND	ND	ND	1.900	ND	1.500	---	ND	ND	---	ND	ND	ND	

NOTES : WHERE STATE STANDARDS EXIST, THEY ARE SHOWN IN PARENTHESES IMMEDIATELY BELOW THE CHEMICAL NAME.

ND = NOT DETECTED ; BDL = BELOW DETECTION LIMITS ; --- = NOT TESTED

OGC-003091

SPARTON TECHNOLOGY, INC.
COORS ROAD FACILITY
GROUNDWATER MONITORING RESULTS
PART 3 of 3

		mg/l														Non-Priority Pollutants			
QUARTER	YEAR	Ethyl- benzene	Methyl- bromide	Methyl- chloride	Methylene Chloride (0.1)	1,1,2,2- Tetra- chloro- ethane	Tetra- chloro- ethylene (0.02)	Toluene (0.75)	1,2- trans- Dichloro- ethylene	1,1,1- Tri- chloro- ethane (0.06)	1,1,2- Tri- chloro- ethane (0.01)	Tri- chloro- ethylene (0.1)	Tri- chloro- fluoro- methane	Vinyl chloride (0.001)	Acetone	Tri- chloro- tri- fluoro- ethane	2- Hexanone	Di- methyl benzene (0.62)	Methyl ethyl ketone
---	---	---	---	---	---	---	---	---	---	---	---	---	---	---	---	---	---	---	---
***** WELL NO. 22 (UPPER FLOW ZONE) *****																			
1983	4	---	---	---	---	---	---	---	---	---	---	---	---	---	---	---	---	---	---
1984	4	---	---	---	---	---	---	---	---	---	---	---	---	---	---	---	---	---	---
1985	1	---	---	---	---	---	---	---	---	---	---	---	---	---	---	---	---	---	---
1985	2	---	---	---	---	---	---	---	---	---	---	---	---	---	---	---	---	---	---
1985	3	---	---	---	---	---	---	---	---	---	---	---	---	---	---	---	---	---	---
1985	4	---	---	---	---	---	---	---	---	---	---	---	---	---	---	---	---	---	---
1986	1	---	---	---	---	---	---	---	---	---	---	---	---	---	---	---	---	---	---
1986	2	---	---	---	---	---	---	---	---	---	---	---	---	---	---	---	---	---	---
1986	3	---	---	---	---	---	---	---	---	---	---	---	---	---	---	---	---	---	---
1986	4	EDL	BDL	BDL	BDL	BDL	BDL	BDL	BDL	0.95	BDL	0.23	---	BDL	---	---	---	---	---
1987	1	---	---	---	---	---	---	---	---	---	---	0.17	---	---	---	---	---	---	---
1987	2	---	---	---	---	---	---	---	---	---	---	0.27	---	---	---	---	---	---	---
1987	3	ND	ND	ND	ND	ND	ND	ND	ND	0.51	ND	0.37	---	ND	ND	---	ND	ND	ND
1987	4	---	---	---	---	---	---	---	---	---	---	0.24	---	---	---	---	---	---	---
1988	1	---	---	---	---	---	---	---	---	---	---	0.15	---	---	---	---	---	---	---
1988	2	---	---	---	---	---	---	---	---	---	---	0.23	---	---	---	---	---	---	---
1988	3	ND	ND	ND	ND	ND	ND	ND	ND	0.140	ND	0.063	---	ND	ND	---	ND	ND	ND

NOTES : WHERE STATE STANDARDS EXIST, THEY ARE SHOWN IN PARENTHESES IMMEDIATELY BELOW THE CHEMICAL NAME.

ND = NOT DETECTED ; BDL = BELOW DETECTION LIMITS ; --- = NOT TESTED

OGC-003092

SPARTON TECHNOLOGY, INC.
COORS ROAD FACILITY
GROUNDWATER MONITORING RESULTS
PART 3 of 3

		mg/l													Non-Priority Pollutants			
QUARTER	Ethyl- benzene	Methyl- bromide	Methyl- chloride	Methylene Chloride (0.1)	1,1,2,2- Tetra- chloro- ethane	Tetra- chloro- ethylene (0.02)	Toluene (0.75)	1,2- trans- ethylene	1,1,1- Tri- chloro- ethane (0.06)	1,1,2- Tri- chloro- ethane (0.01)	Tri- chloro- ethylene (0.1)	Tri- chloro- fluoro- methane	Vinyl chloride (0.001)	Acetone	Tri- chloro- tri- fluoro- ethane	2- Hexanone	Di- methyl benzene (0.62)	Methyl ethyl ketone
YEAR NO.	-----	-----	-----	-----	-----	-----	-----	-----	-----	-----	-----	-----	-----	-----	-----	-----	-----	-----
***** WELL NO. 23 (UPPER FLOW ZONE) *****																		
1983 4	---	---	---	---	---	---	---	---	---	---	---	---	---	---	---	---	---	---
1984 4	---	---	---	---	---	---	---	---	---	---	---	---	---	---	---	---	---	---
1985 1	---	---	---	---	---	---	---	---	---	---	---	---	---	---	---	---	---	---
1985 2	---	---	---	---	---	---	---	---	---	---	---	---	---	---	---	---	---	---
1985 3	---	---	---	---	---	---	---	---	---	---	---	---	---	---	---	---	---	---
1985 4	---	---	---	---	---	---	---	---	---	---	---	---	---	---	---	---	---	---
1986 1	---	---	---	---	---	---	---	---	---	---	---	---	---	---	---	---	---	---
1986 2	---	---	---	---	---	---	---	---	---	---	---	---	---	---	---	---	---	---
1986 3	---	---	---	---	---	---	---	---	---	---	---	---	---	---	---	---	---	---
1986 4	BDL	BDL	BDL	BDL	BDL	BDL	BDL	BDL	7.3	BDL	7.5	---	BDL	---	---	---	---	---
1987 1	---	---	---	---	---	---	---	---	---	---	6.5	---	---	---	---	---	---	---
1987 2	---	---	---	---	---	---	---	---	---	---	3.7	---	---	---	---	---	---	---
1987 3	ND	ND	ND	ND	ND	ND	ND	ND	3.5	ND	3.9	---	ND	ND	---	ND	ND	ND
1987 4	---	---	---	---	---	---	---	---	---	---	13	---	---	---	---	---	---	---
1988 1	---	---	---	---	---	---	---	---	---	---	13	---	---	---	---	---	---	---
1988 2	---	---	---	---	---	---	---	---	---	---	11	---	---	---	---	---	---	---
1988 3	ND	ND	ND	ND	ND	ND	ND	ND	3.200	ND	3.900	---	ND	ND	---	ND	ND	ND

NOTES : WHERE STATE STANDARDS EXIST, THEY ARE SHOWN IN PARENTHESES IMMEDIATELY BELOW THE CHEMICAL NAME.

ND = NOT DETECTED ; BDL = BELOW DETECTION LIMITS ; --- = NOT TESTED