



Department of Energy
Carlsbad Field Office
P. O. Box 3090
Carlsbad, New Mexico 88221

April 12, 2022

Mr. Rick Shean, Chief
Hazardous Waste Bureau
New Mexico Environment Department
2905 Rodeo Park Drive East, Building 1
Santa Fe, New Mexico 87505

Subject: Class 1 Permit Modification Notifications, Waste Isolation Pilot Plant Hazardous Waste Facility Permit Number: NM4890139088-TSDF

Dear Mr. Shean:

Enclosed are Class 1 Permit Modification Notifications for the following items:

- Correction to Table D-2 in Permit Attachment D
- Changes to the Property Protection Area Fence, Removal of the Human Resources Trailer, and the Addition of the Access Control Point Shelter to Figures in Permit Attachment A4 and Attachment D

We certify under penalty of law that this document and enclosure were prepared under our direction or supervision according to a system designed to assure that qualified personnel properly gather and evaluate the information submitted. Based on our inquiry of the person or persons who manage the system, or those persons directly responsible for gathering the information, the information submitted is, to the best of our knowledge and belief, true, accurate, and complete. We are aware that there are significant penalties for submitting false information, including the possibility of fine and imprisonment for knowing violations.

If you have any questions, please contact Mr. Martin P. Navarrete at (575) 706-0068.

Sincerely,

Reinhard Knerr
Manager
Carlsbad Field Office

SEAN DUNAGAN
(Affiliate)
Digitally signed by SEAN
DUNAGAN (Affiliate)
Date: 2022.04.11
16:26:50 -06'00'

Sean Dunagan
President and Project Manager
Nuclear Waste Partnership LLC

Enclosure

cc: w/enclosure
R. Maestas, NMED *ED
D. Biswell, NMED ED
M. McLean, NMED ED
CBFO M&RC
*ED denotes electronic distribution

Class 1 Permit Modification Notifications

- 1. Correction to Table D-2 in Permit Attachment D**
- 2. Changes to the Property Protection Area Fence, Removal of the Human Resources Trailer, and the Addition of the Access Control Point Shelter to Figures in Permit Attachment A4 and Attachment D**

**Waste Isolation Pilot Plant
Carlsbad, New Mexico**

WIPP Permit Number - NM4890139088-TSDF

April 2022

Table of Contents

Transmittal Letter

Table of Contents.....	i
Acronyms and Abbreviations.....	1
Overview of the Permit Modification Notifications.....	2
Attachment A Description of the Class 1 Permit Modification Notifications.....	A-1
Table 1. Class 1 Hazardous Waste Facility Permit Modification Notifications.....	A-2
Item 1.....	A-4
Description.....	A-4
Basis.....	A-4
Discussion.....	A-4
Proposed Revised Permit Text:.....	A-5
Item 2.....	A-7
Description.....	A-7
Basis.....	A-7
Discussion.....	A-8
Proposed Revised Permit Text:.....	A-9

Acronyms and Abbreviations

AIS	Air Intake Shaft
CFR	Code of Federal Regulations
DOE	U.S. Department of Energy
ft	feet
NMAC	New Mexico Administrative Code
NMED	New Mexico Environment Department
Permit	Waste Isolation Pilot Plant Hazardous Waste Facility Permit
Permittees	U.S. Department of Energy and Nuclear Waste Partnership LLC
PMN	Permit Modification Notification
PPA	Property Protection Area
SCBA	self-contained breathing apparatus
WIPP	Waste Isolation Pilot Plant

Overview of the Permit Modification Notifications

This document contains two Class 1 Permit Modification Notifications (**PMNs**) for the Waste Isolation Pilot Plant (**WIPP**) Hazardous Waste Facility Permit (**Permit**) Number NM4890139088-TSDF.

These PMNs are being submitted by the U.S. Department of Energy (**DOE**) and Nuclear Waste Partnership LLC, collectively referred to as the Permittees, in accordance with Permit Part 1, Section 1.3.1. (20.4.1.900 New Mexico Administrative Code (**NMAC**) incorporating Title 40 of the Code of Federal Regulations (**CFR**) §270.42(a)). The PMNs in this document are necessary to notify the New Mexico Environment Department (**NMED**) of changes which impact the Permit. These changes do not reduce the ability of the Permittees to provide continued protection to human health and the environment.

The requested modifications to the Permit and any related supporting documents are provided in these PMNs. The proposed modifications to the text of the Permit has been identified using **red** text and double underline and a ~~strikeout~~ font for deleted information. All direct quotations are indicated by italicized text.

Attachment A
Description of the Class 1 Permit Modification Notifications

Table 1. Class 1 Hazardous Waste Facility Permit Modification Notifications

Item No.	Affected Permit Section	Change Description	Category
1	Attachment D, Table D-2, <i>Emergency Equipment Maintained at the Waste Isolation Pilot Plant</i>	This modification revises Permit Attachment D, Table D-2, <i>Emergency Equipment Maintained at the Waste Isolation Pilot Plant</i> , to remove the words “and Surface Truck” from the location column of the Fire Department self-contained breathing apparatus (SCBA) row under <i>Personnel Protection Equipment</i> .	A.1
2	Attachment A4, Figure A4-2, <i>WIPP Traffic Flow Diagram</i> Attachment A4, Figure A4-2-NFB, <i>WIPP Traffic Flow Diagram with Building 416</i> Attachment D, Figure D-1, <i>WIPP Surface Structures</i> Attachment D, Figure D-1a, <i>Legend to Figure D-1</i> Attachment D, Figure D-1-NFB, <i>WIPP Surface Structures with Building 416</i> Attachment D, Figure D-1a-NFB, <i>Legend to Figure D-1-NFB (Building 416)</i> Attachment D, Figure D-5, <i>Fire-Water Distribution System</i> Attachment D, Figure D-5-NFB, <i>Fire-Water Distribution with Building 416</i> Attachment D, Figure D-6, <i>WIPP On-Site Assembly Areas and Off-Site Staging Areas</i> Attachment D, Figure D-6-NFB, <i>WIPP On-Site Assembly Areas and Off-Site Staging Areas with Building 416</i>	<p>This modification revises figures in Permit Attachment A4 and Permit Attachment D to reflect the following changes:</p> <ul style="list-style-type: none"> • Relocate the northeast Property Protection Area (PPA) fence line approximately 12 ft to the north to include the new fire water line, • Remove temporary PPA fence line around the Air Intake Shaft (AIS). • Remove Building 971 • Add Building 270 <p>The following Permit figures are being modified to relocate the northeast PPA fence line approximately 12 ft to the north, remove Building 971 (Human Resources Trailer) and add Building 270 (Access Control Point Shelter).</p> <ul style="list-style-type: none"> • Attachment A4, Figure A4-2, <i>WIPP Traffic Flow Diagram</i> • Attachment A4, Figure A4-2-NFB, <i>WIPP Traffic Flow Diagram with Building 416</i> • Attachment D, Figure D-1, <i>WIPP Surface Structures</i> • Attachment D, Figure D-1-NFB, <i>WIPP Surface Structures with Building 416</i> • Attachment D, Figure D-5, <i>Fire-Water Distribution System</i> • Attachment D, Figure D-5-NFB, <i>Fire-Water Distribution with Building 416</i> • Attachment D, Figure D-6, <i>WIPP On-Site Assembly Areas and Off-Site Staging Areas</i> • Attachment D, Figure D-6-NFB, <i>WIPP On-Site Assembly Areas and Off-Site Staging Areas with Building 416</i> <p>The following Permit figures are being modified to remove the reference to Building 971 (Human Resources Trailer) and add the reference to Building 270 (Access Control Point Shelter).</p> <ul style="list-style-type: none"> • Attachment D, Figure D-1a, <i>Legend to Figure D-1</i> 	A.1

Item No.	Affected Permit Section	Change Description	Category
		<ul style="list-style-type: none"> • Attachment D, Figure D-1a-NFB, <i>Legend to Figure D-1-NFB (Building 416)</i> <p>The following Permit figures are being modified to remove the temporary PPA fence line around the AIS.</p> <ul style="list-style-type: none"> • Attachment A4, Figure A4-2, <i>WIPP Traffic Flow Diagram</i> • Attachment D, Figure D-1, <i>WIPP Surface Structures</i> • Attachment D, Figure D-5, <i>Fire-Water Distribution System</i> • Attachment D, Figure D-6, <i>WIPP On-Site Assembly Areas and Off-Site Staging Areas</i> 	

Item 1

Description

This modification revises Permit Attachment D, Table D-2, *Emergency Equipment Maintained at the Waste Isolation Pilot Plant*, to remove the words “and Surface Truck” from the location column of the Fire Department Self-Contained Breathing Apparatus (SCBA) row under *Personnel Protection Equipment*.

Basis

This change is classified as an "Administrative and informational change" pursuant to 20.4.1.900 NMAC (incorporating 40 CFR §270.42 Appendix 1, A.1) and is, therefore, a Class 1 modification.

Discussion

This change is needed to remove an obsolete reference to the retired Surface Rescue Truck in Permit Attachment D, Table D-2, *Emergency Equipment Maintained at the Waste Isolation Pilot Plant*. The Permittees retired the Surface Rescue Truck and replaced it with functionally equivalent equipment in a prior Class 1 PMN, submitted on October 12, 2021.

The required minimum of 12 Fire Department SCBA units is still maintained at the WIPP facility, distributed between the two surface Fire Trucks and the Underground Rescue Cart.

This modification does not reduce the Permittees ability to protect human health and the environment.

Proposed Revised Permit Text:

**Table D-2
Emergency Equipment Maintained at the Waste Isolation Pilot Plant**

Equipment	Description and Capabilities	Location
Fire Detection and Fire Suppression Equipment		
Sprinkler Systems	NFPA water-based fire suppression systems	Water Pumphouse (Building 456), Guard and Security Building (Building 458), Waste Handling Building (Building 411, CH Bay, RH Bay, and Overpack Repair Areas only), TRUPACT Maintenance Building (Building 412), Exhaust Shaft Filter Building (Building 413), NFB (Building 416), SRB (Building 417), and CAAs (Buildings 474A and 474B)
Water Tanks, Hydrants	Fire suppression water supply; one 180,000-gallon capacity tank, plus a second tank with 100,000-gallon reserve	Tanks are at southwestern edge of WIPP facility; pipelines and hydrants are throughout the surface
Fire Water Pumps	Fire suppression water supply; pumps are minimally rated at 125 pounds per square inch, 1,500 gallons per minute centrifugal pump, one with electric motor drive, the other with diesel engine; pressure maintenance jockey pump	Water Pumphouse (Building 456)
Personal Protection Equipment		
Head Lamps	Mounted on hard hat; battery operated	Each person underground
Underground Self-Rescuer Units	Short-term self-rescue devices per 30 CFR 57.15030	Each person underground
Self-Contained Self-Rescuer	Air supply; a minimum of 12 caches in the underground; self-contained rescue units shall be adequate to protect an individual for one hour or longer or, alternatively, sufficient to allow the employee time to reach an additional self-contained self-rescue device in the underground per NMSA 69-8-16	Cached throughout the underground
Mine Rescue Self-Contained Breathing Apparatus (SCBA)	Oxygen supply; 4-hour closed circuit units consistent with 30 CFR 49.6; a minimum of 12 units, one for each Mine Rescue Team member	Safety and Emergency Services Facility (Building 452, Mine Rescue Training Room)
Fire Department Self-Contained Breathing Apparatus (SCBA)	Air supply; a minimum of 12 units; SCBAs shall meet the minimum requirements established per NFPA 1981	Surface Fire Trucks and Rescue Truck; Underground Rescue Cart

Equipment	Description and Capabilities	Location
General Plant Emergency Equipment		
Emergency Lighting	For employee evacuation, and fire/spill containment; linked to main power supply, and selectively linked to back up diesel power supply and/or battery-backed power supply	Waste Handling Building (Building 411); TRUPACT Maintenance Building (Building 412), Exhaust Shaft Filter Building (Building 413) NFB (Building 416), and SRB (Building 417)

Item 2

Description

This modification revises Figures in Permit Attachment A4 and Attachment D to reflect the following changes:

- Relocate the northeast Property Protection Area (**PPA**) fence line approximately 12 ft to the north to include the new fire water line
- Remove temporary PPA fence line around the Air Intake Shaft (**AIS**)
- Remove Building 971 (Human Resources Trailer)
- Add Building 270 (Access Control Point Shelter)

The following Permit figures are being modified to relocate the northeast PPA fence line approximately 12 ft to the north, remove Building 971 (Human Resources Trailer) and add Building 270 (Access Control Point Shelter).

- Attachment A4, Figure A4-2, *WIPP Traffic Flow Diagram*
- Attachment A4, Figure A4-2-NFB, *WIPP Traffic Flow Diagram with Building 416*
- Attachment D, Figure D-1, *WIPP Surface Structures*
- Attachment D, Figure D-1-NFB, *WIPP Surface Structures with Building 416*
- Attachment D, Figure D-5, *Fire-Water Distribution System*
- Attachment D, Figure D-5-NFB, *Fire-Water Distribution with Building 416*
- Attachment D, Figure D-6, *WIPP On-Site Assembly Areas and Off-Site Staging Areas*
- Attachment D, Figure D-6-NFB, *WIPP On-Site Assembly Areas and Off-Site Staging Areas with Building 416*

The following Permit figures are being modified to remove the reference to Building 971 (Human Resources Trailer) and add the reference to Building 270 (Access Control Point Shelter).

- Attachment D, Figure D-1a, *Legend to Figure D-1*
- Attachment D, Figure D-1a-NFB, *Legend to Figure D-1-NFB (Building 416)*

The following Permit figures are being modified to remove the temporary PPA fence line around the AIS.

- Attachment A4, Figure A4-2, *WIPP Traffic Flow Diagram*
- Attachment D, Figure D-1, *WIPP Surface Structures*
- Attachment D, Figure D-5, *Fire-Water Distribution System*
- Attachment D, Figure D-6, *WIPP On-Site Assembly Areas and Off-Site Staging Areas*

Basis

This change is classified as an "Administrative and informational change" pursuant to 20.4.1.900 NMAC (incorporating 40 CFR §270.42 Appendix 1, A.1) and is, therefore, a Class 1 modification.

Discussion

The PPA fence in the northeast portion of the facility east of the North Gate has been relocated approximately 12 feet north of its original location. The PPA fence has been relocated to encompass part of the new fire water distribution system and its components. This modification is needed to update figures that depict the WIPP facility PPA boundary. The change in the PPA area footprint is small (approximately < 0.25 acres) and does not require a revision to the WIPP facility acreage identified in Permit Attachment A, Section A-3, *Property Description*.

In a prior Class 1 PMN submitted May 19, 2021, the Permittees included a change adding a temporary PPA fence line to figures in Permit Attachment A4 and Permit Attachment D. This change was made to accommodate construction activities around the AIS in the northwest portion of the WIPP facility. The AIS construction project was completed and the PPA fence is being returned to its original configuration.

This modification is also needed to update Permit figures depicting the WIPP facility's surface buildings. The Human Resources Trailer (Building 971) has been removed from the facility therefore it is being removed from figures listed above. The Human Resources Trailer (Building 971) was removed since it was past its operational lifespan and the personnel in this location were relocated to Building 451. The Access Control Point Shelter (Building 270) located at the main entrance of the facility is being added to the figures listed above. The Access Control Point Shelter (Building 270) was added to provide protection from the weather to security personnel during vehicle inspections at the main gate.

These changes are needed to update the Permit with current information.

For clarity, red boxes are provided on the versions of the figures being replaced to depict the exact areas where changes are being made.

Proposed Revised Permit Text:

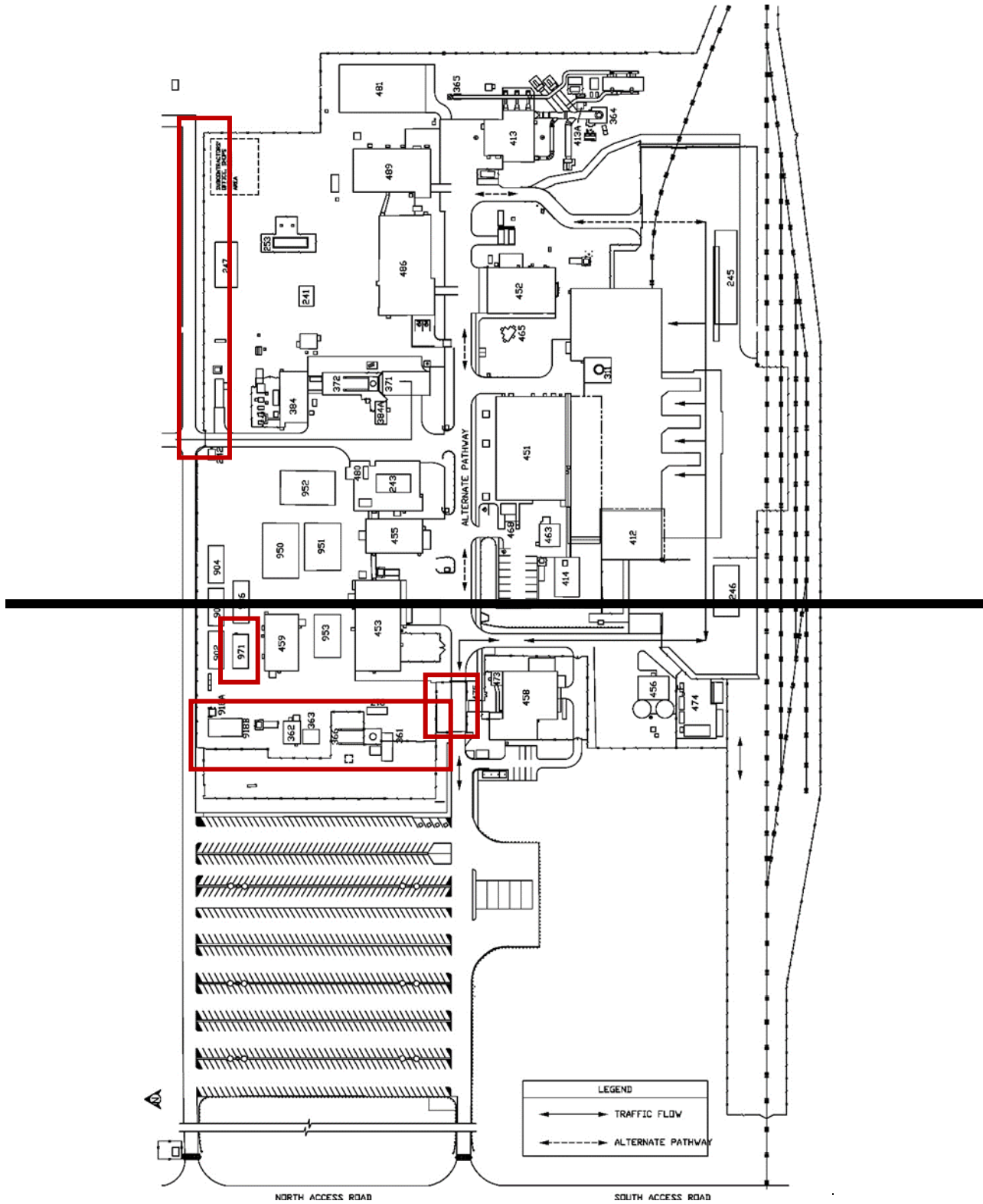

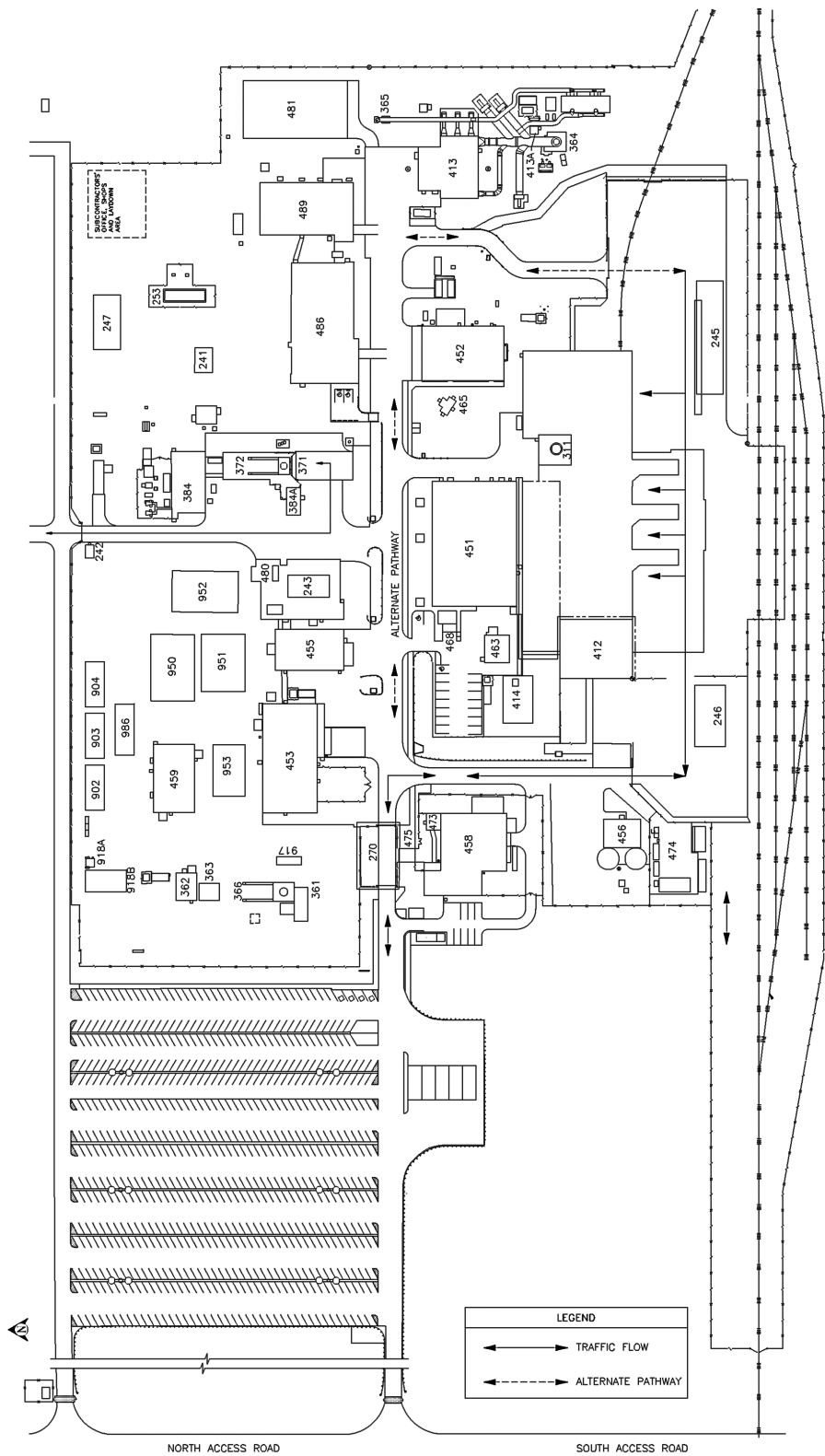
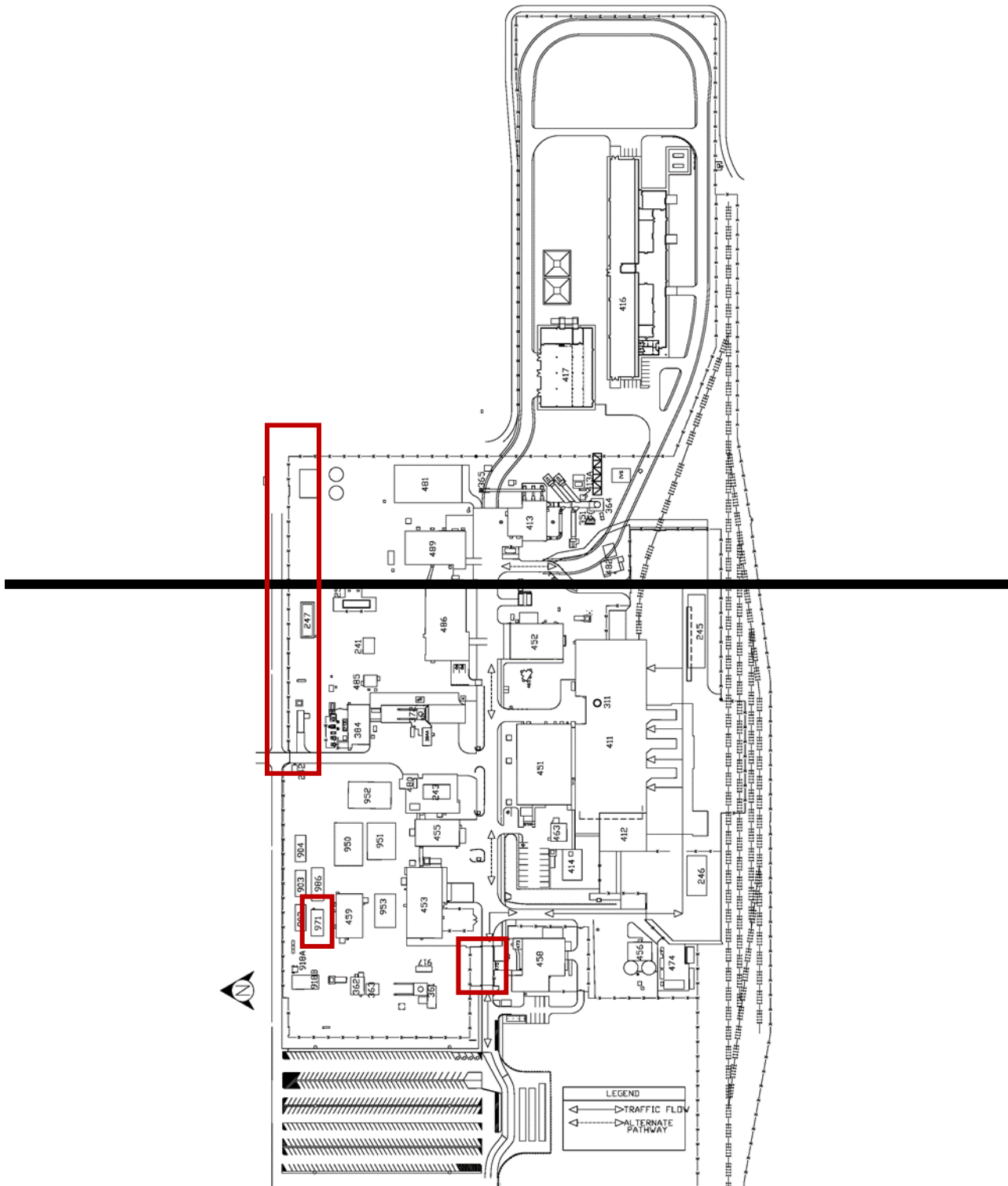

Figure A4-2
WIPP Traffic Flow Diagram



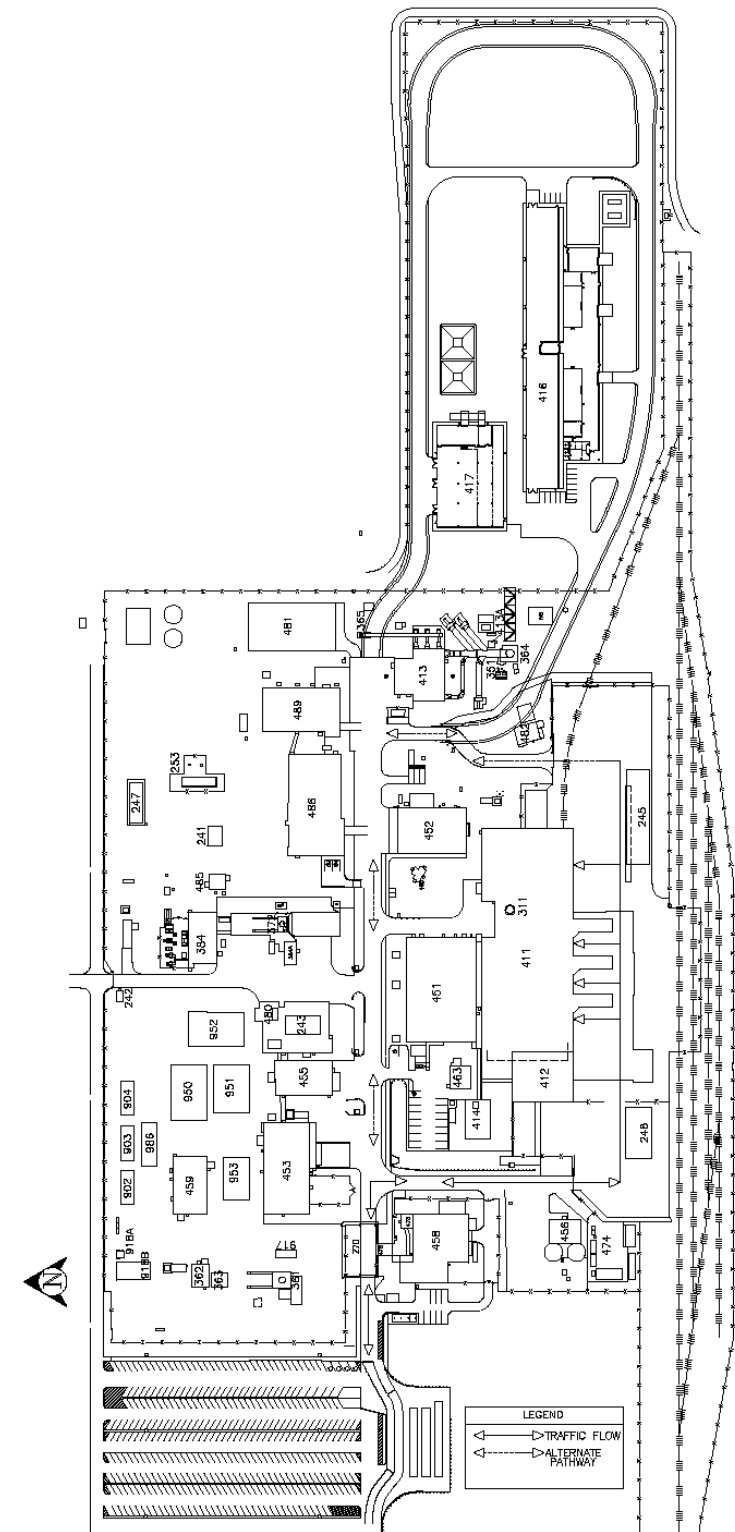
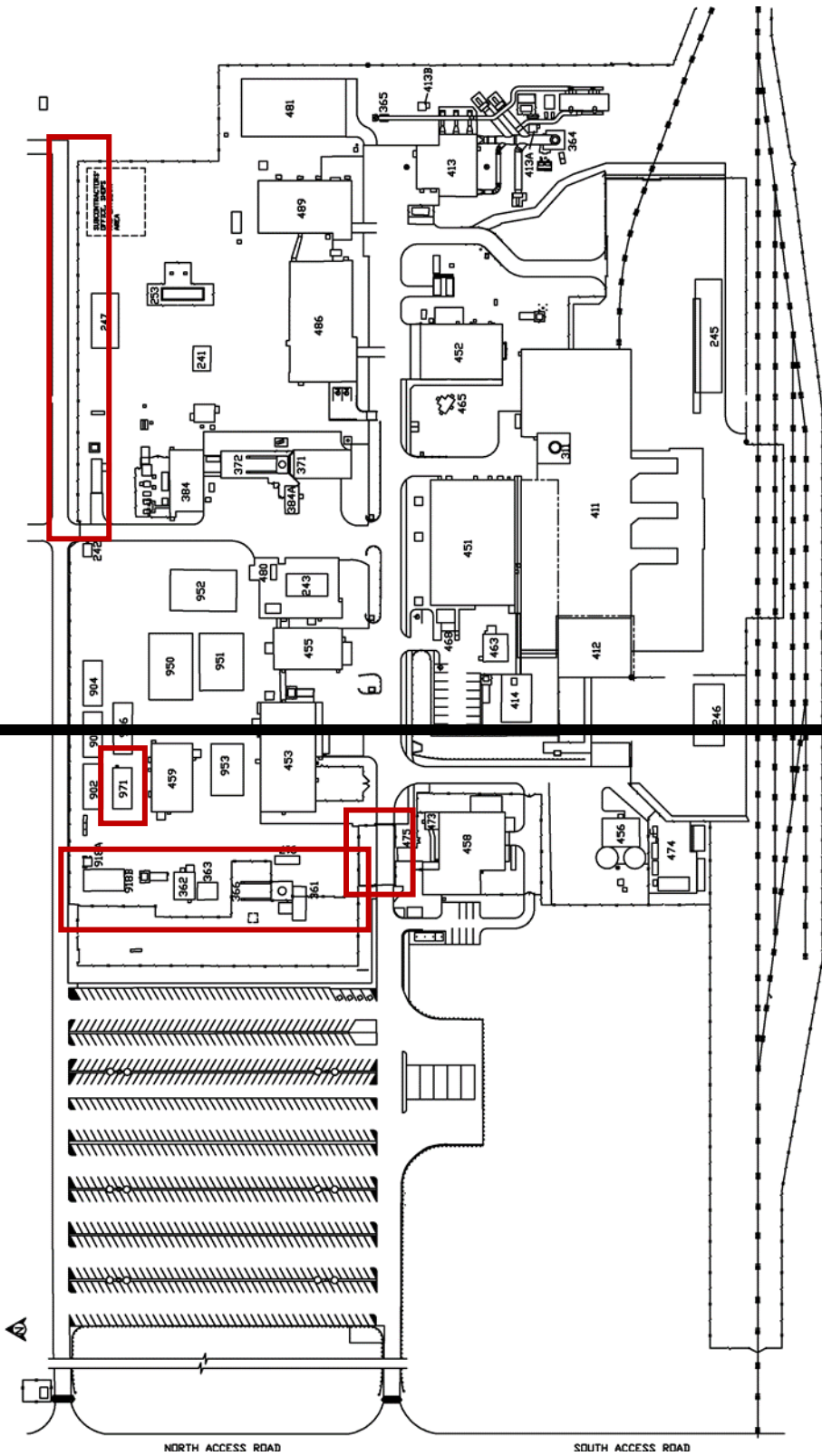

Figure A4-2-NFB
WIPP Traffic Flow Diagram with Building 416



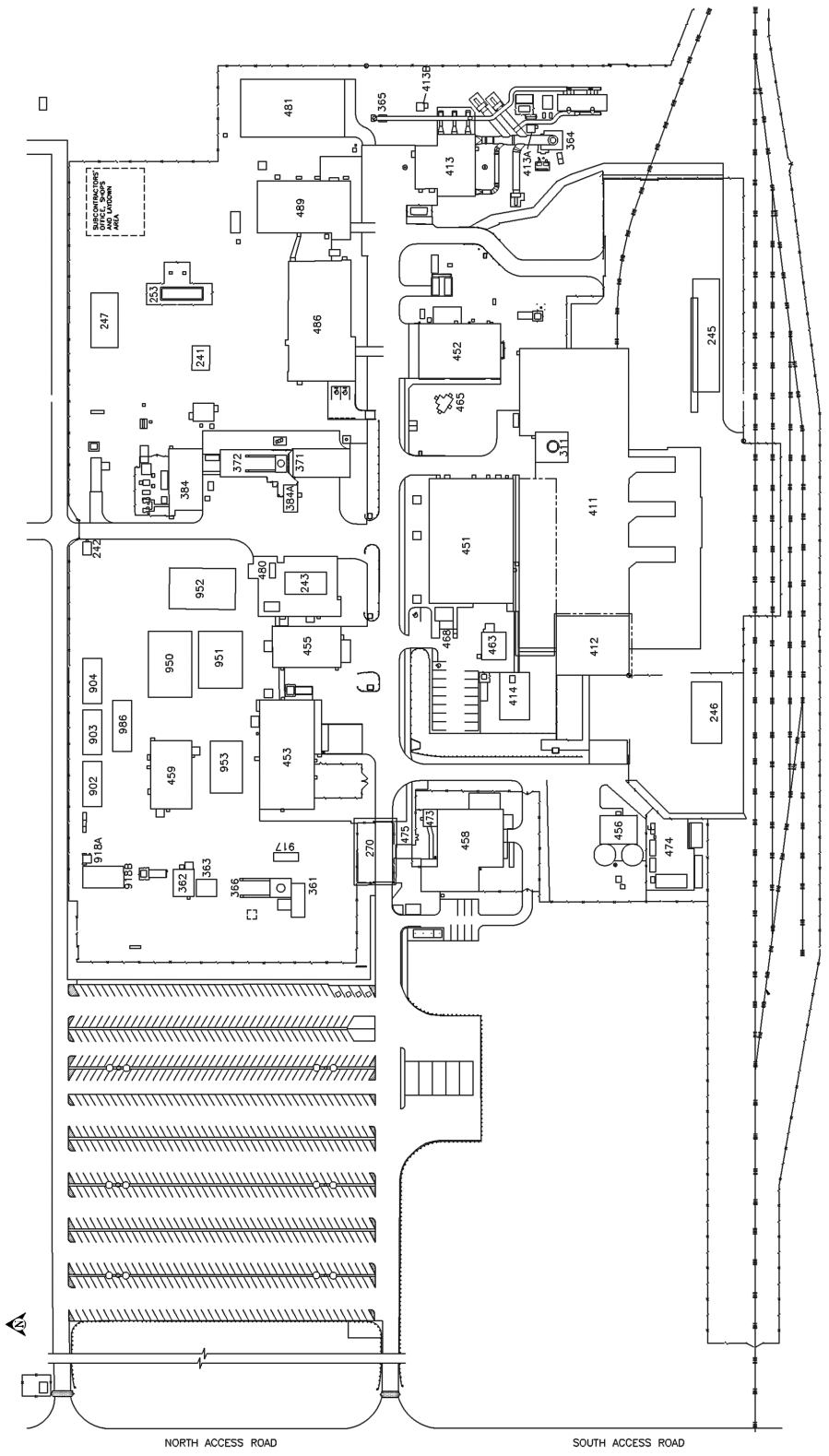
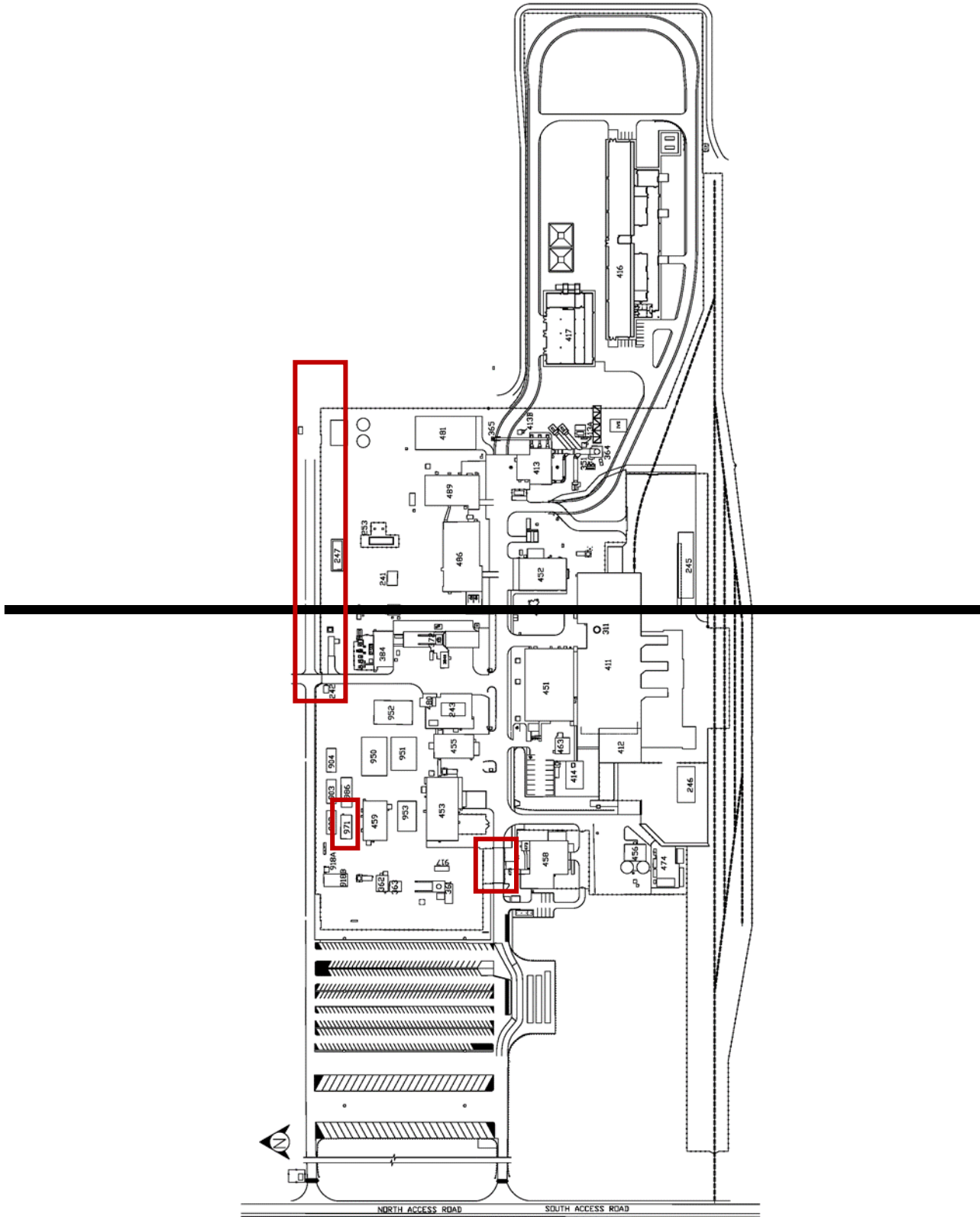

Figure D-1
WIPP Surface Structures

BLDG./ FAC. #	DESCRIPTION	BLDG./ FAC. #	DESCRIPTION	BLDG./ FAC. #	DESCRIPTION
#241	EQUIPMENT SHED	#384	SALT HANDLING SHAFT HOISTHOUSE	#475	GATEHOUSE
#242	GUARDSHACK	#384A	MINING OPERATIONS	#480	VEHICLE FUEL STATION
#243	SALT HAULING TRUCKS SHELTER	#411	WASTE HANDLING BUILDING	#481	WAREHOUSE ANNEX
#245	TRUPACT TRAILER SHELTER	#412	TRUPACT MAINTENANCE BUILDING	#486	ENGINEERING BUILDING
#246	MgO STORAGE SHELTER	#413	EXHAUST SHAFT FILTER BUILDING	#489	TRAINING BUILDING
#253	13.8 KV SWITCHGEAR 25P-SWG15/1	#413A	MONITORING STATION A	#H-16	SANDIA TEST WELL
#254.1	AREA SUBSTATION NO.1 25P-SW15. 1	#413B	MONITORING STATION B	#917	AIS MONITORING
#254.2	AREA SUBSTATION NO.2 25P-SW15.2	#414	WATER CHILLER FACILITY & BLDG	#918A	VOC AIR MONITORING STATION
#254.3	AREA SUBSTATION NO.3 25P-SW15.3	#451	SUPPORT BUILDING	#918B	VOC LAB TRAILER
#254.4	AREA SUBSTATION NO.4 25P-SW15.4	#452	SAFETY & EMERGENCY SERVICES FACILITY	#950	WORK CONTROL TRAILER
#254.5	AREA SUBSTATION NO.5 25P-SW15.5	#453	WAREHOUSE/SHOPS BUILDING	#951	PROCUREMENT/PURCHASING
#254.6	AREA SUBSTATION NO.6 25P-SW15.6	#455	AUXILIARY WAREHOUSE BUILDING	#952	TRAILER
#254.7	AREA SUBSTATION NO.7 25P-SW15.7	#456	WATER PUMPHOUSE	#953	MODULAR OFFICE COMPLEX
#254.8	AREA SUBSTATION NO.8 25P-SW15.8	#457N	WATER TANK 25-D-001B	#971	HUMAN RESOURCES TRAILER
#254.9	480V SWITCHGEAR (25P-SWG04/9)	#457S	WATER TANK 25-D-001A	#986	PUBLICATIONS & PROCEDURES TRAILER
#255.1	BACK-UP DIESEL GENERATOR #1 25-PE 503	#458	GUARD AND SECURITY BUILDING	SWR NO.6	SWITCHRACK NO. 6
#255.2	BACK-UP DIESEL GENERATOR #2 25-PE 504	#459	CORE STORAGE BUILDING	SWR NO.7,7A,7B	SWITCHRACK NO. 7, 7A, 7B
#256.4	SWITCHBOARD #4 (25P-SB004/4)	#463	COMPRESSOR BUILDING	SWR NO.7C	SWITCHRACK NO. 7C
#311	WASTE SHAFT	#465	AUXILIARY AIR INTAKE	SWR NO.10	SWITCH RACK NO. 10
#351	EXHAUST SHAFT	#468	TELEPHONE HUT	SWR NO.11	SWITCH RACK NO. 11
#361	AIR INTAKE SHAFT	#473	ARMORY BUILDING	SWR NO.12	SWITCH RACK NO. 12
#362	AIR INTAKE SHAFT/HOIST HOUSE	#474	HAZARDOUS WASTE STORAGE FACILITY	SWR NO.15	SWITCH RACK NO. 15
#363	AIR INTAKE SHAFT/WINCH HOUSE	#474A	HAZARDOUS WASTE STORAGE BUILDING		
#364	EFFLUENT MONITORING INSTRUMENT SHED A	#474B	HAZARDOUS WASTE STORAGE BUILDING		
#365	EFFLUENT MONITORING INSTRUMENT SHED B	#474C	OIL & GREASE STORAGE BUILDING		
#366	AIR INTAKE SHAFT HEADFRAME	#474D	GAS BODLE STORAGE BUILDING		
#371	SALT HANDLING SHAFT	#474E	HAZARD MATERIAL STORAGE BUILDING		
#372	SALT HANDLING SHAFT HEADFRAME	#474F	WASTE OIL RETAINER		

BLDG./ FAC. #	DESCRIPTION	BLDG./ FAC. #	DESCRIPTION	BLDG./ FAC. #	DESCRIPTION
#241	EQUIPMENT SHED	#372	SALT HANDLING SHAFT HEADFRAME	#474F	WASTE OIL RETAINER
#242	GUARDSHACK	#384	SALT HANDLING SHAFT HOISTHOUSE	#475	GATEHOUSE
#243	SALT HAULING TRUCKS SHELTER	#384A	MINING OPERATIONS	#480	VEHICLE FUEL STATION
#245	TRUPACT TRAILER SHELTER	#411	WASTE HANDLING BUILDING	#481	WAREHOUSE ANNEX
#246	MgO STORAGE SHELTER	#412	TRUPACT MAINTENANCE BUILDING	#486	ENGINEERING BUILDING
#253	13.8 KV SWITCHGEAR 25P-SWG15/1	#413	EXHAUST SHAFT FILTER BUILDING	#489	TRAINING BUILDING
#254.1	AREA SUBSTATION NO.1 25P-SW15. 1	#413A	MONITORING STATION A	#H-16	SANDIA TEST WELL
#254.2	AREA SUBSTATION NO.2 25P-SW15.2	#413B	MONITORING STATION B	#917	AIS MONITORING
#254.3	AREA SUBSTATION NO.3 25P-SW15.3	#414	WATER CHILLER FACILITY & BLDG	#918A	VOC AIR MONITORING STATION
#254.4	AREA SUBSTATION NO.4 25P-SW15.4	#451	SUPPORT BUILDING	#918B	VOC LAB TRAILER
#254.5	AREA SUBSTATION NO.5 25P-SW15.5	#452	SAFETY & EMERGENCY SERVICES FACILITY	#950	WORK CONTROL TRAILER
#254.6	AREA SUBSTATION NO.6 25P-SW15.6	#453	WAREHOUSE/SHOPS BUILDING	#951	PROCUREMENT/PURCHASING
#254.7	AREA SUBSTATION NO.7 25P-SW15.7	#455	AUXILLIARY WAREHOUSE BUILDING	#952	TRAILER
#254.8	AREA SUBSTATION NO.8 25P-SW15.8	#456	WATER PUMPHOUSE	#953	MODULAR OFFICE COMPLEX
#254.9	480V SWITCHGEAR (25P-SWG04/9)	#457N	WATER TANK 25-D-001B	#986	PUBLICATIONS & PROCEDURES
#255.1	BACK-UP DIESEL GENERATOR #1 25-PE 503	#457S	WATER TANK 25-D-001A	SWR NO.6	TRAILER SWITCHRACK NO. 6
#255.2	BACK-UP DIESEL GENERATOR #2 25-PE 504	#458	GUARD AND SECURITY BUILDING	SWR NO.7,7A,7B	SWITCHRACK NO. 7, 7A, 7B
#256.4	SWITCHBOARD #4 (25P-SBD04/4)	#459	CORE STORAGE BUILDING	SWR NO.7C	SWITCHRACK NO. 7C
#270	ACCESS CONTROL POINT SHELTER	#463	COMPRESSOR BUILDING	SWR NO.10	SWITCH RACK NO. 10
#311	WASTE SHAFT	#465	AUXILIARY AIR INTAKE	SWR NO.11	SWITCH RACK NO. 11
#351	EXHAUST SHAFT	#468	TELEPHONE HUT	SWR NO.12	SWITCH RACK NO. 12
#361	AIR INTAKE SHAFT	#473	ARMORY BUILDING	SWR NO.15	SWITCH RACK NO. 15
#362	AIR INTAKE SHAFT/HOIST HOUSE	#474	HAZARDOUS WASTE STORAGE FACILITY		
#363	AIR INTAKE SHAFT/WINCH HOUSE	#474A	HAZARDOUS WASTE STORAGE BUILDING		
#364	EFFLUENT MONITORING INSTRUMENT SHED A	#474B	HAZARDOUS WASTE STORAGE BUILDING		
#365	EFFLUENT MONITORING INSTRUMENT SHED B	#474C	OIL & GREASE STORAGE BUILDING		
#366	AIR INTAKE SHAFT HEADFRAME	#474D	GAS BODLE STORAGE BUILDING		
#371	SALT HANDLING SHAFT	#474E	HAZARD MATERIAL STORAGE BUILDING		

Figure D-1a
Legend to Figure D-1



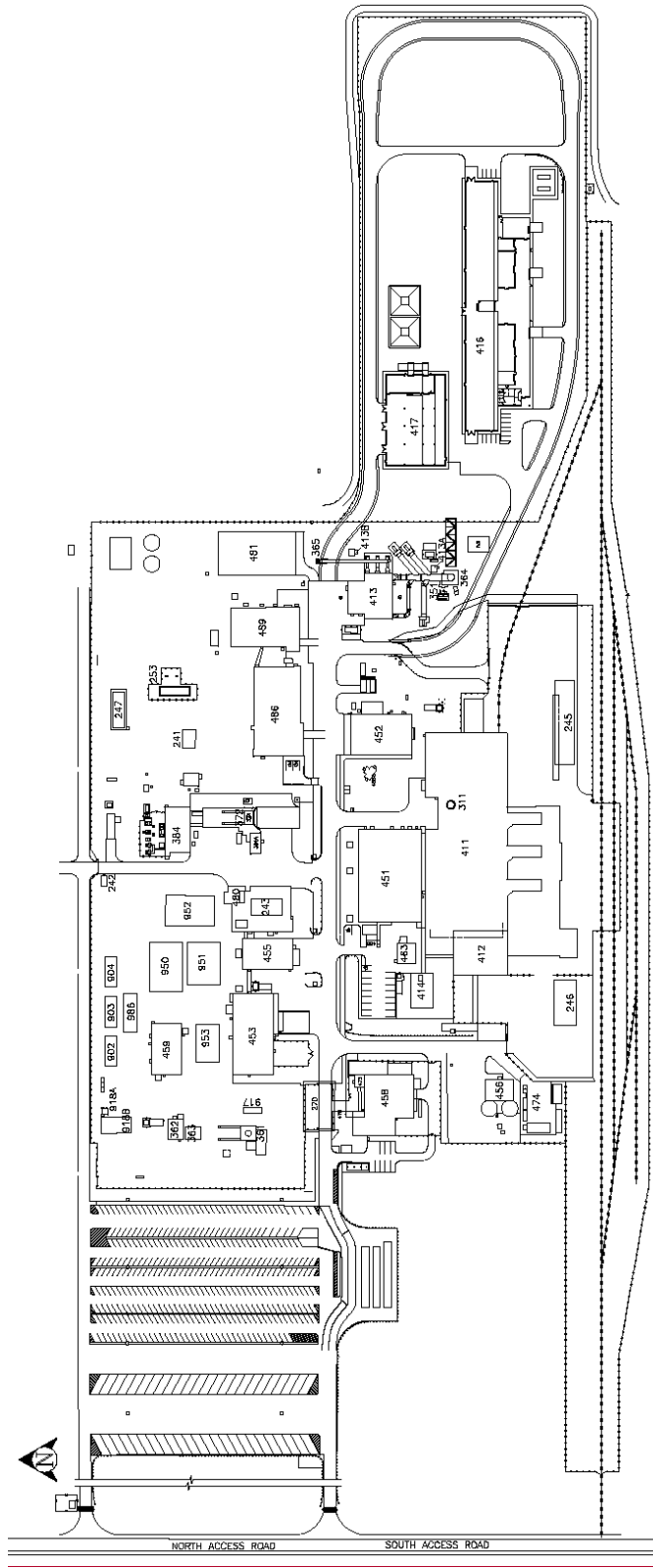
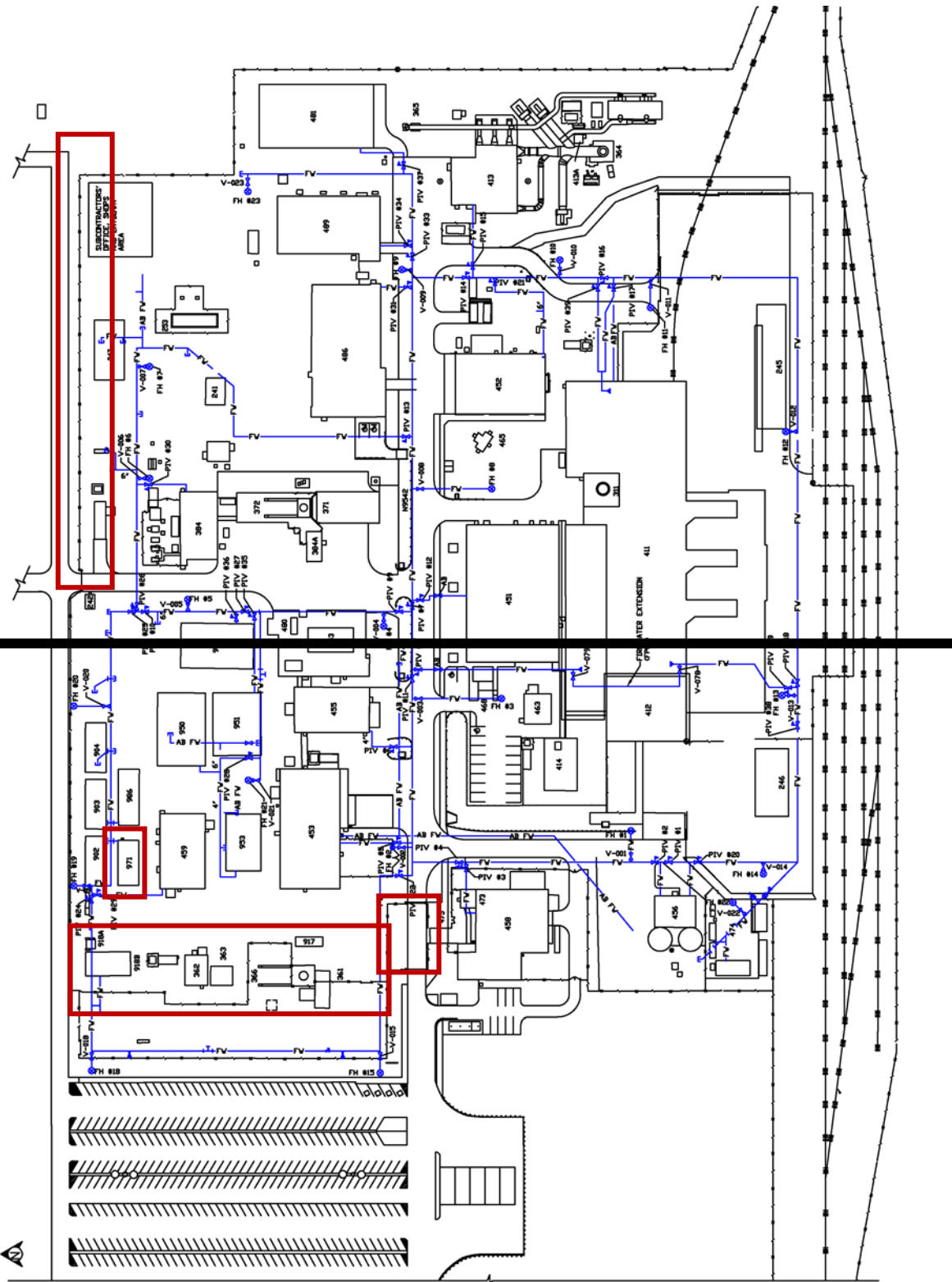

Figure D-1-NFB
WIPP Surface Structures with Building 416

BLDG./ FAC. #	DESCRIPTION	BLDG./ FAC. #	DESCRIPTION	BLDG./ FAC. #	DESCRIPTION
#241	EQUIPMENT SHED	#384A	MINING OPERATIONS	#475	GATEHOUSE
#242	GUARDSHACK	#411	WASTE HANDLING BUILDING	#480	VEHICLE FUEL STATION
#243	SALT HAULING TRUCKS SHELTER	#412	TRUPACT MAINTENANCE BUILDING	#481	WAREHOUSE ANNEX
#245	TRUPACT TRAILER SHELTER	#413	EXHAUST SHAFT FILTER BUILDING	#486	ENGINEERING BUILDING
#246	MgO STORAGE SHELTER	#413A	MONITORING STATION A	#489	TRAINING BUILDING
#253	13.8 KV SWITCHGEAR 25P-SWG15/1	#413B	MONITORING STATION B	#H-16	SANDIA TEST WELL
#254.1	AREA SUBSTATION NO.1 25P-SW15. 1	#414	WATER CHILLER FACILITY & BLDG	#902	TRAILER
#254.2	AREA SUBSTATION NO.2 25P-SW15.2	#416	NEW FILTER BUILDING	#903	TRAILER
#254.3	AREA SUBSTATION NO.3 25P-SW15.3	#417	SALT REDUCTION BUILDING	#904	TRAILER
#254.4	AREA SUBSTATION NO.4 25P-SW15.4	#451	SUPPORT BUILDING	#917	AIS MONITORING
#254.5	AREA SUBSTATION NO.5 25P-SW15.5	#452	SAFETY & EMERGENCY SERVICES FACILITY	#918A	VOC AIR MONITORING STATION
#254.6	AREA SUBSTATION NO.6 25P-SW15.6	#453	WAREHOUSE/SHOPS BUILDING	#918B	VOC LAB TRAILER
#254.7	AREA SUBSTATION NO.7 25P-SW15.7	#455	AUXILIARY WAREHOUSE BUILDING	#950	WORK CONTROL TRAILER
#254.9	480V SWITCHGEAR (25P-SWG04/9)	#457N	WATER TANK 25-D-001B	#952	TRAILER
#255.1	BACK-UP DIESEL GENERATOR #1 25-PE 503	#457S	WATER TANK 25-D-001A	#953	MODULAR OFFICE COMPLEX
#255.2	BACK-UP DIESEL GENERATOR #2 25-PE 504	#458	GUARD AND SECURITY BUILDING	#971	HUMAN RESOURCES TRAILER
#256.4	SWITCHBOARD #4 (25P-SBD04/4)	#459	CORE STORAGE BUILDING	#986	PUBLICATIONS & PROCEDURES TRAILER
#311	WASTE SHAFT	#463	COMPRESSOR BUILDING	SWR NO.6	SWITCHRACK NO. 6
#351	EXHAUST SHAFT	#465	AUXILIARY AIR INTAKE	SWR NO.7,7A,7B	SWITCHRACK NO. 7, 7A, 7B
#361	AIR INTAKE SHAFT	#468	TELEPHONE HUT	SWR NO.7C	SWITCHRACK NO. 7C
#362	AIR INTAKE SHAFT/HOIST HOUSE	#473	ARMORY BUILDING	SWR NO.10	SWITCH RACK NO. 10
#363	AIR INTAKE SHAFT/WINCH HOUSE	#474	HAZARDOUS WASTE STORAGE FACILITY	SWR NO.11	SWITCH RACK NO. 11
#364	EFFLUENT MONITORING INSTRUMENT SHED A	#474A	HAZARDOUS WASTE STORAGE BUILDING	SWR NO.12	SWITCH RACK NO. 12
#365	EFFLUENT MONITORING INSTRUMENT SHED B	#474B	HAZARDOUS WASTE STORAGE BUILDING	SWR NO.15	SWITCH RACK NO. 15
#366	AIR INTAKE SHAFT HEADFRAME	#474C	OIL & GREASE STORAGE BUILDING		
#371	SALT HANDLING SHAFT	#474D	GAS BODLE STORAGE BUILDING		
#372	SALT HANDLING SHAFT HEADFRAME	#474E	HAZARD MATERIAL STORAGE BUILDING		
#384	SALT HANDLING SHAFT HOISTHOUSE	#474F	WASTE OIL RETAINER		

BLDG./ FAC. #	DESCRIPTION	BLDG./ FAC. #	DESCRIPTION	BLDG./ FAC. #	DESCRIPTION
#241	EQUIPMENT SHED	#384	SALT HANDLING SHAFT HOISTHOUSE	#474F	WASTE OIL RETAINER
#242	GUARDSHACK	#384A	MINING OPERATIONS	#475	GATEHOUSE
#243	SALT HAULING TRUCKS SHELTER	#411	WASTE HANDLING BUILDING	#480	VEHICLE FUEL STATION
#245	TRUPACT TRAILER SHELTER	#412	TRUPACT MAINTENANCE BUILDING	#481	WAREHOUSE ANNEX
#246	MgO STORAGE SHELTER	#413	EXHAUST SHAFT FILTER BUILDING	#486	ENGINEERING BUILDING
#253	13.8 KV SWITCHGEAR 25P-SWG15/1	#413A	MONITORING STATION A	#489	TRAINING BUILDING
#254.1	AREA SUBSTATION NO.1 25P-SW15. 1	#413B	MONITORING STATION B	#H-16	SANDIA TEST WELL
#254.2	AREA SUBSTATION NO.2 25P-SW15.2	#414	WATER CHILLER FACILITY & BLDG	#902	TRAILER
#254.3	AREA SUBSTATION NO.3 25P-SW15.3	#416	NEW FILTER BUILDING	#903	TRAILER
#254.4	AREA SUBSTATION NO.4 25P-SW15.4	#417	SALT REDUCTION BUILDING	#904	TRAILER
#254.5	AREA SUBSTATION NO.5 25P-SW15.5	#451	SUPPORT BUILDING	#917	AIS MONITORING
#254.6	AREA SUBSTATION NO.6 25P-SW15.6	#452	SAFETY & EMERGENCY SERVICES FACILITY	#918A	VOC AIR MONITORING STATION
#254.7	AREA SUBSTATION NO.7 25P-SW15.7	#453	WAREHOUSE/SHOPS BUILDING	#918B	VOC LAB TRAILER
#254.8	AREA SUBSTATION NO.8 25P-SW15.8	#455	AUXILIARY WAREHOUSE BUILDING	#950	WORK CONTROL TRAILER
#254.9	480V SWITCHGEAR (25P-SWG04/9)	#456	WATER PUMPHOUSE	#951	PROCUREMENT/PURCHASING
#255.1	BACK-UP DIESEL GENERATOR #1 25-PE 503	#457N	WATER TANK 25-D-001B	#952	TRAILER
#255.2	BACK-UP DIESEL GENERATOR #2 25-PE 504	#457S	WATER TANK 25-D-001A	#953	MODULAR OFFICE COMPLEX
#256.4	SWITCHBOARD #4 (25P-SBD04/4)	#458	GUARD AND SECURITY BUILDING	#986	PUBLICATIONS & PROCEDURES
#270	ACCESS CONTROL POINT SHELTER	#459	CORE STORAGE BUILDING	SWR NO.6	TRAILER SWITCHRACK NO. 6
#311	WASTE SHAFT	#463	COMPRESSOR BUILDING	SWR NO. 7,7A,7B	SWITCHRACK NO. 7, 7A, 7B
#351	EXHAUST SHAFT	#465	AUXILIARY AIR INTAKE	SWR NO.7C	SWITCHRACK NO. 7C
#361	AIR INTAKE SHAFT	#468	TELEPHONE HUT	SWR NO.10	SWITCH RACK NO. 10
#362	AIR INTAKE SHAFT/HOIST HOUSE	#473	ARMORY BUILDING	SWR NO.11	SWITCH RACK NO. 11
#363	AIR INTAKE SHAFT/WINCH HOUSE	#474	HAZARDOUS WASTE STORAGE FACILITY	SWR NO.12	SWITCH RACK NO. 12
#364	EFFLUENT MONITORING INSTRUMENT SHED A	#474A	HAZARDOUS WASTE STORAGE BUILDING	SWR NO.15	SWITCH RACK NO. 15
#365	EFFLUENT MONITORING INSTRUMENT SHED B	#474B	HAZARDOUS WASTE STORAGE BUILDING		
#366	AIR INTAKE SHAFT HEADFRAME	#474C	OIL & GREASE STORAGE BUILDING		
#371	SALT HANDLING SHAFT	#474D	GAS BODLE STORAGE BUILDING		
#372	SALT HANDLING SHAFT HEADFRAME	#474E	HAZARD MATERIAL STORAGE BUILDING		

**Figure D-1a-NFB,
Legend to Figure D-1-NFB (Building 416)**



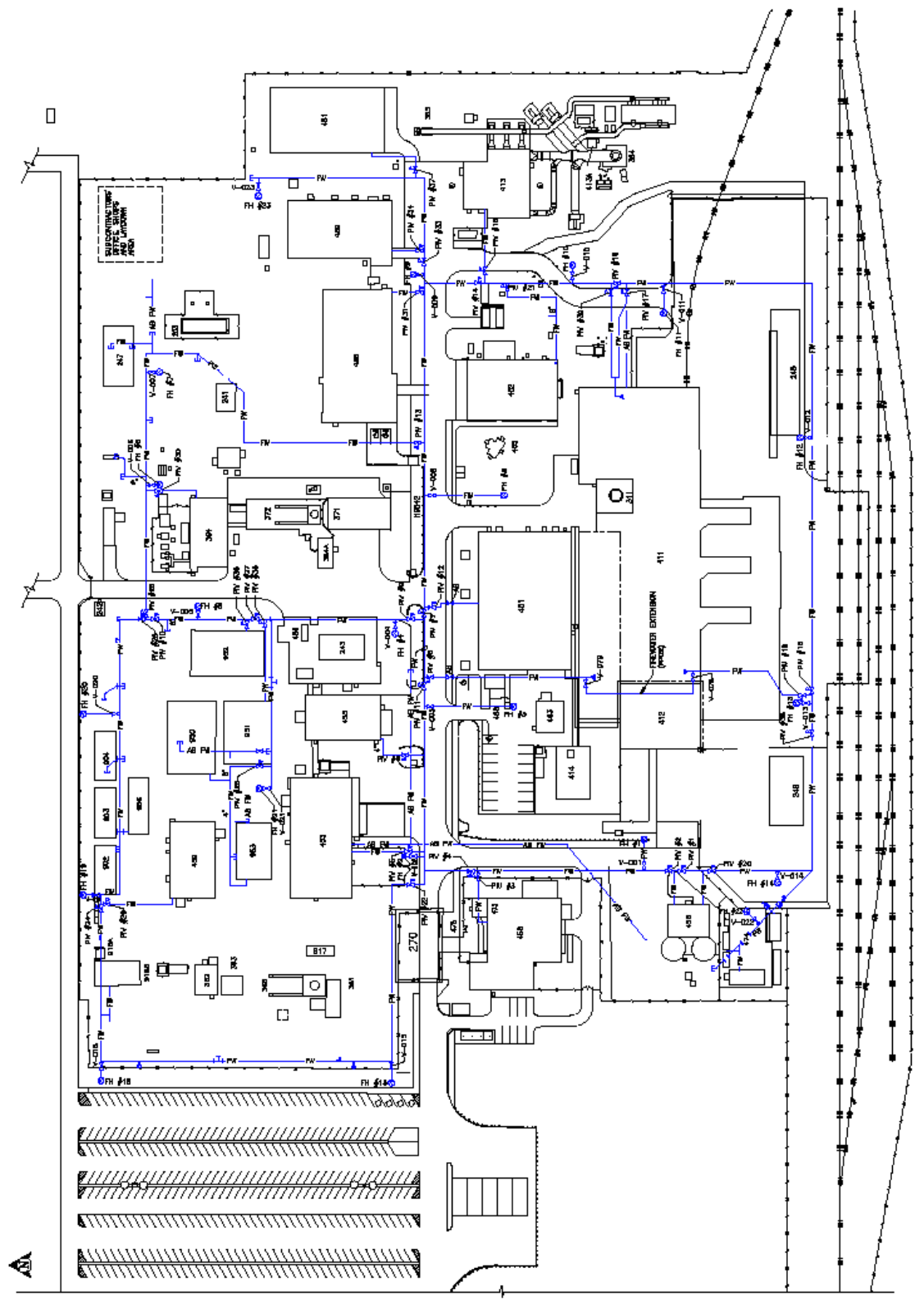
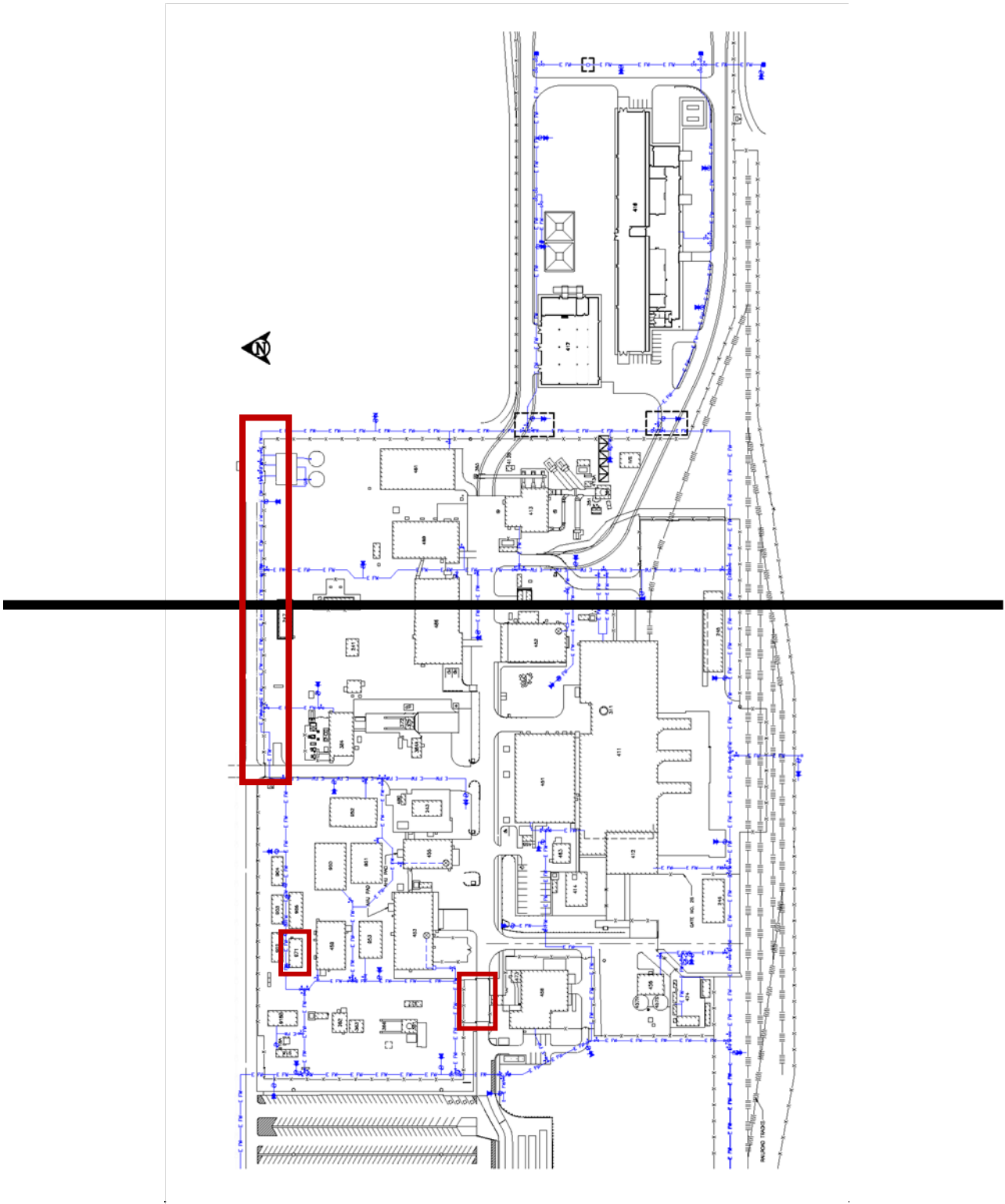

Figure D-5
Fire-Water Distribution System



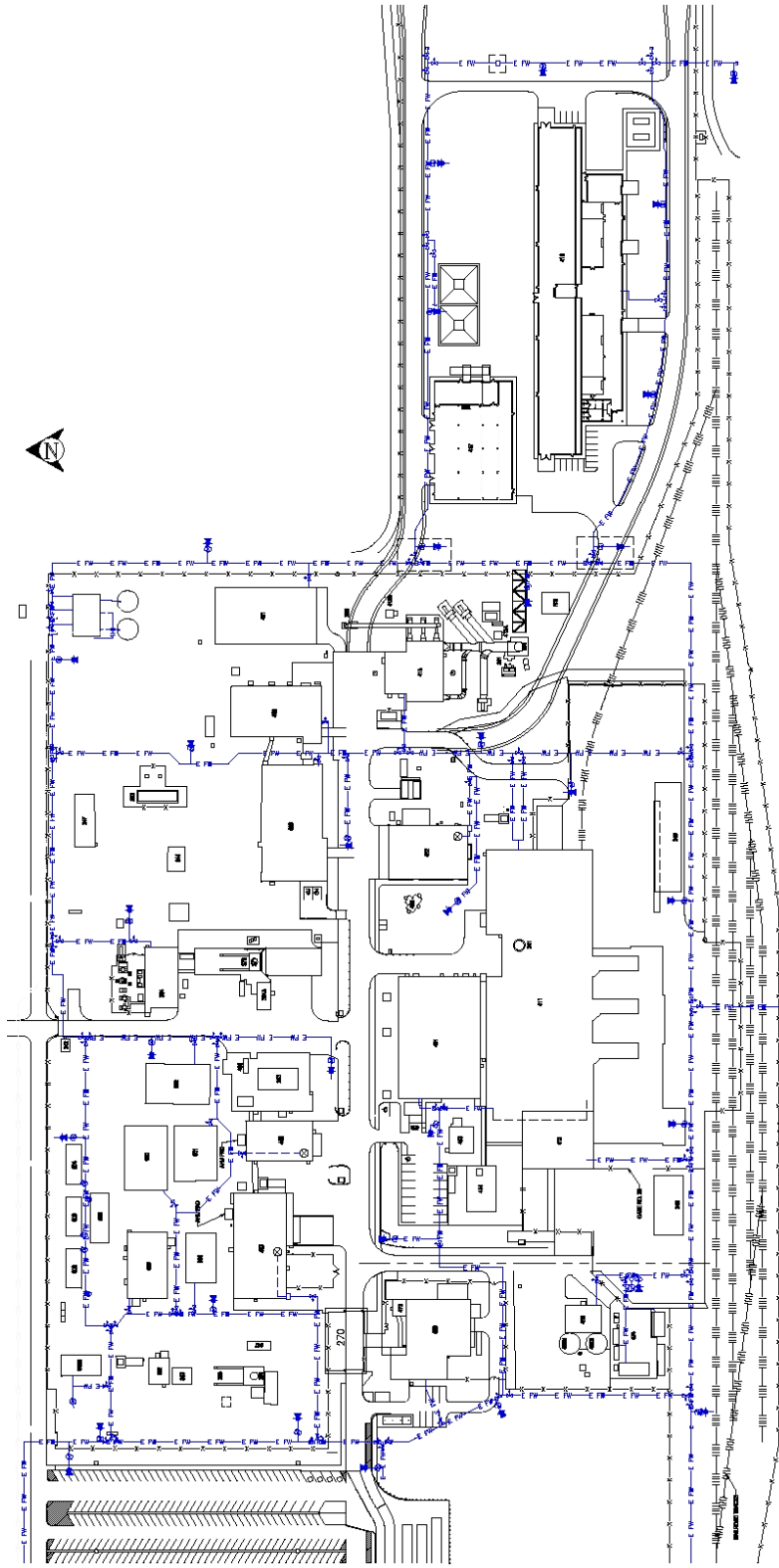
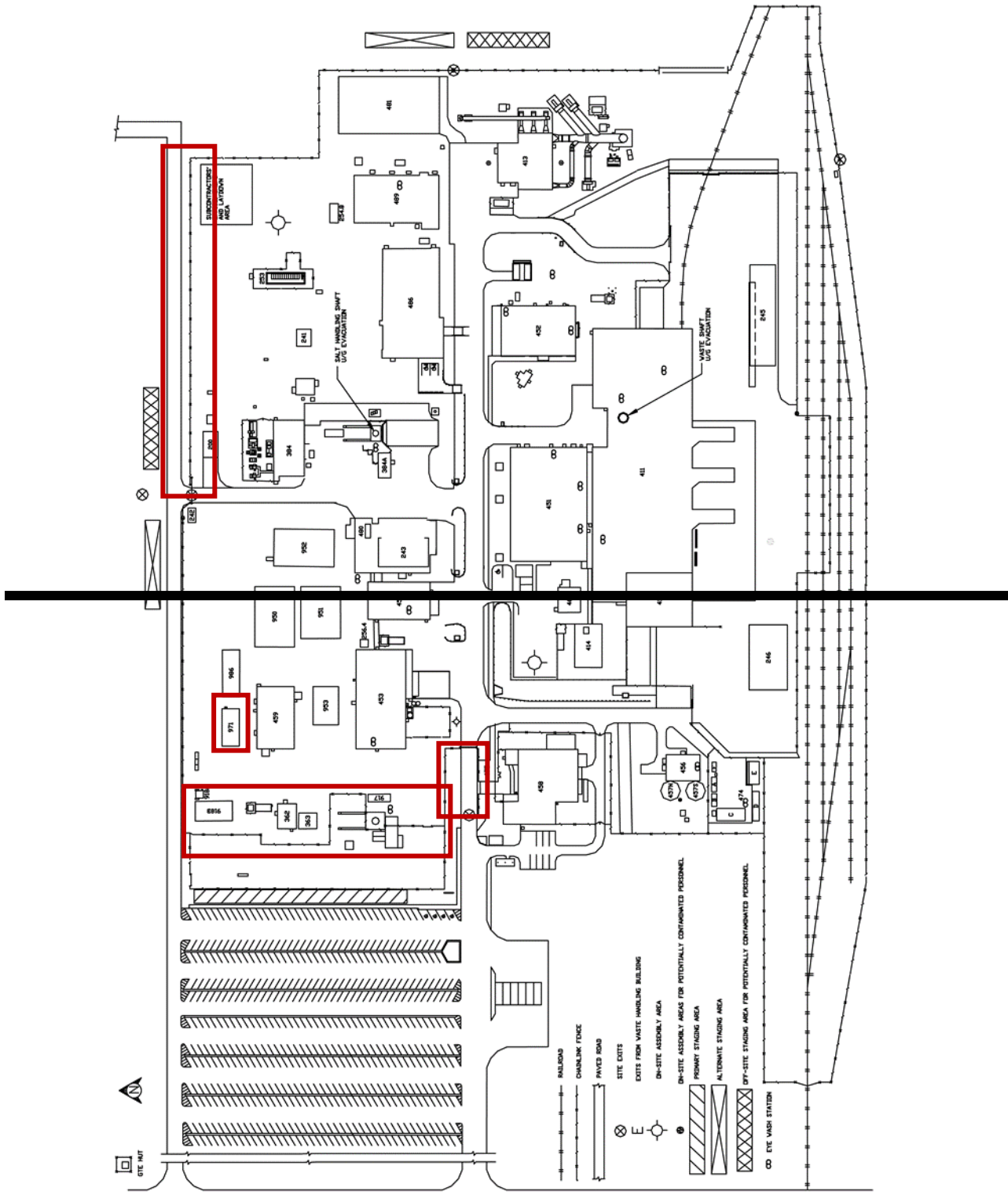

Figure D-5-NFB
Fire-Water Distribution System with Building 416



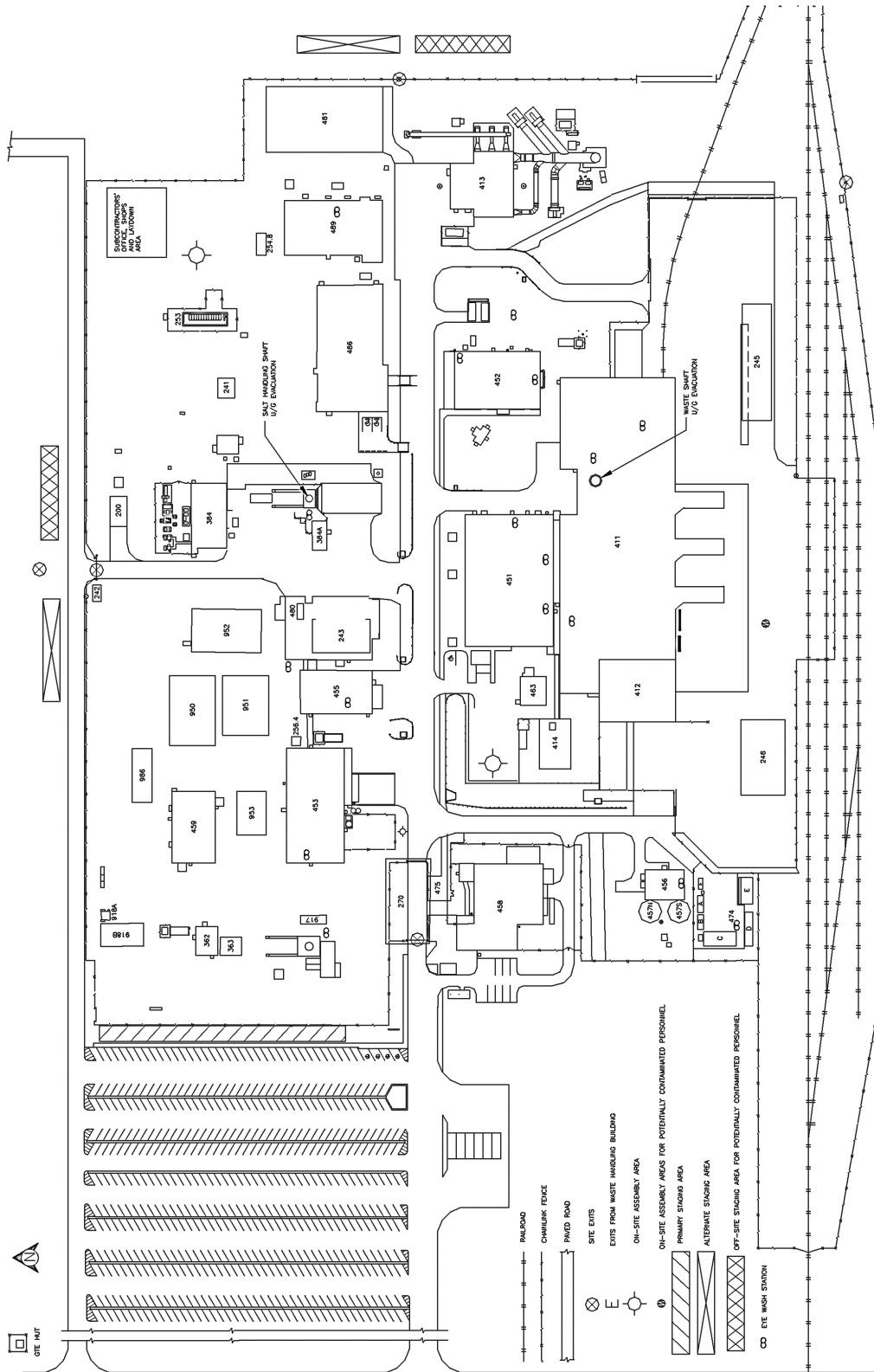
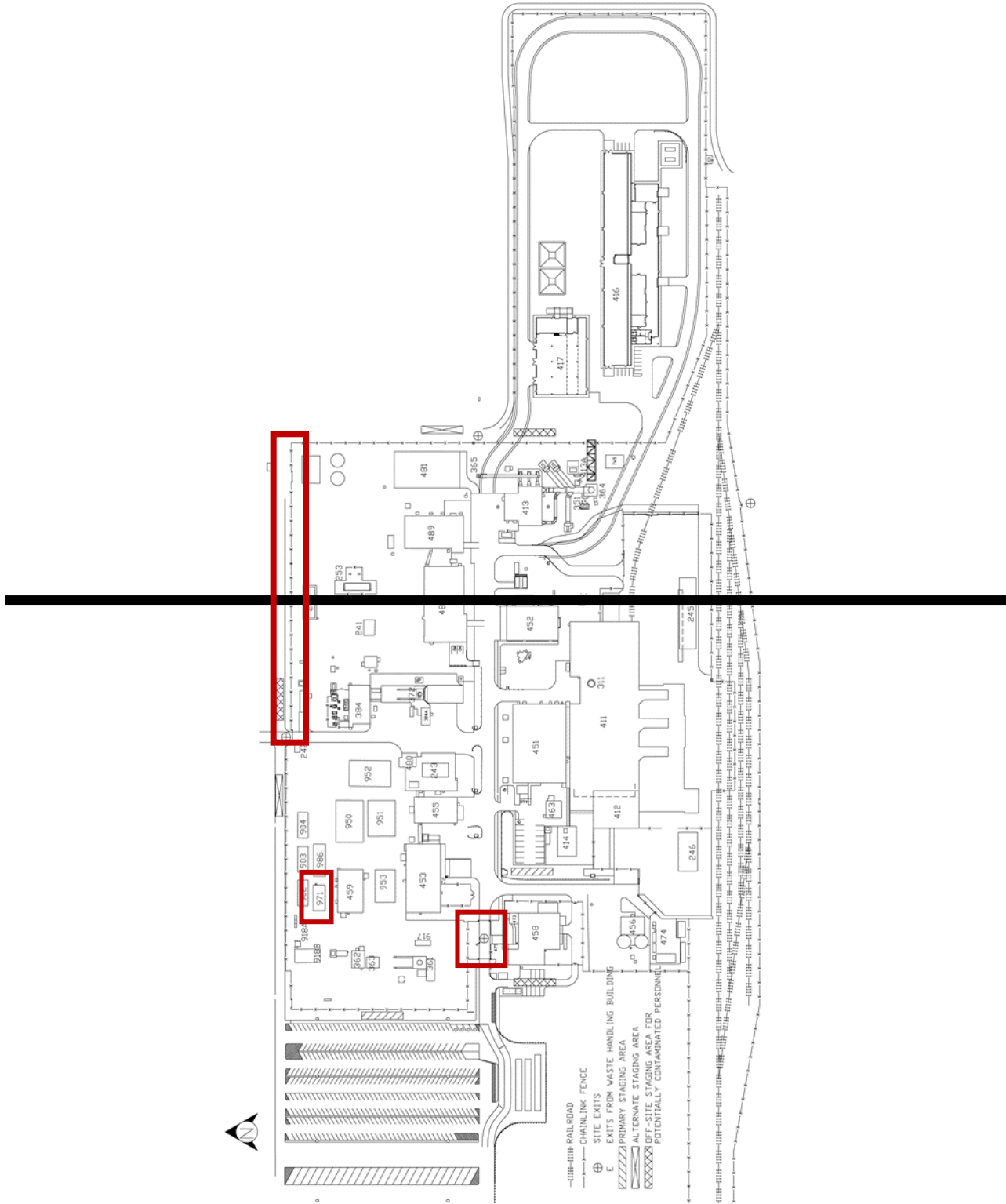

Figure D-6
WIPP On-Site Assembly Areas and Off-Site Staging Areas



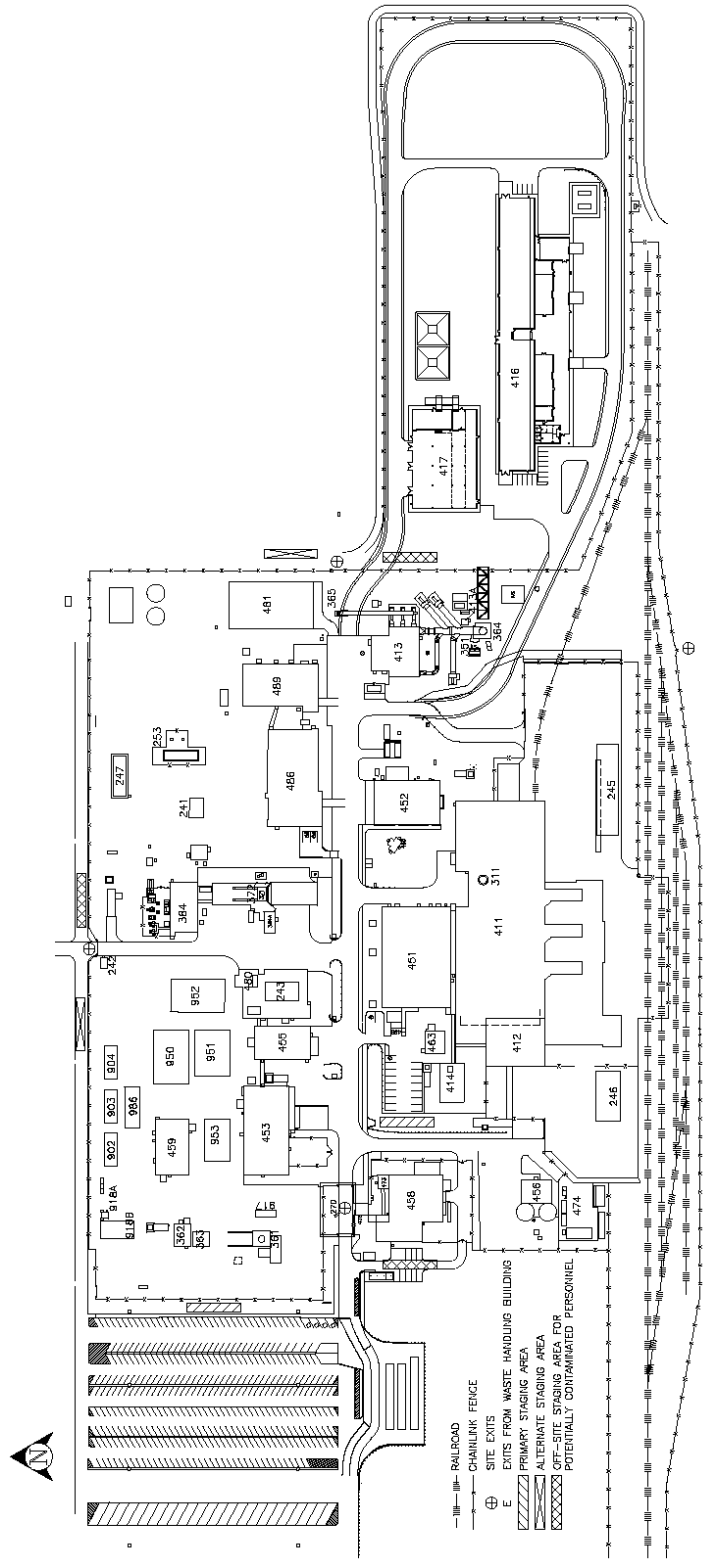

Figure D-6-NFB
WIPP On-Site Assembly Areas and Off-Site Staging Areas with Building 416